

PLANT MATERIAL LIST						
SYMBOL	QUANTITY	BOTANICAL NAME	COMMON NAME	SPECIFICATIONS	NATIVE	SPACING
BB	10	BUCIDA BUCERAS	BLACK OLIVE	12' HT X 5' SPD, 3" CALIPER, RPS	YES	AS SHOWN
MG	7	MAGNOLIA 'DD BLANCHARD'	DD BLANCHARD MAGNOLIA	12' HT X 5' SPD, 3" CALIPER, RPS	YES	AS SHOWN
CI	173	CHRYSOBALANUS ICAGO	RED TIP COCOPLUM	24" HT X 24" SPD, 3 GALLON	YES	36" OC
SA	57	SCHIEFFLERA ARBORICOLA 'TRINETTE'	TRINETTE SCHIEFFLERA	18" HT X 18" SPD, 3 GALLON	NO	30" OC
RI	336	RAPHIOLEPIS INDICA	DWARF INDIAN HAWTHORN	15" HT X 18" SPD, 3 GALLON	NO	30" OC
DV	158	DIETES VEGETA	WHITE AFRICAN IRIS	10" HT X 10" SPD, 1 GALLON	NO	24" OC

PROPOSED TREES

BLACK OLIVE 10
MAGNOLIA 7
TOTAL PROPOSED TREES 17

SYMBOL LEGEND

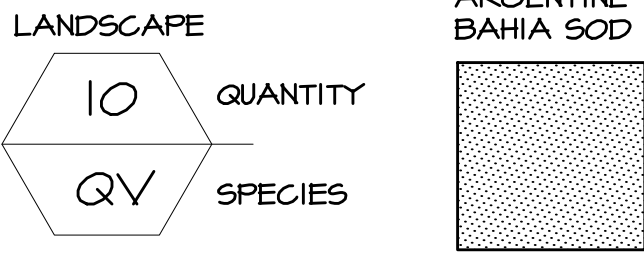

LANDSCAPE REQUIREMENTS

- 1) INTERIOR REQUIREMENTS
6 PARKING SPACES X 10 SF = 60 SF INTERIOR LANDSCAPE
12,433 SF INTERIOR LANDSCAPE AREA / 500 = 26 X 10 = 260 SF INTERIOR LANDSCAPE
60 SF + 260 SF = 320 SF TOTAL INTERIOR LANDSCAPE
ONE TREE PER 100 SF OF REQUIRED INTERIOR LANDSCAPE AREA
320 / 100 = 3 TREES
- 2) NORTH PERIMETER 10' BUFFER
45 LF / 50 = 2 CANOPY TREES
- 3) SOUTH PERIMETER 10' BUFFER
45 LF / 50 = 2 CANOPY TREES
- 4) EAST PERIMETER NA
- 5) WEST PERIMETER 10' BUFFER
175 LF / 50 = 4 CANOPY TREES
- TOTAL TREE REQUIREMENT = 3 + 2 + 2 + 4 = 11
16 REPLACEMENT TREES REQUIRED

LANDSCAPE INSTALLATION NOTES

- 1) ALL PLANT MATERIALS SHALL BE FLORIDA #1 OR BETTER AS GIVEN IN GRADES AND STANDARDS FOR NURSERY PLANTS, LATEST EDITION, PUBLISHED BY THE FLORIDA DEPARTMENT OF AGRICULTURE AND CONSUMER SERVICES.
- 2) LOCATION OF PLANTS ON THE PLAN ARE DIAGRAMMATIC- SEE THE LANDSCAPE ARCHITECT FOR QUESTIONS ON EXACT LOCATIONS. THE PLANT MATERIALS LIST IS PROVIDED FOR THE CONVENIENCE OF THE LANDSCAPE CONTRACTOR. SHOULD THERE BE ANY DISCREPANCY BETWEEN THE PLANT LIST AND THE PLAN, THE PLAN SHALL PREVAIL.
- 3) IT IS THE LANDSCAPE CONTRACTORS RESPONSIBILITY TO ENSURE THAT ALL PLANT BED AREAS HAVE PROPER DRAINAGE FOR OPTIMUM GROWTH OF LANDSCAPE MATERIAL BEFORE INSTALLATION BEGINS.
- 4) THE CONTRACTOR SHALL ENSURE THAT ALL PLANTING ISLANDS AND OTHER AREAS SHALL BE CLEAN OF TRASH, CONSTRUCTION DEBRIS, OR OTHER WASTE MATERIALS TO A DEPTH OF 24" PRIOR TO LANDSCAPE INSTALLATION.
- 5) ALL PLANT BEDS AND TREE RINGS SHALL BE TREATED WITH A PRE-EMERGENT HERBICIDE AND THEN TOP-DRESSED WITH PINE BARK NUGGET MULCH AT A DEPTH OF 3". ALL NEW TREES SHALL HAVE A TREE RING WITH A MINIMUM OF 24" RADIUS. ALL NEW TREES AND PALMS SHALL BE STAKED. ALL EXISTING TREES TO REMAIN SHALL HAVE A 6" RADIUS MULCH RING AT A DEPTH OF 3".
- 6) NEW SOD SHALL BE 45,700 SQ. FT. OF ARGENTINE BAHIA, AS SHOWN ON THE PLAN. CONTRACTOR SHALL DETERMINE EXACT QUANTITIES IN THE FIELD. SOD AREAS SHALL BE MAINTAINED BY THE CONTRACTOR FROM THE TIME OF INSTALLATION TO THE TIME OF FINAL ACCEPTANCE.
- 7) TREES SHRUBS, AND GROUND COVER SHALL BE INSTALLED USING THE FOLLOWING PROCEDURE: PLANT PITS SHALL BE EXCAVATED TO TWICE THE DIAMETER OF THE PLANT ROOT BALL. AERATE EXISTING SOIL BEFORE BACKFILLING PIT.
- 8) TREE INSTALLATION: ALL REQUIRED TREES SHALL BE INSTALLED 1" - 2" ABOVE FINISH GRADE. TREES INSTALLED OR BURIED TOO DEEP SHALL BE RESET TO THIS STANDARD. REMOVE THE TOP 1/3 OF THE WIRE BASKETS ON ALL B & B STOCK.

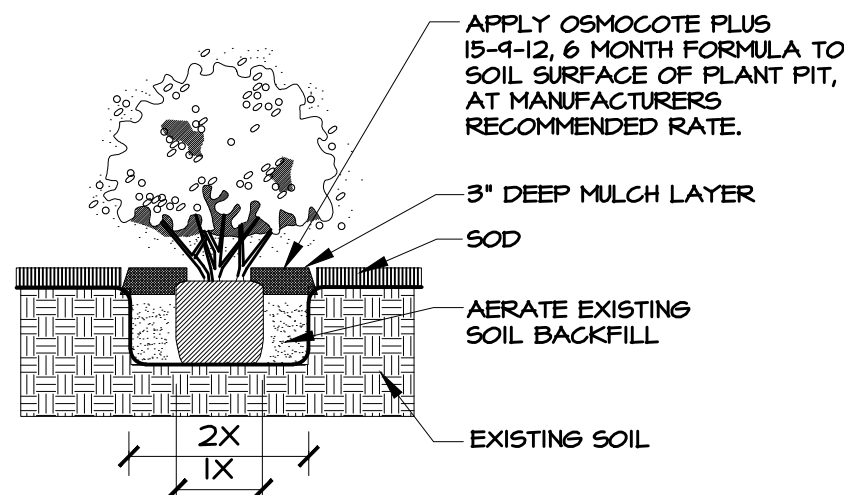

SHRUB PLANTING DETAIL

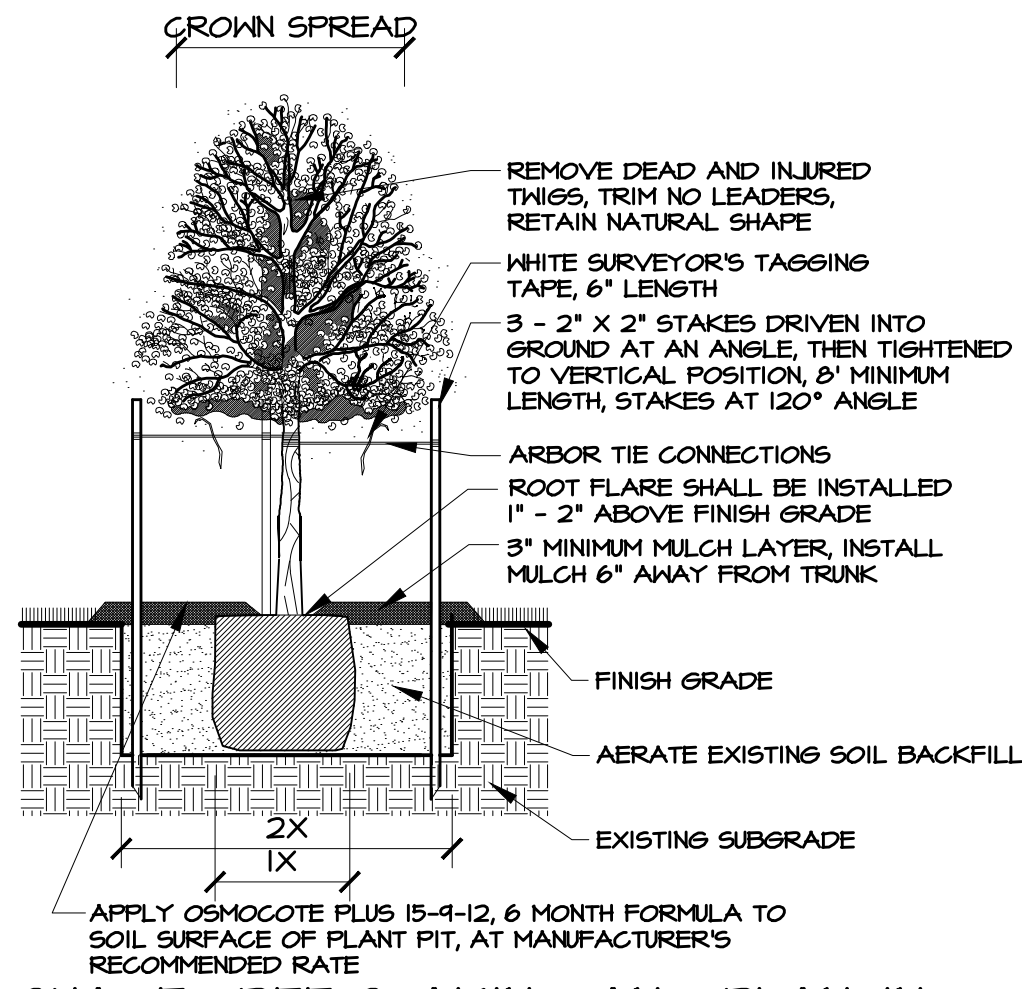

SHADE TREE STAKING AND PLANTING DETAIL

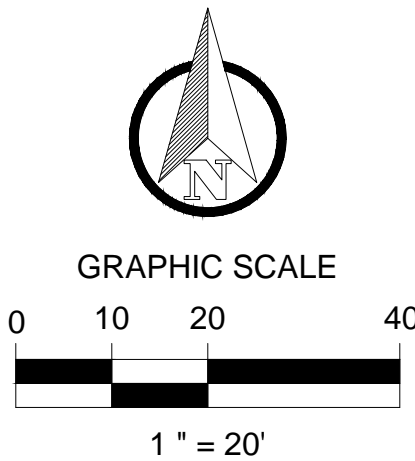

LANDSCAPE PLAN

ANDERSON LESNIAK LIMITED, INC.
landscape architecture
land planning
4921 SOUTH WESTSHORE BLVD. TAMPA, FLORIDA 33611
(813) 831-9595 FAX 831-5485 anderson.lesniak@tampabayfl.com

VENICE, FL 7-ELEVEN
116 N. TAMIAAMI TRAIL
VENICE, FL 34285

L. ALYSON UTTER, PLA FLORIDA LANDSCAPE ARCHITECT NO. LA 0001163		
PLAN STATUS		
7/17/18	REVIEW COMMENTS	
8/24/18	REVIEW COMMENTS	
10/29/18	REVISED SITE PLAN	
DATE	DESCRIPTION	
BG DESIGN	BG DRAWN	LAU CHKD
SCALE	AS SHOWN	
JOB No.	010063-02-134	
DATE	5-14-18	
SHEET		
L-2		

L-2