



Dewberry Engineers Inc.
800 NORTH MAGNOLIA AVE
SUITE 1000
ORLANDO, FL 32803
PHONE: 407.843.5120
ENGINEERING BUSINESS -8794
LAND. ARCH. - LC26000569

CITY OF VENICE, FLORIDA

Michael J. Urchuk
L RLA # 6666675
Dec 13, 2018

SCALE

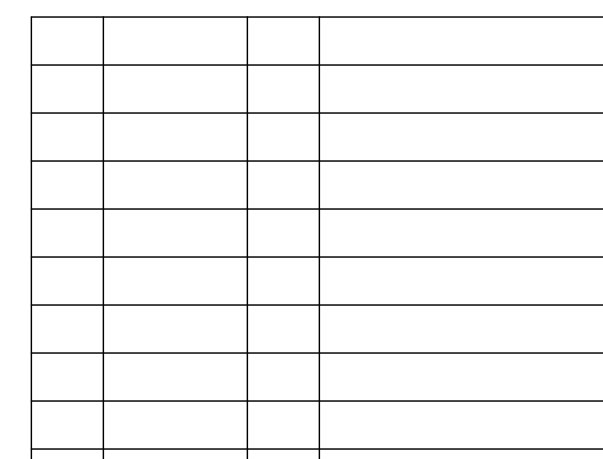
REVISIONS

APPROVED BY _____

DATE February 15, 2018

TREE REMOVAL PLAN

L1.10

SHEET NO. OF



VENICE PUBLIC
SAFETY FACILITY
S & D SITE PLAN

STILL, I AM NOT A VENDOR, I CONSIDER

SEAL



RLA # 6666675
Dec 13, 2018

KEY PLAN

SCALE



A horizontal graphic scale bar with alternating black and white segments. It is labeled with '0'', '30'', and '60'' at the beginning, middle, and end respectively.

[illegible]

No.	DATE	BY	Description
-----	------	----	-------------

REVISIONS

DRAWN BY

APPROVED BY

CHECKED BY

DATE February 15, 2018

TITLE

LANDSCAPE PLAN

PROJECT NO.	50102099
-------------	----------

L2.10

SHEET NO.

—

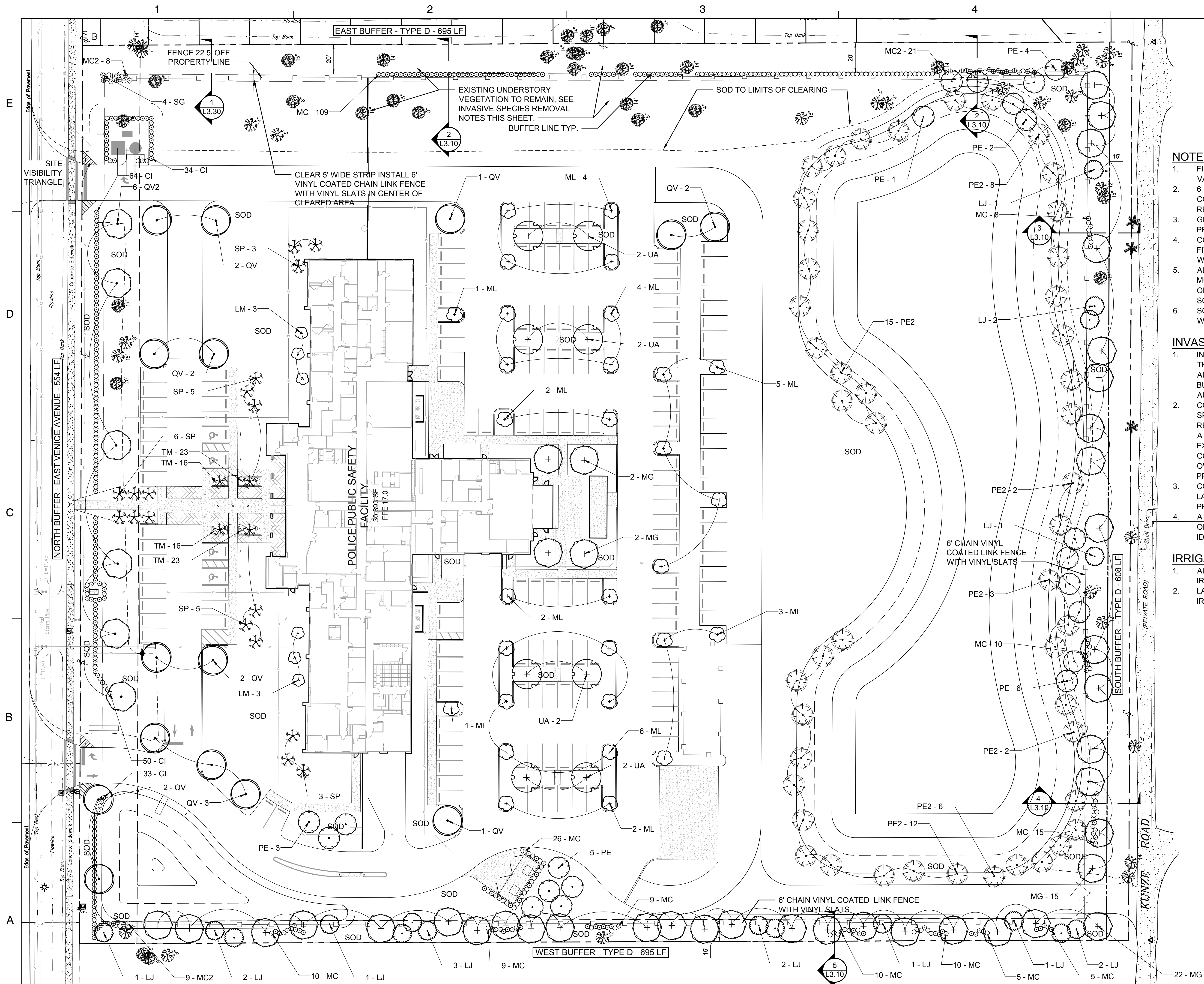

LANDSCAPE PLAN

SCALE: 1"=30'-0"

VENICE PUBLIC
SAFETY FACILITY
S & D SITE PLAN

CITY OF VENICE, FLORIDA

SEAL



Michael J. Urchuk
FL RLA # 6666675
Dec 13, 2018

KEY PLAN

SCALE

No.	DATE	BY	Description

No.	DATE	BY	Description
-----	------	----	-------------

REVISIONS

DRAWN BY

APPROVED BY

CHECKED BY

DATE February 15, 2018

TITLE

VUA PLAN, TABLES AND SCHEDULE

PROJECT NO. 50102099

L2.20

SHEET NO. OF

* EXISTING VEGETATION CONSISTS OF NATIVE MATURE TREES AND NATIVE UNDERSTORY WITH MINIMAL AREAS WITHOUT UNDERSTORY.

NOTE:

1. FINAL LOCATIONS AND PLANT SPECIES MAY VARY BASED UPON FIELD CONDITIONS
2. 6 FOOT FENCE WITH VINYL SLATS TO PROVIDE COMPLETE PHYSICAL AND VISUAL BARRIER AS REQUIRED BY CODE.

TREE REPLACEMENT CALCULATIONS:

TREES REMOVED:		REMOVED	REQUIRED REPLACEMENT	PROVIDED REPLACEMENTS
OAKS				
4"-15" DBH	84	84 @ 3" CAL (1:1)	}	138 @ 3" Cal. Trees 54 @ 5" Cal. Trees
16"-30"	3	6 @ 5" CAL (2:1)		
PINES				
4"-15"	52	52 @ 3" CAL (1:1)		
16"-30"	24	48 @ 5" CAL (2:1)		
HOLLY				
4"-15"	1	1 @ 3" CAL (1:1)		
PALMS	21	21 @ 12' HT. (1:1)		22

TREE POINTS REQUIREMENTS:

POINTS PER ACRE:	
REQUIRED:	<u>2,936</u>
BUFFERS:	1,954
PARKING:	399
SITE:	583 POINTS (9.71 ACRES AT 60 POINTS PER ACRE)
PROVIDED:	<u>4046</u>
BUFFERS:	2816
PARKING:	426
SITE:	804 (DOES NOT INCLUDE ANY BUFFER OR PARKING TREES)

INTERIOR LANDSCAPE AREA CALCULATIONS:

TOTAL VEHICULAR USE AREA:	104,816 SF
PARKING SPACES:	166
INTERIOR LANDSCAPE AREA	
REQUIRED:	3,320 SF (20 SF PER PARKING SPACE)
PROVIDED:	16,400 SF
TREE POINTS (0.12 POINTS PER SF OF REQUIRED AREA)	
REQUIRED:	399
PROVIDED:	426
	252 (21 CANOPY TREES AT 12 POINTS)
	174 (29 UNDERSTORY TREES AT 6 POINTS)
TREE POINTS PER ISLAND(6 POINTS PER ISLAND)	
EACH ISLAND CONTAINS ONE ORNAMENTAL TREE (6 POINTS)	
OR ONE CANOPY TREE (12 POINTS)	

NOTE:
1. GRAVEL AND GRASS VUA INCLUDED IN CALCULATIONS IN CASE AREAS ARE PAVED IN THE FUTURE.

TREE CREDIT TABLE			
BUFFER			
EAST	TREE	DBH	POINTS
	OAK	12	28
	OAK	7	19
	OAK	7	19
	PINE	17	49
	OAK	9	23
	OAK	14	34
	PINE	8	19
	PINE	15	41
	PINE	14	34
	PINE	14	34
	PINE	15	41
	PINE	8	19
	PINE	15	41
	PINE	9	23
	PINE	9	23
	PINE	14	34
	PINE	14	34
	PINE	15	41
	PINE	14	34
	PINE	14	34
	OAK	18	49
	OAK	14	34
	OAK	14	34
	PINE	14	34
	OAK	12	28
	OAK	6	16
	PINE	15	41
	OAK	14	34
	PINE	15	41
	OAK	12	28
	OAK	7	19
TOTAL		385	982
SOUTH	TREE	DBH	POINTS
	OAK	18	49
	OAK	9	23
	OAK	12	28
	PINE	15	41
	PINE	17	49
	OAK	12	28
	OAK	12	28
TOTAL		95	246
WEST	TREE	DBH	POINTS
	OAK	20	58
	OAK	12	28
TOTAL		32	86
NORTH	TREE	DBH	POINTS
	OAK	14	34
	PINE	14	34
	PINE	17	49
	OAK	18	49
	OAK	15	41
	PINE	20	58
TOTAL		98	265

PLANT SCHEDULE

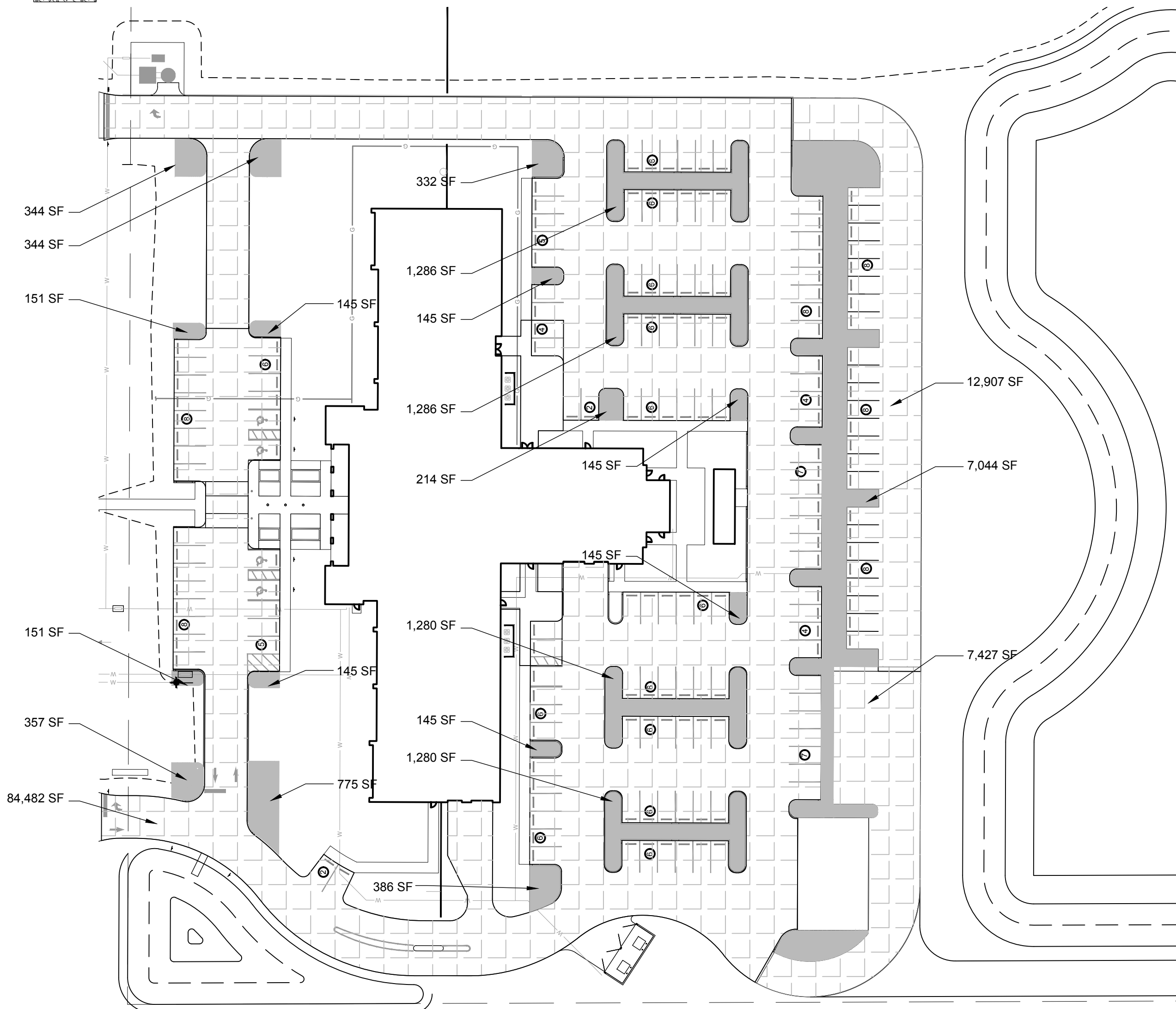

TREES	CODE	QTY	BOTANICAL NAME / COMMON NAME	CAL.	SIZE	REMARKS
	LM	6	Lagerstroemia indica 'Muskogee' / Muskogee Crape Myrtle	1.5" Avg	8' Ht.	
	LJ	17	Ligustrum japonicum / Japanese Privet	1.5" Avg	8' Ht.	3 - 5 STEMS
	MG	41	Magnolia grandiflora / Southern Magnolia	3" Cal.	12' Ht. x 6' Spr.	
	ML	30	Magnolia grandiflora 'Little Gem' / Dwarf Southern Magnolia	3" Cal.	8' Ht. x 4' Spr.	
	PE	21	Pinus elliotti / Slash Pine	3" Cal.	8' Ht. x 4' Spr.	
	PE2	48	Pinus elliotti / Slash Pine	5" Cal.	14' Ht. x 6' Spr.	
	QV	15	Quercus virginiana / Southern Live Oak	3" Cal.	12' Ht. x 6' Spr.	
	QV2	6	Quercus virginiana / Southern Live Oak	5" Cal.	14'-16' Ht. x 8'-10' Spr.	
	SP	22	Sabal palmetto / Cabbage Palmetto	--	12" O.A. Ht.	
	UA	8	Ulmus parvifolia 'Allee' / Allee Lacebark Elm	3" Cal.	12' Ht. x 6' Spr.	
SHRUBS	CODE	QTY	BOTANICAL NAME / COMMON NAME	CONT.	SIZE	REMARKS
	CI	181	Chrysobalanus icaco / Coco Plum	3 gal	24" Ht - 18" Spr.	
	MC2	38	Myrica cerifera / Wax Myrtle	--	48" Ht. x 30" Spr.	
	MC	226	Myrica cerifera / Wax Myrtle	3 gal	24" Ht - 18" Spr.	
	SG	4	Serenoa repens 'Green' / Saw Palmetto	7 gal	24" Ht - 18" Spr.	

GROUND COVERS	CODE	QTY	BOTANICAL NAME / COMMON NAME	CONT	SIZE	REMARKS
	TM	78	Trachelospermum asiaticum 'Minima' / Minima Jasmine	1 gal	FULL	



INTERIOR LANDSCAPE AREA DIAGRAM
N.T.S.

KEY:

 VUA  LANDSCAPE AREA

VENICE PUBLIC
SAFETY FACILITY
S & D SITE PLAN
CITY OF VENICE, FLORIDA

SEAL



FL RLA # 6666675
Dec 13, 2018

KEY PLAN

SCALE

No.	DATE	BY	Description

REVISIONS

DRAWN BY _____

APPROVED BY _____

CHECKED BY _____

DATE February 15, 2018

TITLE _____

BUFFER SECTIONS

PROJECT NO. 50102099

L3.10

SHEET NO. _____ OF _____

