

INTRODUCTION

Project RFP Number and Name	RFQ # 3079-18 Construction Management at Risk Services for City of Venice Public Safety Facility
Firm's Name and Address	Chris-Tel Company of Southwest Florida, Inc., dba Chris-Tel Construction
Firm Contact Person and Info	Howard L. Wheeler, II, President (239) 226-0500 (239) 226-0503 fax hwheeler@christelconstruction.com
Years in Business Current Name	11 Years
Previous Name	Chris-Tel Company of Southwest Florida, Inc.

WHAT SETS US APART

LONGEVITY

Our company was founded in 1989 in Fort Myers, Florida. We boast over 90 years of family history, and are committed to establishing and engaging in long term relationships with our clients built upon the principles of integrity, dedication, quality craftsmanship and unwavering work ethic.

ZERO CORPORATE

We have doubled in size since 2015 in regards to number of staff and portfolio. This growth, however, has not changed our culture nor our relationships with our clients. We are local, available, and involved from the top down on every project.

FINANCIAL STRENGTH

We are a stable and financially sound firm with a bonding capacity of \$50 Million for a single project and \$100 Million aggregate. We continue to have a lower than average MOD Factor(0.81).

SUB-CONTRACTOR RELATIONSHIPS

We have strong, long-standing relationships with the local subcontractor and vendor community in Southwest Florida. Our ability to provide our clients with fair and exact pricing for labor and materials maintains our status as an ethical and respected leader in the industry.

DIVERSIFIED TEAM

Our firm's three distinct groups allow our Project Managers, Superintendents, and staff to offer our clients specific knowledge based on the scope at hand and provide a lessons learned and best means approach.

WORKING RELATIONSHIP WITH MUNICIPAL OFFICIALS

We have fostered a solid working relationship with local County and City officials. This is paramount when navigating permitting, design and certifications during construction, as well as tax incentives provided to our clients from the County and City.

UNMATCHED PRECONSTRUCTION

With over 80 years of combined experience, our estimating and preconstruction team has the ability to lower the client budget by up to 40% by using the latest technology, coupled with long-standing subcontractor relationships.

ABILITY TO SELF PERFORM

Our team of qualified craftsman are able to self-perform various tasks on an as-needed basis. These skill sets are used in order to achieve the budget or accelerate the schedule if it is in the best interest of the client, or if it is in an emergency capacity.

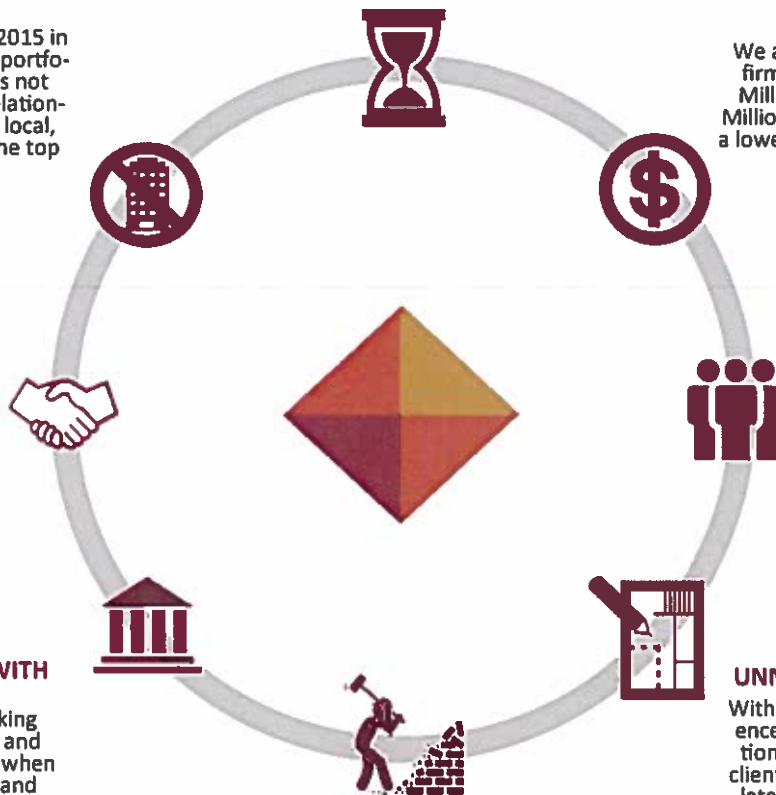



TABLE OF CONTENTS

Introduction.....1

Table of Contents.....2

Tab 1: Letter of Interest.....3

Tab 2: Team Qualifications.....4

Tab 3: Team Experience/References.....9

Tab 4: Ability to Perform & Location.....16

Tab 5: Additional Considerations.....19

Tab 6: Required Forms, Insurance, & Certifications.....20



TAB 1—LETTER OF INTEREST

March 2, 2018

City of Venice

Procurement— Finance Department

401 W. Venice Ave—Purchasing - Room 204

Venice, FL 34285

Dear Mr. Boers,

Chris-Tel Construction is pleased to present our qualifications for the RFQ # 3079-18 Construction Management at Risk Services for City of Venice Public Safety Facility. We are a full service construction management company and a licensed General Contractor in the state of Florida. Our headquarters, and only office is located in Fort Myers, Florida and has been in business since 1989. For the past 11 years, we have been operating as Chris-Tel Company of Southwest Florida, Inc., dba Chris-Tel Construction. Prior to that, we were operating as Chris-Tel Company of Southwest Florida, Inc. Chris-Tel was incorporated on January 29, 1993 in the state of Florida and is owned and operated here locally by Howard L. Wheeler, II, President and Donnie Singleton, Executive Vice President. We are able to operate as a General Contractor/Construction Management firm in the state of Florida (Lic. #CGC038604). The following information in the response is free of trade secret/proprietary information. Chris-Tel is an equal opportunity employer that makes an effort to hire local subcontractors, including DBE/W/MBE's. Our single project bonding capacity is \$50 million dollars, which is an attribute to our verifiable financial strength in this current economic climate.

Chris-Tel Construction has a diverse portfolio of award winning project experience, specifically with the Construction Manager at Risk delivery method. Our work knowledge encompasses numerous jobs of varying scope and complexity. Currently, Chris-Tel Construction is segmented into three areas: Commercial (projects over \$2M to include new construction, tenant build-out or renovation), Site/Civil, and Special Projects (which include projects \$2M and under consisting of Historic Restoration, Renovation and Continuing Services Contracts) which helps to foster marketplace diversity.

Our firm has provided many Municipalities and Government entities with successfully completed projects during our 30 years in business. Specifically to this project, our firm had precise experience with regards to performance and delivery on the North Fort Myers Recreation Center, multiple fire stations, renovations to a Florida Highway Patrol Station, labs for the Florida Department of Law Enforcement, and renovations to a secure area for a baggage handling system for the Lee County Port Authority. In addition, we have done relevant work for private clients including the Westin Conference Center, Eastern Metal Supply facilities (both Fort Myers and Lake Worth), addition to a residence to include an indoor gun range, and construction of multiple industrial buildings.

We appreciate your consideration of Chris-Tel Construction for RFQ # 3079-18 Construction Management at Risk Services for City of Venice Public Safety Facility. We look forward to providing you with the utmost customer care, quality craftsmanship and specific knowledge for this project. We welcome the opportunity to expand on our qualifications in a formal presentation.

Sincerely,



Howard L. Wheeler, II
President



TAB 2—PROJECT TEAM QUALIFICATIONS AND KEY PERSONNEL EXPERIENCE



EDUCATION/QUALIFICATIONS

Edison State College
31 Years of Experience
28 Years with Chris-Tel Construction

CERTIFICATIONS

Certified General Contractor State of Florida (Lic. CGC 038604)
Certified Solar Contractor State of Florida (Lic. CVC 56963)
Certified Renovator—Lead Safe
Rehabilitation Education & Preservation (R.E.A.P.) Certified Historic Craftsman

Affiliations

US Green Building Council, Member
Real Estate Investment Society, Member
Associated Builders & Contractors, Member
Florida Repertory Theatre Board of Directors, Member

HOWARD L. WHEELER, II

President/Principal-In-Charge

As Founder and President, Howard is in complete charge of every phase of Chris-Tel Construction. As a native Floridian and a third generation contractor in the Fort Myers area, he brings a lifetime of construction acumen and a genuine understanding of the particular construction demands in Southwest Florida. Howard founded Chris-Tel Construction in 1989 and provides executive administration for projects collectively totaling more than \$150 million in value. Because he works and plays in his hometown, Howard exemplifies community involvement in his endeavors with charitable organizations and other local community groups in and around Southwest Florida.

REPRESENTATIVE EXPERIENCE

North Fort Myers Recreation Center—Lee County Government

New construction of 35,000 SF rec center complete with a gymnasium, meeting rooms, multi-purpose space, outdoor pavilion, catering kitchen, and standby generator so the facility can be used as an emergency shelter.

Westin Conference Center—Cape Coral, FL

New construction of the conference center at Tarpon Point. Project includes 35,000 SF ballroom that will hold up to 1,250 guests, with a pre-function area, a terrace overlooking the river and a pedestrian bridge connecting the conference center to the parking lot.

Eastern Metal Supply—Fort Myers, FL

New construction of a 172,000 SF door and window assembly plant on 20 acres housing office suites, a showroom, a breakroom, and a manufacturing area.

Bayshore Fire & Rescue Station—Fort Myers, FL

New Construction of a fire station with a commercial kitchen, administrative area, living space, sleeping quarters, and generator.

Florida Highway Patrol Station—Naples, FL

Renovation of existing patrol station to create new office spaces and radio room, as well as installation of hurricane resistant windows and a new security system.

City of Fort Myers Fire Station No. 4—Fort Myers, FL

Renovation of existing fire station including ADA compliance upgrades to entrance and exit ramps, restroom renovations, MEP upgrades.

FDLE Biology and Serology DNA Labs—Fort Myers, FL

Renovation of existing Florida Department of Law Enforcement patrol station to upgrade evidence process spaces to satisfy requirements for Serology/DNA casework, as well as installation of built-in counters, cabinets, and Medintech flash covered and heat welded hospital flooring.

LCPA Baggage Handling/Inspection System at SWFIA—Fort Myers, FL

Renovation of high security area including demolition and modifications to block walls, ceilings, floors, and MEP, as well as installation of new concrete pads, drywall, metal framing, insulation, fire sealants, and acoustical ceiling to prepare for installation of new baggage handling and inspection system.

Martin Pool Pavilion—Boca Grande, FL

New addition to a residence to include installation of a Myrtha Olympic style, two lane, heated lap pool, a two lane archery/gun range, a fitness/weight room, a living room entertainment area, and a full outdoor grilling kitchen/bar with fire pit and outdoor lounging area.

Eastern Metal Supply—Lake Worth, FL

New construction of a 40,000 SF industrial building including a super flat concrete slab flooring for window and door manufacturing equipment, interior offices, break room, training room, show room, and dock bay roll up doors.

Materials Recovery Facility—Fort Myers, FL

New construction of three pre-engineered steel structures for Lee County Government, Solid Waste Division to house baled storage, maintenance operations, and tipping floor, as well as new construction of by-pass road for recycling trucks.

Pocklington Facility—Fort Myers, FL

New construction of an industrial building housing office space, restrooms, a break room, and a conference room.

Westbury Industrial Building—Fort Myers, FL

New construction of an industrial building including tilt wall construction and installation of sprinkler system, MEP, ceilings, cabinetry, windows, and exterior finishes.

Direct Industrial Products—LaBelle, FL

Renovation of an existing industrial building to create office space, reception area, showroom and sales area, kitchen, restrooms, warehouse space, site work, and perimeter fencing.

TAB 2—PROJECT TEAM QUALIFICATIONS AND KEY PERSONNEL EXPERIENCE



EDUCATION/QUALIFICATIONS

Virginia Polytechnic Institute and State University, BS Building Construction
39 Years of Experience
4 Years with Chris-Tel Construction

AFFILIATIONS

Horizon Council, Member and Past President
Cape Coral Construction Industry Association, Member and Past President
Cape Coral Council for Progress, Board Member

BOB KOENIG

Project Executive

As Vice President of Construction and Project Executive, Bob has thirty-eight (38) years of construction industry experience, mostly in Southwest Florida. His responsibilities include providing executive administration for projects, constructability analysis, cost control, value engineering, quality control and negotiations with clients and owners. Throughout his career, Bob has provided executive administration for projects collectively totaling more than \$1 billion in construction value. Bob exemplifies community involvement in his endeavors with local community organizations throughout his career.

REPRESENTATIVE EXPERIENCE

Westin Conference Center—Cape Coral, Florida

New construction of the conference center at Tarpon Point. Project includes 35,000 SF ballroom that will hold up to 1,250 guests, 4,700 SF pre-function area, a 1,700 SF terrace overlooking the river and a pedestrian bridge connecting the conference center to the parking lot.

Eastern Metal Supply—Fort Myers, FL

New construction of a 172,000 SF door and window assembly plant on 20 acres housing office suites, a showroom, a breakroom, and a manufacturing area.

Eastern Metal Supply—Lake Worth, FL

New construction of a 40,000 SF industrial building including a super flat concrete slab flooring for window and door manufacturing equipment, interior offices, break room, training room, show room, and dock bay roll up doors.

Ortiz Jail—Fort Myers, FL

\$53 million addition to the existing Ortiz Jail adding 768 beds on eight levels.

Somero Enterprises, Inc.—Fort Myers, FL

New Construction of a 14,000 SF office and training facility housing the executive team and staff with office space, training rooms, conference room, and kitchen.

Veterans Administration Ambulatory/Outpatient Surgical Center—Cape Coral, FL

State of the art, 222,988 SF, four-story hospital situated on 30+ acre site, featuring a 14,000 SF open front lobby, eight operating rooms, four soundproof audiology booths, 3,200 SF laboratory, 4,500 SF pharmacy, nine dental offices and a 25,000 SF, two-story energy plant with three 1,500 KW generators and an electric fire pump.



EDUCATION/QUALIFICATIONS

Purdue University, Bachelor of Science, Building Construction
35 Years of Experience
3 Years with Chris-Tel Construction

CERTIFICATIONS

Certified General Contractor (exp.)
State of Florida (Lic. CGC 021578)

JOE PRESSLER

Manager of Preconstruction and Estimating

As Manager of Preconstruction and Estimating, Joe brings thirty-five (35) years of construction industry experience. His responsibilities include project estimation, preparing bid and proposals, bid clarification and interpretation, developing scope of work, monitoring work progress as it relates to the budget, negotiation with owners, providing value engineering, establishing and maintaining relationships with various subcontractors in and around the community, enabling Chris-Tel Construction to provide fair pricing as determined by the market.

REPRESENTATIVE EXPERIENCE

Westin Conference Center—Cape Coral, Florida

New construction of the conference center at Tarpon Point. Project includes 35,000 SF ballroom that will hold up to 1,250 guests, 4,700 SF pre-function area, a 1,700 SF terrace overlooking the river and a pedestrian bridge connecting the conference center to the parking lot.

Eastern Metal Supply—Fort Myers, FL

New construction of a 172,000 SF door and window assembly plant on 20 acres housing office suites, a showroom, a breakroom, and a manufacturing area.

Ortiz Jail—Fort Myers, FL

\$53 million addition to the existing Ortiz Jail adding 768 beds on eight levels.

Somero Enterprises, Inc.—Fort Myers, FL

New Construction of a 14,000 SF office and training facility housing the executive team and staff with office space, training rooms, conference room, and kitchen.

Eastern Metal Supply—Lake Worth, FL

New construction of a 40,000 SF industrial building including a super flat concrete slab flooring for window and door manufacturing equipment, interior offices, break room, training room, show room, and dock bay roll up doors.

Collier County Government Jail Garage—Naples, FL

New construction of a 3-story parking garage featuring 1,100 vehicular parking spaces. Included site development, utilities, and integration to existing facilities. Garage includes stair wells and elevator for ADA accessibility.

TAB 2—PROJECT TEAM QUALIFICATIONS AND KEY PERSONNEL EXPERIENCE



EDUCATION/QUALIFICATIONS

University of North Florida, Jacksonville—
Bachelor of Science, Building Construction
Management
15 Years of Experience
1 Year with Chris-Tel Construction

CERTIFICATIONS

Sigma Lambda Chi International Construc-
tion Honor Society, Member
FDOT Concrete Field Inspector Level I
ACI Compressive Strength Testing Techni-
cian
OSHA 30 Hr. Certification

COMPUTER EXPERTISE

Microsoft Project, Primavera, Blue Beam,
Suretrak & Oracle, DBO2 Safety Net /
Mobile, Prolog Manager, Procore Con-
struction Management

SEAN SMILEY

Project Manager

Sean comes to Chris-Tel Construction with more than fifteen (15) years of project management experience in vertical construction, including compliance evaluation inspections, permitting, under all delivery methods, from concept to completion. His experience includes industrial and municipal construction and development, healthcare, higher education, hospitality, residential, sports/recreation and retail. Sean oversees vertical construction over \$2M and will perform kick-off and progress meetings, design review, scheduling, coordination of equipment and materials, establishment of equipment lead times and critical path items, coordination of all mechanical trades, maintenance of budgeted man-hours, subcontractor coordination, equipment and material costs.

REPRESENTATIVE EXPERIENCE

Cypress Cove Independent Living Facility—Fort Myers, Florida

New construction of \$7M addition to Cypress Cove Villas. Featuring seven buildings for a total of 14 two and three-bedroom independent living homes on the 48-acre South Fort Myers Life Plan Community campus. Construction slated to be complete early summer 2018.

P:\Business Development\Client Letters and Qual Packages\London Bay Homes

Sanibel Library—Sanibel, FL

Renovation of the Sanibel Public Library to include improvements to the AC, fire suppression, plumbing, electrical and wireless services, as well as modernization of the facility. Key features include a flex space and reconfiguration of meeting rooms and offices, as well as construction of a new book drop, children's room, TeenSpace, outdoor porch, adult reading room, two mini computer labs, study rooms, a digitization station, and a think tank for study and collaboration. *The library is utilizing sustainable design features such as energy efficient HVAC and lighting, use of recycled materials, water efficient landscaping, low-flow plumbing and natural light spaces with day-lighting controls.*



QUALIFICATIONS

14 Years of Experience
1 Year with Chris-Tel Construction

CERTIFICATIONS

MOT Advanced Certified
Traffic Control Flagger
HAZMAT Certification
ACI Concrete Field Tech, Grade 1
FDOT Concrete Inspector
FLDEP Stormwater Management
Inspector
Earthwork Construction Level 1&2
Nuclear Gauge Safety Training
OSHA T10 Hr. Certification

MIKE KAYS

Quality Control Specialist/Superintendent

Mike has over fourteen (14) years of experience in the construction and engineering industry. His responsibilities as Superintendent/QC Specialist include overseeing contractors and subcontractors on the job site, field management related to plans and specifications as well as owner's project goals under all delivery methods. His experience with utility construction plan review, field inspection and reporting allow him to be an asset to the client throughout the construction process.

REPRESENTATIVE EXPERIENCE

Estero Boulevard Improvements—Fort Myers Beach, FL

Multi-phase project consisting of six one-mile segments. The scope includes installing a new force main, new storm drain, sidewalk improvements, trolley stop locations, center drainage pavers, and complete rebuild of the roadway from right-of-way to right-of-way, MOT, striping, and paving.

Quality Control and Engineering Inspector for the following:

Florida Department of Transportation

Lee County Port Authority

City of Fort Myers

City of Cape Coral

Lee County Government

Collier County Government

City of Naples

Army Corp of Engineers

City of Lake Placid

Highlands County Government

TAB 2—PROJECT TEAM QUALIFICATIONS AND KEY PERSONNEL EXPERIENCE



QUALIFICATIONS

15 Years of Experience
1 Year with Chris-Tel Construction

CERTIFICATIONS

OSHA 30 Hr. Certification
American Red Cross CPR/AED—Adult
FDEP—Stormwater Erosion & Sediment Control Inspector

GEORGE PISELLO

Superintendent

George brings over 15 years of construction industry experience, having worked as a Superintendent and Quality Control Associate. His experience in commercial construction spans the genres of residential, hospitality, industrial, municipal, sports/recreation, higher education and healthcare. His responsibilities include overseeing contractors and subcontractors on the jobsite, providing field management related to plans, specifications and schedules, allocating resources, organizing weekly coordination meetings, and adhering to owner's project goals under all delivery methods.

REPRESENTATIVE EXPERIENCE

Westin Conference Center—Cape Coral, Florida

New construction of the conference center at Tarpon Point. Project includes 35,000 SF ballroom that will hold up to 1,250 guests, 4,700 SF pre-function area, a 1,700 SF terrace overlooking the river and a pedestrian bridge connecting the conference center to the parking lot.

Florida Gulf Coast University Academic Building 8—Fort Myers, FL

New construction of a Certified Silver LEED Green Building; 64,000sqft four story nursing school, with 4 story 735 car attached parking garage, operating room, patient rooms, Physical Therapy Labs and Therapy pool.

Florida Gulf Coast University Whitaker Hall School of Engineering—Fort Myers, FL

New construction of a 4-story, 72,000 SF green building housing classrooms, labs, lecture halls and \$6mm link connecting building.

Veterans Administration Ambulatory/Outpatient Surgical Center—Cape Coral, FL

State of the art, 222,988 SF, four-story hospital situated on 30+ acre site, featuring a 14,000 SF open front lobby, eight operating rooms, four soundproof audiology booths, 3,200 SF laboratory, 4,500 SF pharmacy, nine dental offices and a 25,000 SF, two-story energy plant with three 1,500 KW generators and an electric fire pump.



EDUCATION/QUALIFICATIONS

Florida SouthWestern State College
1 year of experience
1 year with Chris-Tel Construction

CERTIFICATIONS

Notary Public
Fair Housing Classes

RACHEL COMERFORD

Assistant Project Manager

Rachel has one (1) year of project administration experience working in the construction industry including bidding preparation, permitting, and organizing all aspects of paperwork from start to finish. She is highly focused and results-oriented while supporting a complex, deadline-driven operation. Rachel supervises communication and correspondence, tracks RFI's, permitting and timeliness of submittals. Coordinates bid documents, manages change orders, contracts, verifies subcontractor certified payroll & draw request on contract amounts and processes all detailed paperwork pertaining to each phase of every project. Pre-qualifies subcontractors, submits invitation to bid to all subcontractors and ensures participation from all trades.

REPRESENTATIVE EXPERIENCE

Westin Conference Center—Cape Coral, Florida

New construction of the conference center at Tarpon Point. Project includes 35,000 SF ballroom that will hold up to 1,250 guests, 4,700 SF pre-function area, a 1,700 SF terrace overlooking the river and a pedestrian bridge connecting the conference center to the parking lot.

Eastern Metal Supply—Lake Worth, FL

New construction of a 40,000 SF industrial building including a super flat concrete slab flooring for window and door manufacturing equipment, interior offices, break room, training room, show room, and dock bay roll up doors.

Somero Enterprises, Inc. Concrete Institute—Fort Myers, FL

New Construction of a one-of-a-kind, custom designed, 6,300 SF concrete block facility enabling Somero Enterprises, Inc. to provide intermediate and advanced training classes utilizing the company's own laser screed concrete leveling machines.

TAB 2—PROJECT TEAM QUALIFICATIONS AND KEY PERSONNEL EXPERIENCE



EDUCATION/QUALIFICATIONS

8 Years of Experience
1 Year with Chris-Tel Construction

CERTIFICATIONS

Viewpoint Software
Microsoft Office Suite
Adobe Creative Suite

ANDREA CARNES

Accounts Payable

Andrea has more than eight (8) years of experience in accounts payable and receivable for the construction industry here in Southwest Florida. Her responsibilities for this project will include job cost set up, accounts payable, subcontractor invoicing and schedule of values monitoring, budget monitoring, change orders, job cost reporting, client billing and final close out payment documentation.

REPRESENTATIVE EXPERIENCE

Westin Conference Center—Cape Coral, Florida

Accounts Payable and billing services for new construction of the conference center at Tarpon Point. Project includes 35,000 SF ballroom that will hold up to 1,250 guests, 4,700 SF pre-function area, a 1,700 SF terrace overlooking the river and a pedestrian bridge connecting the conference center to the parking lot.

Martin Pool Pavilion—Boca Grande, FL

Accounts payable and billing services for new addition to a residence to include installation of a Myrtha Olympic style, two lane, heated lap pool, a two lane archery/gun range, a fitness/weight room, a living room entertainment area, and a full outdoor grilling kitchen/bar with fire pit and outdoor lounging area.

Eastern Metal Supply—Lake Worth, FL

Accounts payable and billing services for new construction of a 40,000 SF industrial building including a super flat concrete slab flooring for window and door manufacturing equipment, interior offices, break room, training room, show room, and dock bay roll up doors.

Continuing Services Contract—Various

Accounts payable and billing services for all continuing contract projects for Lee County Government, Collier County Government, Hendry County Government, and the City of Fort Myers.



EDUCATION/QUALIFICATIONS

20 Years of Experience
1 Year with Chris-Tel Construction

CERTIFICATIONS

Viewpoint Software
Microsoft Office Suite
OSHA 30 Hr. Certification

ALBA GONZALEZ

Compliance Specialist/Safety

Alba has more than twenty (20) years of experience in Human Resources, Compliance and Accounts Payable. She is responsible for onboarding all new associates and administering all training sessions for OSHA and other compliance agencies. Her responsibilities include coordinating and carrying out site visits to job sites for compliance and safety, conducting on-site training and compiling documentation for monthly reporting to owners as well as ongoing safety and insurance auditing. Her role also includes accounts payable and assisting associates with documentation and accounting for expenses and invoicing.

REPRESENTATIVE EXPERIENCE

Westin Conference Center—Cape Coral, Florida

New construction of the conference center at Tarpon Point. Project includes 35,000 SF ballroom that will hold up to 1,250 guests, 4,700 SF pre-function area, a 1,700 SF terrace overlooking the river and a pedestrian bridge connecting the conference center to the parking lot.

Martin Pool Pavilion—Boca Grande, FL

New addition to a residence to include installation of a Myrtha Olympic style, two lane, heated lap pool, a two lane archery/gun range, a fitness/weight room, a living room entertainment area, and a full outdoor grilling kitchen/bar with fire pit and outdoor lounging area.

Continuing Services Contract—Various

Accounts payable and billing services for continuing contract projects for Lee County Government, Collier County Government, Hendry County Government, and the City of Fort Myers.

Somero Enterprises, Inc. Concrete Institute—Fort Myers, FL

New Construction of a one-of-a-kind, custom designed, 6,300 SF concrete block facility enabling Somero Enterprises, Inc. to provide intermediate and advanced training classes utilizing the company's own laser screed concrete leveling machines.



TAB 3—PROJECT TEAM EXPERIENCE/REFERENCES



North Fort Myers Recreation Center

Chris-Tel Construction was selected to provide **Construction Management at Risk** services to **Lee County Government** for the construction of the North Fort Myers Recreation Center in North Fort Myers, Florida. In conjunction with Parker/Mudgett/Smith Architects, the **35,000 SF** facility construction included **site development, underground utilities, sod installation, drainage and roadways; outdoor pavilion and dining area, fitness center, game room, catering kitchen, lounge area, multi-purpose flex space, basketball court, high performance windows, high efficiency HVAC and a standby generator system so the facility can be used as an emergency shelter in case of a storm event.** The project was completed in a twelve month timeframe, one month earlier than originally scheduled, and **\$2,000,000 under budget.**

SIMILAR

Services Provided	Construction Manager at Risk
Architect	Parker/Mudgett/Smith Architects, Inc.
Square Footage	35,000 SF
Total Project Cost	\$6,428,697
Final Delivery Date	October 2013
Project Reference	Dave Harner, Lee County Government, Construction & Design 239-533-7275 dave@leegov.com

SIZE &
COMPLEXITY

TAB 3—PROJECT TEAM EXPERIENCE/REFERENCES



Westin Conference Center

Provided **Construction Manager-at-Risk** services for the construction of the Westin Conference Center at Tarpon Point in Cape Coral, Florida. Working in conjunction with Christopher J. Lee Architects, the facility features a **35,000 square foot ballroom addition** that has the capacity to divide into six distinct meeting spaces and can accommodate up to 1,250 guests. Other expansion features include a 4,700 square foot pre-function area, a 1,700 square foot terrace overlooking the Caloosahatchee River Estuary, state-of-the-art catering kitchen, paved parking lot, a timber pedestrian bridge and a porte cochere. Also included is site development and utility installation as well as the installation of two (2) 10.3 seer Daikin 160 ton chillers for the facility. Construction was completed in December 2017, two months before expected completion and \$500,000 under budget.

Services Provided	Construction Manager at Risk
Architect	Christopher J. Lee Architects, Inc.
Square Footage	35,000 SF
Total Project Cost	\$13,840,317
Final Delivery Date	January 2018
Project Reference	Lauren Snyder, Freeman & Hasselwander Resort Properties, LLC 239-471-0264 ext. 200 lsnyder@tarponpoint.com

TAB 3—PROJECT TEAM EXPERIENCE/REFERENCES



Eastern Metal Supply

Provided **Construction Manager-at-Risk** services for the construction of Eastern Metal Supply in Fort Myers, FL. The facility is a door and window assembly plant on **twenty (20)** acres in south Lee County. The site and construction allows for up to 250,000 SF of future expansion. Scope of work included **site development**—consisting of a three acre storm water management lake and 1 acre indigenous preserve, infrastructure, MEP/HVAC/Fire, concrete slab foundation, interior office suites, showroom, break room, manufacturing area with break room seating, exterior finishes, landscaping and parking area. Dock bay roll up doors encompass the entire rear of the building.

Services Provided	Construction Manager at Risk
Architect	William Kyle Kitchens, AIA
Square Footage	172,000 SF
Total Project Cost	\$6,827,245
Final Delivery Date	March 2015
Project Reference	Greg Weekes, GSG Investments South Florida, LLC 800-432-2204 gweekes@easternmetal.com

TAB 3—PROJECT TEM EXPERIENCE/REFERENCES OTHER RELEVANT WORK

Bayshore Fire & Rescue Station



Services Provided	Construction Manager at Risk
Architect	Titsch & Associates
Square Footage	18,898 SF
Total Project Cost	\$440,000
Final Delivery Date	November 1996
Project Reference	Lee County Public Works / Construction, Bob Taylor 239-707-0769
Project Description	The scope for this project included the construction of a new fire station with a commercial kitchen, 3 docking bay doors, an administrative area, living spaces, sleeping quarters, and a generator.

Florida Highway Patrol Station



Services Provided	Construction Manager at Risk
Architect	Akel Logan Shafer Architects
Square Footage	various
Total Project Cost	\$108,670
Final Delivery Date	2009
Project Reference	Florida Highway Safety and Motor Vehicles 2013, Harold V. Branch
Project Description	The scope of work for this project included the modernization of existing spaces with focus on technology upgrades, demolition of walls to create new office spaces, remodel of a 400 sf radio room to accommodate automated communications equipment, installation of hurricane resistant windows, installation of new security system.

City of Fort Myers Fire Station No. 4



Services Provided	Construction Manager at Risk
Architect	Alliance Design Group
Square Footage	11,000 SF
Total Project Cost	\$60,000
Final Delivery Date	2011
Project Reference	City of Fort Myers, Albert Melendez 239-277-0554 amelen-dez@cityfymyers.com
Project Description	The scope of work for this project included ADA compliance upgrades to entrance and exit ramps, renovation to the restrooms, MEP upgrades, interior finishes to include ceiling, lighting, painting and flooring, and installation of new doors and windows.

TAB 3—PROJECT TEM EXPERIENCE/REFERENCES—OTHER RELEVANT WORK

Florida Department of Law Enforcement Biology & Serology DNA Labs



Services Provided	Construction Manager at Risk
Architect	Design Build
Square Footage	3,000 SF (Biology Lab) & 400 SF (Serology Lab)
Total Project Cost	\$122,809 (Biology Lab) & \$25,000 (Serology Lab)
Final Delivery Date	June 2008 (Biology Lab) & January 2015 (Serology Lab)
Project Reference	Florida Department of Law Enforcement, Mary Christofano 239-278-7080 mary.christofano@fdle.state.fl.us
Project Description	The scope for this project included upgrading evidence processing spaces by remodeling sections of the facility to satisfy requirements for Serology/DNA casework, as well as installation of built-in counters, cabinets, and divider knee walls, ceiling repair, interior improvements, and flash covered and heat welded hospital flooring

LCPA Baggage Handling/Inspection System at SWFIA



Services Provided	Negotiated General Contract
Architect	Parsons Transportation Group, Inc.
Square Footage	5,000 SF
Total Project Cost	\$701,698
Final Delivery Date	June 2015
Project Reference	Lee County Port Authority, Hector Yanez 239-590-4605
Project Description	The scope for this project included demolition and modifications to block walls, ceilings, floors, MEP, new concrete pads, drywall, metal framing, insulation, fire sealants, and acoustical ceiling.

Martin Pool Pavilion

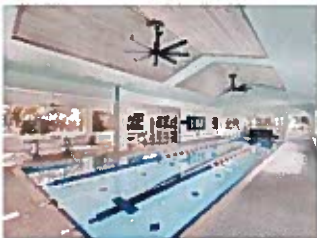

Services Provided	Construction Manager
Architect	DSDG, Inc.
Square Footage	6,500 SF
Total Project Cost	\$3,000,000
Final Delivery Date	February 2017
Project Reference	Gary Martin, Owner 941-964-2025 martingaryt@yahoo.com
Project Description	The scope of work for this addition included the installation of a Myrtha Olympic style, two lane, heated lap pool, a two lane archery/gun range was beneath the pool on the first floor, a fitness/weight room, a living room entertainment area, and a full outdoor grilling kitchen/bar with fire pit and outdoor lounging area.

TAB 3—PROJECT TEAM EXPERIENCE/REFERENCES—OTHER RELEVANT WORK

Eastern Metal Supply—Lake Worth, FL



Services Provided	Construction Manager at Risk
Architect	Studio AD
Square Footage	40,000 SF
Total Project Cost	\$2,680,000
Final Delivery Date	November 2016
Project Reference	Greg Weekes, GSG Investments South Florida, LLC 800-432-2204 gweekes@easternmetal.com
Project Description	The scope for this project included construction of a new industrial building with a super flat concrete slab flooring, interior offices, break room, training room, show room, dock bay roll up doors, and site development.

Materials Recovery Facility



Services Provided	Construction Manager at Risk under Continuing Contract
Architect	HDR, Inc.
Square Footage	25,519 SF
Total Project Cost	\$1,756,197
Final Delivery Date	October 2010
Project Reference	Lee County Government Solid Waste, Keith Howard 239-533-8917 khoward@leegov.com
Project Description	The scope for this project included construction of three pre-engineered steel structures that are used for baled storage, maintenance operations, tipping floor, and associated equipment. Also included in this project was site development, relocation of underground utilities, and construction of a by-pass road for recycling trucks.

Pocklington Facility



Services Provided	Construction Manager at Risk
Architect	William Kyle Kitchens, AIA
Square Footage	10,200 SF
Total Project Cost	\$1,200,000
Final Delivery Date	December 2007
Project Reference	William Kyle Kitchens, AIA 239-337-4224 kylekitchens@comcast.net
Project Description	The scope of work for this project included new construction of an industrial building, interior office spaces and finishes, roll-up doors, and roadway.

TAB 3—PROJECT TEM EXPERIENCE/REFERENCES—OTHER RELEVANT WORK

Westbury Industrial Building



Services Provided	Construction Manager at Risk
Architect	William Kyle Kitchens, AIA
Square Footage	17,000 SF
Total Project Cost	\$900,000
Final Delivery Date	September 2007
Project Reference	William Kyle Kitchens, AIA 239-337-4224 kylekitchens@comcast.net
Project Description	The scope for this project included tilt wall construction, sprinkler system installation, interior finishes, exterior finishes, oversized coiling doors, mechanical, electrical, and plumbing.

Direct Industrial Products



Services Provided	General Contractor
Architect	Sheeley Architects, Michael Sheeley
Square Footage	18,000 SF
Total Project Cost	\$227,000
Final Delivery Date	September 2007
Project Reference	Sheeley Architects, Michael Sheeley 239-482-2121
Project Description	The scope for this project included renovation of industrial buildings to create office space, showroom, sales area, kitchen, restrooms, warehouse space, site work, and perimeter fencing.

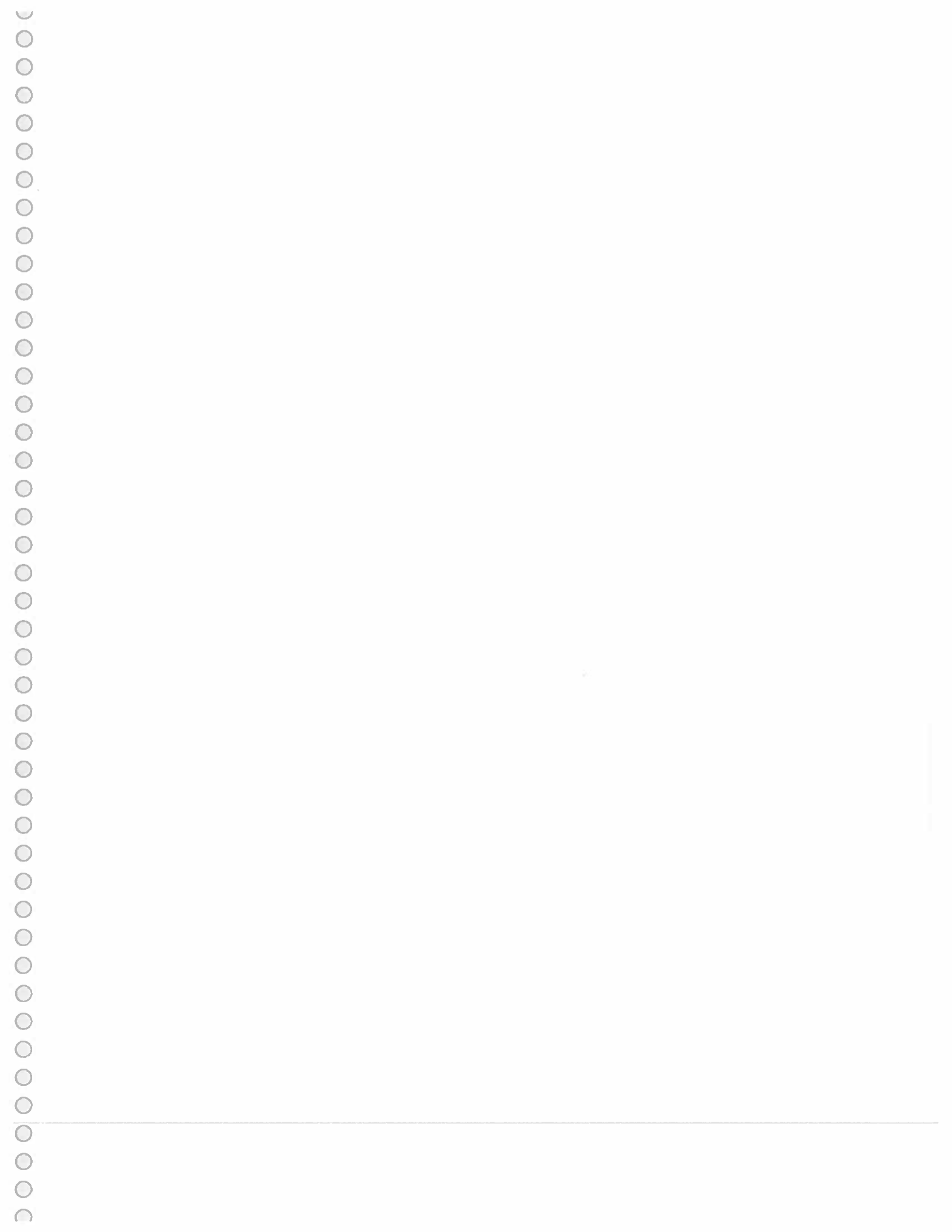

Ability to Perform

PRE CONSTRUCTION

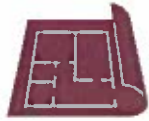

As the Construction Manager at Risk for this project, Chris-Tel Construction will provide comprehensive preconstruction management that will include constructability review, preliminary budget passes and recommendations for revisions to the design to suit the needs and activity of the City as well as the sensitivity to the overall budget proposed by the City. Preconstruction activities will also include creating a construction schedule that will enable critical path items and long lead items to be determined as well as trade activities to be scheduled in the best interest of the City as well as the City's needs. In determining the schedule and course of action for the project, bid packages and detailed scopes of work will be created enabling Chris-Tel Construction to determine a schematic budget prior to bidding as well as delivery options for the packaging of trades.

Design & Document Review

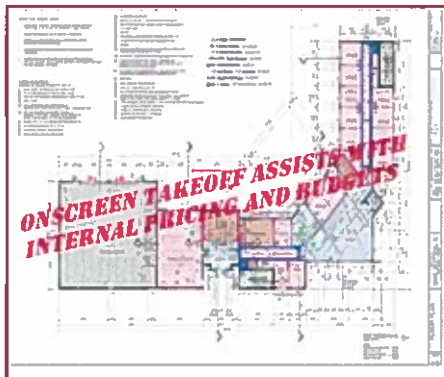

During the design phase, Chris-Tel Construction will work with the City, its agencies, the City's Owner Representative, the Design Consultant, and other parties as necessary to recommend alternatives, value engineering options and cost saving ideas to maximize the City's return on capital outlay and remain within their proposed budget.

Our preconstruction services team uses *OnScreen Takeoff* to obtain internal bid estimates prior to developing the scope of work. We are unmatched in Southwest Florida with regards to industry knowledge, subcontractor relationships, and overall cost analysis and historic data. This is imperative when reviewing the drawings for constructability, compliance and design standards. Our precon team will provide the City with sche-

matic and design development budgets at 30%, 60% and 90% drawings while continuing to attend design meetings and engage with City staff and design team members. The precon team will determine variations on constructability and how they will impact the schedule and overall performance of the building. Any alternatives and cost savings measures that are in the City's best interest will be identified and utilized to provide the City with a Guaranteed Maximum Price (GMP).

Costs Review

To farther investigate all cost options, our team will utilize our extensive database of comparable cost options so we can create historically accurate cost breakdowns for the project scope and provide real time pricing on materials to be used. This extensive review process will also enable us to evaluate the schedule and evaluate time against the labor market available during construction. Our ability to provide these cost breakdowns and accurate pricing stems from our solid foundation with the subcontractors in and around the Southwest Florida market. Our estimating staff has solid relationships and experience working with the various trades in the area which enables Chris-Tel Construction to provide fair market pricing, real time cost options and participation from local vendors, some of which are DBE Certified.



Along with the above mentioned, Chris-Tel Construction's team is experienced in green construction. While Florida code has expanded to require many green construction practices, such as low-flow plumbing, to be standard in all new construction, Chris-Tel Construction has gone above and beyond on many projects to ensure a lessened environmental impact through LEED Certified construction. Our knowledge of green construction will allow us to advise the City regarding green building materials, as well as make recommendations for building life span and efficient operations.



Once the bid packages are awarded and the GMP is finalized by the City, Notice of Commencement will be determined. Our team will have already provided the City with the permitting requirements necessary for construction to begin, thus saving time once the GMP is approved.

Coordination Technology

At the onset of construction, our Project Manager and team will arrange for a pre-construction conference to review the master schedule, scope of work, means and methods, and City requirements. This will help to establish an open line of communication for all parties involved and become a precursor for the weekly meetings conducted during construction. These weekly meetings will enable the entire construction team to be updated on safety, schedule, budget, and quality each week and will help to eliminate any unforeseen circumstances that may arise during construction.

Chris-Tel Construction will utilize **Viewpoint**, our in-house accounting software, to provide the City and its agencies, the City's Owner Representative, other Authorities Having Jurisdiction, utility companies, and other parties as necessary with a PMIS (Project Management Information Software) report describing the cost control, reporting, meeting information, inspections and all necessary back up in accordance with the project on a monthly basis. The PMIS report will also include a master construction schedule on a monthly basis for the City. This report will save time and money throughout the project and will enable a successful close out.



Bidding & Awarding

As the Construction Manager-At-Risk, our services are completely transparent and will include the City at all stages. Once the bid packages are defined and budget is determined, the bid packages will be sent out to local trade subcontractors as well as preferred vendors of the City. Chris-Tel utilizes **iSoft** software for bid solicitation as it provides a comprehensive and



organized delivery and tracking of all bid invitations, responses and notations. Once the bids are received, our staff will review them for accuracy and completeness with the City and determine the lowest, most qualified bidder for each trade package. If necessary, our team will determine any value engineering or alternative options for each trade package prior to awarding. Chris-Tel Construction will then deliver subcontractor agreements for construction to the awarded bidders. These

standard agreements will depict in specificity the scope of services required by each trade and the master schedule in which they need to be completed.

Data Housing

Utilizing **Viewpoint**, our team will have a record of all submittals and RFI's regarding the project and will house those electronically on our server at our Headquarter office located in Fort Myers. We have procedures in place to track, monitor and record all submittal information as well as pay requests, change orders, daily reporting, shop drawings, inspections, visitations, meetings, schedule and budget. Internally we will utilize **Fieldview** to house and document daily reporting, schedule, pay app information, testing results, field orders, plans and contract documentation throughout.

Safety Management

Our project team, specifically our Project Manager and Superintendent will manage job site performance and safety through constant on-site presence and weekly safety meetings. Our staff includes a dedicated compliance manager to ensure all laws and regulations are followed and administered on the jobsite. This associate responsible for onboarding all new associates and administering all training sessions for OSHA and other compliance agencies. Her responsibilities include coordinating and carrying out site visits to job sites for compliance and safety, conducting on-site training and compiling documentation for monthly reporting to owners as well as ongoing safety and insurance auditing. We also utilize **iAuditor**, which is a mobile phone application to help with OSHA site visit reporting and compliance. All of these techniques ensure compliance regulations are met and the job sites are safe.

Name	Description	Quantity	Unit	Price
1.0000	1.0000	1.0000	1.0000	1.0000
2.0000	2.0000	2.0000	2.0000	2.0000
3.0000	3.0000	3.0000	3.0000	3.0000
4.0000	4.0000	4.0000	4.0000	4.0000
5.0000	5.0000	5.0000	5.0000	5.0000
6.0000	6.0000	6.0000	6.0000	6.0000
7.0000	7.0000	7.0000	7.0000	7.0000
8.0000	8.0000	8.0000	8.0000	8.0000
9.0000	9.0000	9.0000	9.0000	9.0000
10.0000	10.0000	10.0000	10.0000	10.0000

TAB 4—ABILITY TO PERFORM & LOCATION

Location

Chris-Tel Construction is located at 2534-A Edison Avenue, Fort Myers, Florida 33901. This is the primary and only location of Chris-Tel, and is approximately 63.5 miles from the City of Venice (401 W. Venice Avenue, Venice, Florida, 34285). The fastest route would take approximately 1 hour and 13 minutes in light traffic. We pride ourselves on having a **constant Chris-Tel presence on site** at every project we pursue. While we are not a local firm to the Venice area, we can ensure that we will **always be present and available at all times** for our client.

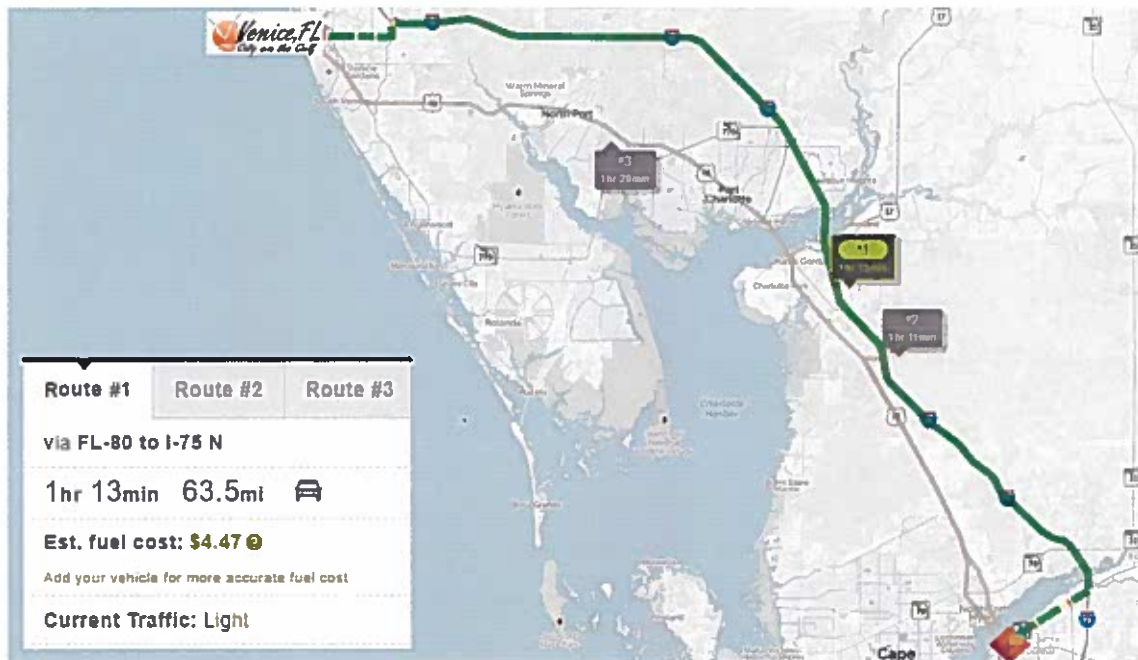

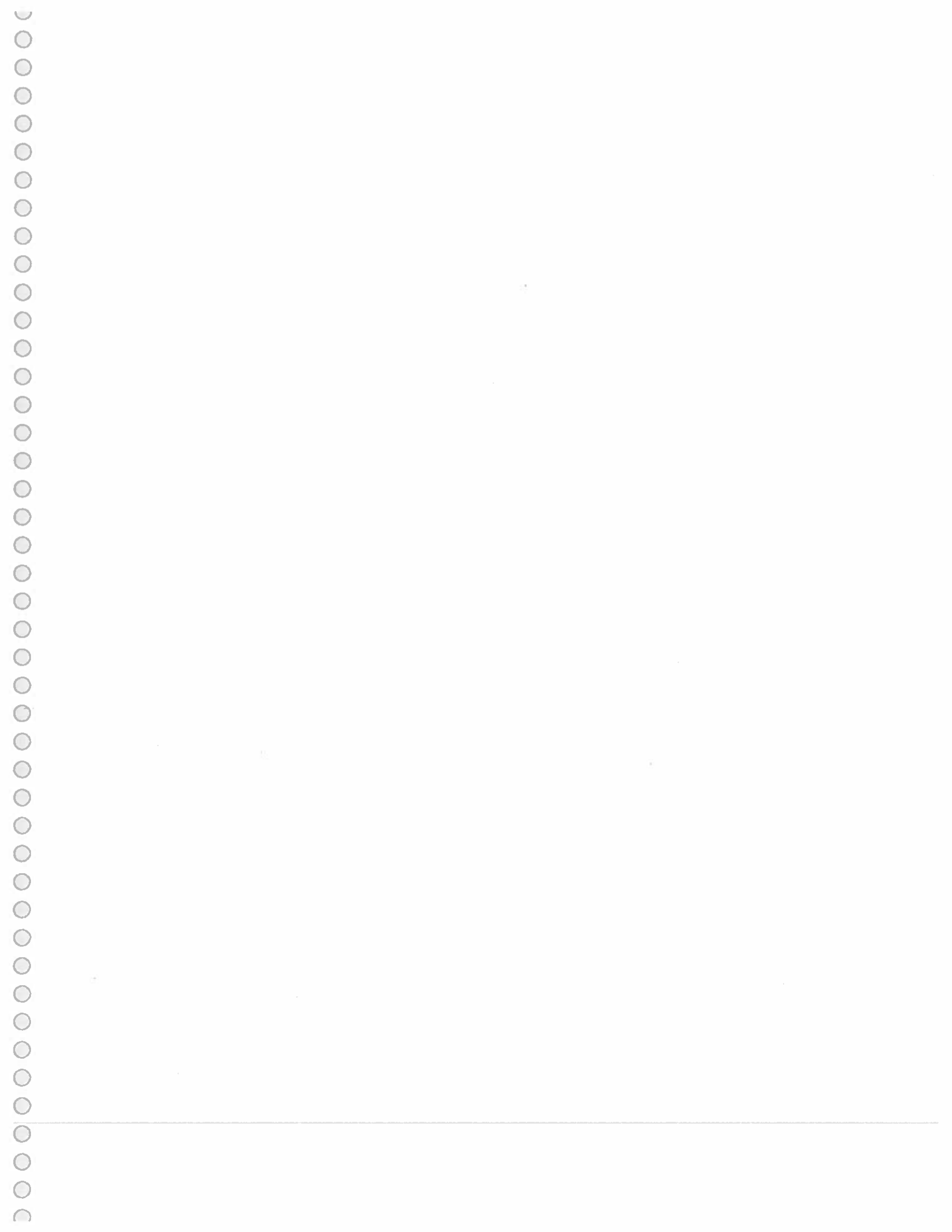

OVER \$218 MIL MUNICIPAL/GOVERNMENT

Our extensive experience in municipal and government work makes us the ideal candidate for any public project. We have done work for Lee County Government, Collier County Government, Lee County School District, Hendry County Government, City of Fort Myers, City of Cape Coral, Florida Department of Law Enforcement, Housing Authority of the City of Fort Myers, Town of Fort Myers Beach, and the Lee County Port Authority.

Our estimating staff will meet with local vendors and suppliers to walk them through the schematic budget pricing in order to receive real time, precise pricing which allows us to give a true representation of cost back to the design team. We analyze the variances to help determine whether the pricing is an accurate representation of the scope, and verify the scope is an adequate percentage of the project as a whole.

REAL TIME BUDGETING

98% OF OUR PORTFOLIO IS CMAR

We have extensive experience in the role of Construction Manager at Risk. In fact, 98% of our corporate portfolio is CMAR delivery method. This method allows us to develop a collaborative working relationship with the project's designer, and allows us to assist with value engineering, cost estimating, and constructability reviews. The initial meetings ensure that the entire project team sees eye-to-eye on all construction decisions, preventing delays during the actual construction period.

The strong and long-standing relationships we have developed with numerous subcontractors and vendors in the Southwest Florida area continues to be a key element in every project. We have worked personally with each subcontractor and vendor on various projects in the past. This experience and strong working relationship allows our firm to provide our clients with the best pricing available.

THOUSANDS OF VENDORS

OVER \$80 MIL HIGH SECURITY AREAS

Our team is seasoned in working in high security areas. Much of the municipal and government work we do requires security clearances, and we verify that everyone on the jobsite obtains proper security clearances. A considerable amount of our high security work has taken place at the Southwest Florida International Airport and at various schools in the Lee County School District and Collier County School District.

At Chris-Tel Construction, we do more than just deliver a product. We are building futures, we are restoring communities, and we are preserving our values for future generations. We strive to keep this notion at the forefront of every project we pursue so that, when the project is complete, our impact is left behind.

BUILD|RESTORE PRESERVE

OVER \$138 MIL SITE/CIVIL

Our team boasts over 150 miles of completed roadway construction and over 1 million linear feet of utility construction work. We are proficient in horizontal construction, whether it be simple ADA and PROWAG upgrades or complex center lane drainage systems to alleviate flooding. We are also well versed in site development. Our team of experts regularly advise our clients on all site development subjects, such as building placement and cost savings plans.



**SEALED REQUEST FOR QUALIFICATIONS
CITY OF VENICE, FLORIDA**

QUALIFICATIONS STATEMENT

The undersigned certifies under oath the truth and correctness of all statements and all answers to questions made hereinafter:

SUBMITTED TO:

CITY OF VENICE
Procurement- Finance Department
401 W. Venice Avenue Room # 204
Venice, Florida 34285

CHECK ONE:

- ☒ Corporation
☐ Partnership
☐ Individual
☐ Joint Venture
☐ Other

SUBMITTED BY:

NAME: Chris-Tel Company of Southwest Florida, Inc., dba Chris-Tel Construction
ADDRESS: 2534-A Edison Avenue Fort Myers, FL 33901
PRINCIPLE OFFICE: 2534-A Edison Avenue Fort Myers, FL 33901

1. State the true, exact, correct and complete legal name of the partnership, corporation, trade or fictitious name under which you do business and the address of the place of business.

The correct name of the Proposer is:

Chris-Tel Company of Southwest Florida, Inc., dba Chris-Tel Construction

The address of the principal place of business is:

2534-A Edison Avenue Fort Myers, FL 33901

2. If the Proposer is a corporation, answer the following:

- a. Date of Incorporation: January 29, 1993
- b. State of Incorporation: Florida
- c. President's Name: Howard L. Wheeler, II
- d. Vice President's Name: Donald Singleton, Robert Koenig, Julie DePiro
- e. Secretary's Name: Howard L. Wheeler, II
- f. Treasurer's Name: Howard L. Wheeler, II
- g. Name and address of Resident Agent: Howard L. Wheeler, II 2534-A Edison Avenue Fort Myers, FL 33901

3. If Proposer is an individual or partnership, answer the following:

a. Date of Organization: _____

b. Name, address and ownership units of all partners:

c. State whether general or limited partnership: _____

4. If Proposer is other than an individual, corporation, partnership, describe the organization and give the name and address of principals:

5. If Proposer is operating under fictitious name, submit evidence of compliance with the Florida Fictitious Name Statute.

6. How many years has your organization been in business under its present business name?

11

a. Under what other former names has your organization operated?

The Chris-Tel Company of Southwest Florida, Inc.

ACKNOWLEDGEMENT

Signed, sealed and delivered
in the presence of:

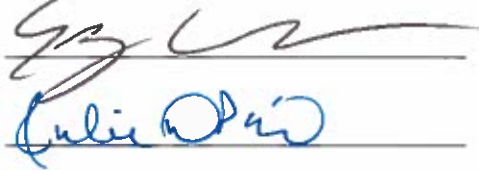

By:



Howard L. Wheeler, II
(Printed Name)

President
(Title)

State of Florida

County of Lee

SS.

On this the 2 day of March, 2018, before me, the undersigned Notary Public of the State of Florida, personally appeared Howard L. Wheeler, II, President and (Names of individual(s) who appeared before Notary) whose name(s) in/are Subscribed to within instrument, and he/she/they acknowledge that he/she/they executed it.

NOTARY PUBLIC
SEAL OF OFFICE

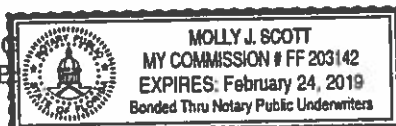

NOTARY PUBLIC, STATE OF FLORIDA

Molly J Scott
(Name of Notary Public: Print, stamp, or type as commissioned)

☒ Personally known to me, or ☐ Produced Identification: _____ ☐ DID take an oath, or ☒ DID NOT take an oath

"LOCAL PREFERENCE" DETERMINATION

The following questions will help you determine local preference for your company.

Please answer questions 1 through 4 **FIRST**. If you answer **NO** to any questions 1 through 4, local preference does **NOT** apply.

ONLY if you answer **YES** to questions 1 through 4, may you proceed to question 5.

If you answer **YES** to any questions 5 and 6, local preference applies.

If you are unsure of how to answer any questions, please contact the City of Venice's Purchasing Department at 941-486-2626.

Questions 1 – 4

1. Has your company paid a local business tax either to Sarasota, DeSoto or Charlotte County (Manatee County does not currently have a local business tax) authorizing your company to provide goods or services described in this solicitation?

YES ☐ If "yes", proceed to question 2.

NO ☒ If "no", **STOP, local preference does not apply.**

* If the name on the local business tax receipt is not the same as the name on the bid/solicitation submittal, local preference does not apply.

2. Does your company maintain a permanent physical business address located within the limits of Sarasota, Manatee, DeSoto or Charlotte County from which your company operates or performs business?

YES ☐ If "yes", proceed to question 3.

NO ☐ If "no", **STOP, local preference does not apply.**

3. Does your company's local business office (identified in question 2) have a least one full time employee?

YES ☐ If "yes", proceed to question 4.

NO ☐ If "no", **STOP, local preference does not apply.**

4. Do at least fifty percent (50%) of your company's employees who are based in the local business location (identified in question 2) reside within Sarasota, Manatee, DeSoto or Charlotte County?

YES ☐ If "yes", proceed to question 5.

NO ☐ If "no", **STOP, local preference does not apply.**

Questions 5 – 6

5. Is your company's local business office (identified in question 2) the primary location (headquarters) of your company?

YES ____ If "yes", STOP, local preference applies.

NO ____ If "no", proceed to question 6.

6. If the local business office (identified in question 2) is not the primary location of your company, are at least ten percent (10%) of your company's entire full-time employees based at the local office location AND does at least one corporate officer, managing partner or principal owner of your company reside in Sarasota, Manatee, DeSoto or Charlotte County?

YES ____ If "yes", STOP, local preference applies.

NO ____ If "no", local preference does not apply.

PROJECT TEAM

TEAM NAME: Chris-Tel Company of Southwest Florida, Inc., dba Chris-Tel Construction

FEDERAL ID No.: 65-0384539

Prime Role	Name & City of Residence of Individual Assigned to the Project	No. of Years Experience	Education, Degree(s)	Florida Active Registration Nos.
Principle-in- Charge/Project Executive	Howard L. Wheeler, II, Principle-in-Charge (Fort Myers, FL)	31	Virginia Polytechnic Institute and State University, BS Building Construction	CGC 038604
	Bob Koenig, Project Executive (North Fort Myers, FL)	39		
Project Manager	Sean Smiley, Project Manager (Fort Myers, FL)	15	University of North Florida, Jacksonville, BS Building Construction Management	
Project Engineer	Mike Kays, Quality Control Specialist/ Superintendent (Lake Placid, FL)	14		
Superintendent	George Pisello, Superintendent (Estero, FL)	15		
Scheduler	Sean Smiley, Project Manager (Fort Myers, FL)	15	University of North Florida, Jacksonville, BS Building Construction Management	
Other Key Member	Joe Pressler, Manager of Preconstruction and Estimating (Fort Myers, FL)	35	Purdue University, BS Building Construction	
	Rachel Comerford, Assistant Project Manager (North Fort Myers, FL)	1		
	Andrea Cames, Accounts Payable (North Fort Myers, FL)	8		
	Alba Gonzalez, Compliance/Safety (Cape Coral, FL)	20		

THIS PAGE MUST BE COMPLETED & SUBMITTED WITH OFFER

PUBLIC ENTITY CRIME INFORMATION

A person or affiliate who has been placed on the State of Florida's convicted vendor list following a conviction for a public entity crime may not submit an RFQ proposal on a contract to provide any goods or services to a public entity, may not submit a response on a contract with a public entity for services in the construction or repair of a public building or public work, may not submit bids on leases of real property to a public entity, may not be awarded or perform work as a Contractor, supplier, Sub-Contractor, or Contractor under a contract with any public entity, and may not transact business with any public entity in excess of the threshold amount provided in **Section 2876.017, for CATEGORY TWO for a period of 36 months from the date of being placed on the convicted vendor list.**

I, Howard L. Wheeler, II, being an authorized representative of the firm of
Chris-Tel Company of Southwest Florida, Inc.,
dba Chris-Tel Construction, located at City: Fort Myers State:
Florida Zip: 33966, have read and understand the contents of the Public

Entity Crime Information and of this formal RFQ package, hereby submit our proposal accordingly.

Signature: _____



Date: 03/02/18

Phone: _____

239-226-0500

Fax: _____

239-226-0503

Federal ID#: _____

65-0384539

DRUG FREE WORKPLACE

Preference shall be given to business with drug-free workplace programs. Whenever two or more RFQs, which are equal with qualifications and service, are received by the City for the procurement of commodities or contractual services, an RFQ received from a business that certifies that it has implemented a drug-free workplace program shall be given preference in the award process. In order to have a drug-free workplace program, your firm shall:

1. Publish a statement notifying employees that the unlawful manufacture, distribution, dispensing, possession, or use of a controlled substance is prohibited in the workplace and specifying the action that will be taken against employees for violations of such prohibition.
2. Inform employees about the dangers of drug abuse in the workplace, the business's policy of maintaining a drug-free workplace, any programs, and the penalties that may be imposed upon employees for drug abuse violations.
3. Give each employee engaged in providing the commodities or contractual services that are under an RFQ, a copy of the statement specified in subsection (1).
4. In the statement specified in subsection (1), notify the employees that as a condition of working on the commodities or contractual services that are under RFQ, the employee will abide by the terms of the statement and will notify the employer of any conviction of, or plea of the United States or any state, for a violation occurring in the workplace no later than five (5) days after such conviction.
5. Impose a sanction on, or require the satisfactory participation in a drug abuse assistance or rehabilitation program if such is available in the employee's community, by an employee who is so convicted.
6. Make a good faith effort to continue to maintain a drug-free workplace through implementation of this section.

As the person authorized to sign the statement, I certify that this firm complies fully with the above requirements.

Concur _____ ✓

03/02/18
Date

Variance _____

Contractor's Signature

CONFLICT/NON CONFLICT OF INTEREST AND LITIGATION STATEMENT

CHECK ONE



To the best of our knowledge, the undersigned firm has no potential conflicts of interest due to any other clients, contracts, or property interest for this project.

OR



The undersigned firm, by attachment to this form, submits information which may be a potential conflict of interest due to other clients, contracts, or property interest for this project.

LITIGATION STATEMENT

IN FLORIDA ONLY, JUDGMENTS AGAINST THE FIRM, AND SUITS AGAINST CITY OF VENICE. INCLUDE ACTIONS AGAINST THE FIRM BY OR AGAINST ANY LOCAL, STATE, OR FEDERAL REGULATORY AGENCY.

CHECK ONE



The undersigned firm has had no litigation adjudicated against the firm on any projects in the last five (5) years and has filed no litigation against City of Venice in the last five (5) years.

OR



The undersigned firm, BY ATTACHMENT TO THIS FORM, submits a summary and disposition of individual cases of litigation in Florida adjudicated against the firm during the past five (5) years; all legal actions against City of Venice during the past five (5) years; and actions by or against any Federal, State and local agency during the past five (5) years.

Company Name: Chris-Tel Company of Southwest Florida, Inc. dba Chris-Tel Construction

Authorized Signature: _____



Name (print or type): Howard L. Wheeler, II

Title: President

Failure to check the appropriate blocks above may result in disqualification of your proposal. Failure to provide documentation of a possible conflict of interest, or a summary of past litigation, may result in disqualification of your proposal. Should additional information regarding the above items come to the attention of City of Venice after award, the awarded contract shall be subject to immediate termination.

TAB 6—REQUIRED FORMS LITIGATION STATEMENT: SUMMARY AND LITIGATION OF INDIVIDUAL CASE

Lawsuits associated with Chris-Tel Company of Southwest Florida, Inc., dba Chris-Tel Construction for past five (5) years:

- Case # 16-CA-003-059, Lee County Clerk of Court

Plaintiff: Resident living near Landings at East Pointe, Fort Myers, Florida

Defendant: Housing Authority of the City of Fort Myers, Pinnacle Housing Group, LLC, Sabal Palm Preservation and Chris-Tel Company of Southwest Florida, Inc., dba Chris-Tel Construction.

Synopsis: The Housing Authority of Fort Myers installed piping on a Right of Way Easement near Sabal Palm Apartments.

The Plaintiff assumed it was on his property, not the right-of- way. Chris-Tel being the contractor working for the Housing Authority and installing the piping was named in the lawsuit as well as other team members of the project.

Case Status: Filed 9/8/17—litigation pending review

NON-COLLUSION AFFIDAVIT

State of Florida

County of Lee

SS.

Howard L. Wheeler, II

being first duly sworn, deposes and says that:

1. He/she is the Owner, (Owner, Partner, Officer, Representative or Agent) of Chris-Tel Company of Southwest Florida, Inc., the Proposer that has submitted the attached Proposal;
dba Chris-Tel Construction
2. He/she is fully informed respecting the preparation and contents of the attached Proposal and of all pertinent circumstances respecting such Proposal;
3. Such Proposal is genuine and is not a collusive or sham Proposal;
4. Neither the said Proposer nor any of its officers, partners, owners, agents, representatives, employees or parties in interest, including this affiant, have in any way colluded, conspired, connived or agreed, directly or indirectly, with any other Proposer, firm, or person to submit a collusive or sham Proposal in connection with the Work for which the attached Proposal has been submitted; or have in any manner, directly or indirectly sought by agreement or collusion, or have in any manner, directly or indirectly, sought by agreement or collusion, or communication or conference with any Proposer, firm, or person to fix the price or prices in the attached Proposal or of any other Proposer, or to fix any overhead, profit, or cost elements of the Proposal price or the Proposal price of any other Proposer, or to secure through any collusion, conspiracy, connivance, or unlawful agreement any advantage against (Recipient), or any person interested in the proposal Work.

Signed, sealed and delivered
in the presence of:

[Signature]
Julie Orr

By:

Howard L. Wheeler, II
(Printed Name)

President
(Title)

ACKNOWLEDGEMENT

State of Florida

County of Lee

On this the 2 day of March, 2018, before me, the undersigned Notary Public of the State of Florida, personally appeared Howard L. Wheeler, II, President and (Names of individual(s) who appeared before Notary) whose name(s) in/are subscribed to within instrument, and he/she/they acknowledge that he/she/they executed it.

NOTARY PUBLIC
SEAL OF OFFICE:

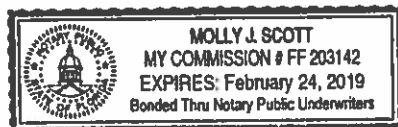

[Signature]
NOTARY PUBLIC, STATE OF FLORIDA

Molly J Scott

(Name of Notary Public: Print, stamp, or type as commissioned)

☒ Personally known to me, or ☐ Produced Identification: _____ ☐ DID take an oath, or ☒ DID NOT take an oath

REVISION:

A revised PROJECT TEAM form is attached to this addendum and must be included with your submittal.

Peter A. Boers
Procurement Department

Acknowledgment is requested even if you have elected not to respond to this bid. A designated management representative of your firm can sign the receipt for this addendum. Please acknowledge receipt of this addendum immediately by fax to (941) 486- 2790 or mail to the above noted address, if a fax is not possible.

Receipt Acknowledged:



Signature

Chris-Tel Company of Southwest Florida, Inc., dba Chris-Tel Construction
Company

02/23/18
Date

A copy of this addendum (excluding attachments) is to be included with the proposal response.



CERTIFICATE OF LIABILITY INSURANCE

DATE (MM/DD/YYYY)
2/19/2018

THIS CERTIFICATE IS ISSUED AS A MATTER OF INFORMATION ONLY AND CONFERS NO RIGHTS UPON THE CERTIFICATE HOLDER. THIS CERTIFICATE DOES NOT AFFIRMATIVELY OR NEGATIVELY AMEND, EXTEND OR ALTER THE COVERAGE AFFORDED BY THE POLICIES BELOW. THIS CERTIFICATE OF INSURANCE DOES NOT CONSTITUTE A CONTRACT BETWEEN THE ISSUING INSURER(S), AUTHORIZED REPRESENTATIVE OR PRODUCER, AND THE CERTIFICATE HOLDER.

IMPORTANT: If the certificate holder is an ADDITIONAL INSURED, the policy(ies) must be endorsed. If SUBROGATION IS WAIVED, subject to the terms and conditions of the policy, certain policies may require an endorsement. A statement on this certificate does not confer rights to the certificate holder in lieu of such endorsement(s).

PRODUCER Olin Hill & Associates Inc. 2804 Del Prado Blvd #107 Cape Coral FL 33904	CONTACT NAME: David Kennedy PHONE (A/C, H/O, Ext): 239-945-1900 FAX (A/C, H/O): 239-945-3163 E-MAIL ADDRESS:														
INSURED Chris-Tel Company of Southwest Florida Inc dba Chris-Tel Construction; Chris-Tel Energy Inc 2534-A Edison Avenue Ft Myers FL 33901	<table border="1"> <thead> <tr> <th>INSURER(S) AFFORDING COVERAGE</th> <th>NAIC #</th> </tr> </thead> <tbody> <tr> <td>INSURER A : Southern-Owners Insurance Co.</td> <td>10190</td> </tr> <tr> <td>INSURER B : Owners Insurance Company</td> <td>32700</td> </tr> <tr> <td>INSURER C : American Builders Insurance Co</td> <td>11240</td> </tr> <tr> <td>INSURER D :</td> <td></td> </tr> <tr> <td>INSURER E :</td> <td></td> </tr> <tr> <td>INSURER F :</td> <td></td> </tr> </tbody> </table>	INSURER(S) AFFORDING COVERAGE	NAIC #	INSURER A : Southern-Owners Insurance Co.	10190	INSURER B : Owners Insurance Company	32700	INSURER C : American Builders Insurance Co	11240	INSURER D :		INSURER E :		INSURER F :	
INSURER(S) AFFORDING COVERAGE	NAIC #														
INSURER A : Southern-Owners Insurance Co.	10190														
INSURER B : Owners Insurance Company	32700														
INSURER C : American Builders Insurance Co	11240														
INSURER D :															
INSURER E :															
INSURER F :															

COVERAGES **CERTIFICATE NUMBER: 1176961148** **REVISION NUMBER:**

THIS IS TO CERTIFY THAT THE POLICIES OF INSURANCE LISTED BELOW HAVE BEEN ISSUED TO THE INSURED NAMED ABOVE FOR THE POLICY PERIOD INDICATED. NOTWITHSTANDING ANY REQUIREMENT, TERM OR CONDITION OF ANY CONTRACT OR OTHER DOCUMENT WITH RESPECT TO WHICH THIS CERTIFICATE MAY BE ISSUED OR MAY PERTAIN, THE INSURANCE AFFORDED BY THE POLICIES DESCRIBED HEREIN IS SUBJECT TO ALL THE TERMS, EXCLUSIONS AND CONDITIONS OF SUCH POLICIES. LIMITS SHOWN MAY HAVE BEEN REDUCED BY PAID CLAIMS.

WORK LTR	TYPE OF INSURANCE	ACORD (SUBR) (BND) (WVS)	POLICY NUMBER	POLICY EFF (MM/DD/YYYY)	POLICY EXP (MM/DD/YYYY)	LIMITS
A	<input checked="" type="checkbox"/> COMMERCIAL GENERAL LIABILITY <input type="checkbox"/> CLAIMS-MADE <input checked="" type="checkbox"/> OCCUR <input checked="" type="checkbox"/> Contractual Liable <input checked="" type="checkbox"/> XCU GEN'L AGGREGATE LIMIT APPLIES PER: <input type="checkbox"/> POLICY <input checked="" type="checkbox"/> PER-ACCIDENT <input type="checkbox"/> LOC <input type="checkbox"/> OTHER:		20185404	5/1/2017	5/1/2018	EACH OCCURRENCE \$ 1,000,000 DAMAGE TO RENTED PREMISES (Ea occurrence) \$ 50,000 MED EXP (Any one person) \$ 5,000 PERSONAL & ADV INJURY \$ 1,000,000 GENERAL AGGREGATE \$ 2,000,000 PRODUCTS - COMP/OP AGG \$ 2,000,000 \$
B	AUTOMOBILE LIABILITY <input checked="" type="checkbox"/> ANY AUTO <input checked="" type="checkbox"/> ALL OWNED AUTOS <input type="checkbox"/> SCHEDULED AUTOS <input checked="" type="checkbox"/> HIRED AUTOS <input checked="" type="checkbox"/> NON-OWNED AUTOS		5003768800	5/1/2017	5/1/2018	COMBINED SINGLE LIMIT (Ea accident) \$ 1,000,000 BODILY INJURY (Per person) \$ BODILY INJURY (Per accident) \$ PROPERTY DAMAGE (Per accident) \$ \$
A	<input checked="" type="checkbox"/> UMBRELLA LIAB <input checked="" type="checkbox"/> OCCUR <input type="checkbox"/> EXCESS LIAB <input type="checkbox"/> CLAIMS-MADE <input type="checkbox"/> DED <input checked="" type="checkbox"/> RETENTION \$		5003768801	5/1/2017	5/1/2018	EACH OCCURRENCE \$ 5,000,000 AGGREGATE \$ \$
C	WORKERS COMPENSATION AND EMPLOYERS' LIABILITY ANY PROPRIETOR/PARTNER/EXECUTIVE OFFICER/OWNER EXCLUDED? (Mandatory in FL) If yes, describe under DESCRIPTION OF OPERATIONS below	Y/N N	WCV022548001	10/1/2017	10/1/2018	<input type="checkbox"/> PER STATUTE <input type="checkbox"/> OTHER E.L. EACH ACCIDENT \$ 1,000,000 E.L. DISEASE - EA EMPLOYEE \$ 1,000,000 E.L. DISEASE - POLICY LIMIT \$ 1,000,000

DESCRIPTION OF OPERATIONS / LOCATIONS / VEHICLES (ACORD 101, Additional Remarks Schedule, may be attached if more space is required)
 Re: RFQ # 3079-18
 The City of Venice, its Elected Officials, Officers, Agents and Employees are named as Additional Insureds on the General Liability and Business Auto with respect to Insured's operations. A Waiver of Subrogation applies in favor of the same. General Liability, Auto and Umbrella contain a 30 day notice of cancellation except for 10 days for non-payment of premium.

CERTIFICATE HOLDER The City of Venice 401 W. Venice Avenue Venice FL 34285	CANCELLATION SHOULD ANY OF THE ABOVE DESCRIBED POLICIES BE CANCELLED BEFORE THE EXPIRATION DATE THEREOF, NOTICE WILL BE DELIVERED IN ACCORDANCE WITH THE POLICY PROVISIONS. _____ Signature
--	---



INSOURCE PARTNERS LLC
Insurance and Surety Services

September 18, 2017

School District of Lee County
Procurement Services Department
Attn: Tracey Adams, Procurement Coordinator
2855 Colonial Blvd.
Fort Myers, FL 33966

Dear Ms. Adams:

The purpose of this letter is to advise you of the surety bond capacity and reputation of Chris-Tel Company of Southwest Florida, Inc.

We write surety bonds for Chris-Tel Company of Southwest Florida, Inc. through Berkley Insurance Company, 475 Steamboat Road, Greenwich, CT 06830, and extend to them a surety line in excess of \$50,000,000.00 per single project and \$100,000,000.00 aggregate work program. Berkley Insurance Company is licensed to do business in all states and has an A.M. Best Rating of "A+" with a financial size of Class "XV". Berkley Insurance Company's Treasury Listing is \$455,938,000.00.

Chris-Tel Company of Southwest Florida, Inc. is a professionally managed organization with an excellent reputation. They have an experienced organization and are well financed. I recommend Chris-Tel Company of Southwest Florida, Inc. to you without reservation.

Upon the request of Chris-Tel Company of Southwest Florida, Inc., we will be pleased to execute Performance and Payment Bonds, subject to normal underwriting requirements. This letter is not an assumption of liability, nor is it a bid or performance bond. The Surety reserves the right to review the file and contract terms and conditions for acceptance prior to the authorization or execution of any performance and payment bond.

Sincerely,

Anthony T. Papa, Jr.
President

ATP/cm

7264 Kyle Court, Sarasota, FL 34240 Main 941.999.1900 Fax 941.306.2002 www.ip-fl.com

TAB 6—REQUIRED FORMS CERTIFICATIONS: CONTRACTOR LICENSE



**STATE OF FLORIDA
DEPARTMENT OF BUSINESS AND PROFESSIONAL REGULATION**

**CONSTRUCTION INDUSTRY LICENSING BOARD
2601 BLAIR STONE ROAD
TALLAHASSEE FL 32399-0783**

(850) 487-1395

**WHEELER, HOWARD LLOYD II
CHRIS-TEL CONSTRUCTION
2534 EDISON AVENUE #A
FORT MYERS FL 33901**

Congratulations! With this license you become one of the nearly one million Floridians licensed by the Department of Business and Professional Regulation. Our professionals and businesses range from architects to yacht brokers, from boxers to barbeque restaurants, and they keep Florida's economy strong.

Every day we work to improve the way we do business in order to serve you better. For information about our services, please log onto www.myfloridalicense.com. There you can find more information about our divisions and the regulations that impact you, subscribe to department newsletters and learn more about the Department's initiatives.

Our mission at the Department is: License Efficiently, Regulate Fairly. We constantly strive to serve you better so that you can serve your customers. Thank you for doing business in Florida, and congratulations on your new license!



**STATE OF FLORIDA
DEPARTMENT OF BUSINESS AND
PROFESSIONAL REGULATION**

CGC038604 ISSUED: 07/10/2016

**CERTIFIED GENERAL CONTRACTOR
WHEELER, HOWARD LLOYD II
CHRIS-TEL CONSTRUCTION**

**IS CERTIFIED under the provisions of Ch. 489 FS
Expiration date: AUG 31, 2018 L1607100001632**

DETACH HERE

RICK SCOTT, GOVERNOR

KEN LAWSON, SECRETARY

**STATE OF FLORIDA
DEPARTMENT OF BUSINESS AND PROFESSIONAL REGULATION
CONSTRUCTION INDUSTRY LICENSING BOARD**

LICENSE NUMBER	
CGC038604	

**The GENERAL CONTRACTOR
Named below IS CERTIFIED
Under the provisions of Chapter 489 FS.
Expiration date: AUG 31, 2018**

**WHEELER, HOWARD LLOYD II
CHRIS-TEL CONSTRUCTION
2534 EDISON AVENUE #A
FORT MYERS FL 33901**



ISSUED: 07/10/2016

DISPLAY AS REQUIRED BY LAW

SEQ # L1607100001632



Florida Department of Transportation

RICK SCOTT
GOVERNOR

605 Suwannee Street
Tallahassee, FL 32399-0450

RACHEL D. CONE
INTERIM SECRETARY

June 1, 2017

CHRIS-TEL CONSTRUCTION
2534-A EDISON AVE
FORT MYERS FL 33901

RE: CERTIFICATE OF QUALIFICATION

Dear Sir/Madam:

The Department of Transportation has qualified your company for the type of work indicated below. Unless your company is notified otherwise, this Certificate of Qualification will expire 6/30/2018. However, the new application is due 4/30/2018.

In accordance with S.337.14 (1) F.S. your next application must be filed within (4) months of the ending date of the applicant's audited annual financial statements.

If your company's maximum capacity has been revised, you can access it by logging into the Contractor Prequalification Application System via the following link:
[HTTPS://fdotwpl.dot.state.fl.us/ContractorPreQualification/](https://fdotwpl.dot.state.fl.us/ContractorPreQualification/)

Once logged in, select "View" for the most recently approved application, and then click the "Manage" and "Application Summary" tabs.

FDOT APPROVED WORK CLASSES:
DRAINAGE, GRADING

You may apply for a Revised Certificate of Qualification at any time prior to the expiration date of this certificate according to Section 14-22.0041(3), Florida Administrative Code (F.A.C.), by accessing your most recently approved application as shown above and choosing "Update" instead of "View." If certification in additional classes of work is desired, documentation is needed to show that your company has done such work with your own forces and equipment or that experience was gained with another contractor and that you have the necessary equipment for each additional class of work requested.

All prequalified contractors are required by Section 14-22.006(3), F.A.C., to certify their work underway monthly in order to adjust maximum bidding capacity to available bidding capacity. You can find the link to this report at the website shown above.

Sincerely,

Alan Astry, Manager
Contracts Administration Office

AA:cj

www.fdot.gov

FLORIDA DEPARTMENT OF STATE

DIVISION OF CORPORATIONS





[Home](#)
[Contact Us](#)
[E-Filing Services](#)
[Document Searches](#)
[Forms](#)
[Help](#)

[Previous on List](#)
[Next on List](#)
[Return to List](#)

[Filing History](#)

Fictitious Name Search

Submit

Fictitious Name Detail

Fictitious Name

CHRIS-TEL CONSTRUCTION

Filing Information

Registration Number G07107900413
Status ACTIVE
Filed Date 04/17/2007
Expiration Date 12/31/2017
Current Owners 1
County LEE
Total Pages 2
Events Filed 1
FEI/EIN Number 65-0384539

Mailing Address

2534-A EDISON AVENUE
FORT MYERS, FL 33901

Owner Information

CHRIS-TEL COMPANY OF SOUTHWEST FLORIDA, INC.
2534-A EDISON AVENUE
FORT MYERS, FL 33901
FEI/EIN Number: 65-0384539
Document Number: P93000007246

Document Images

[04/17/2007 -- Fictitious Name Filing](#)

View image in PDF format

[12/13/2012 -- Fictitious Name Renewal Filing](#)

View image in PDF format

[Previous on List](#)
[Next on List](#)
[Return to List](#)

[Filing History](#)

Fictitious Name Search

Submit

[Home](#) | [Contact us](#) | [Document Searches](#) | [E-Filing Services](#) | [Forms](#) | [Help](#) |

[Copyright © and Privacy Policies](#)
State of Florida, Department of State