

PROJECT NOTES:

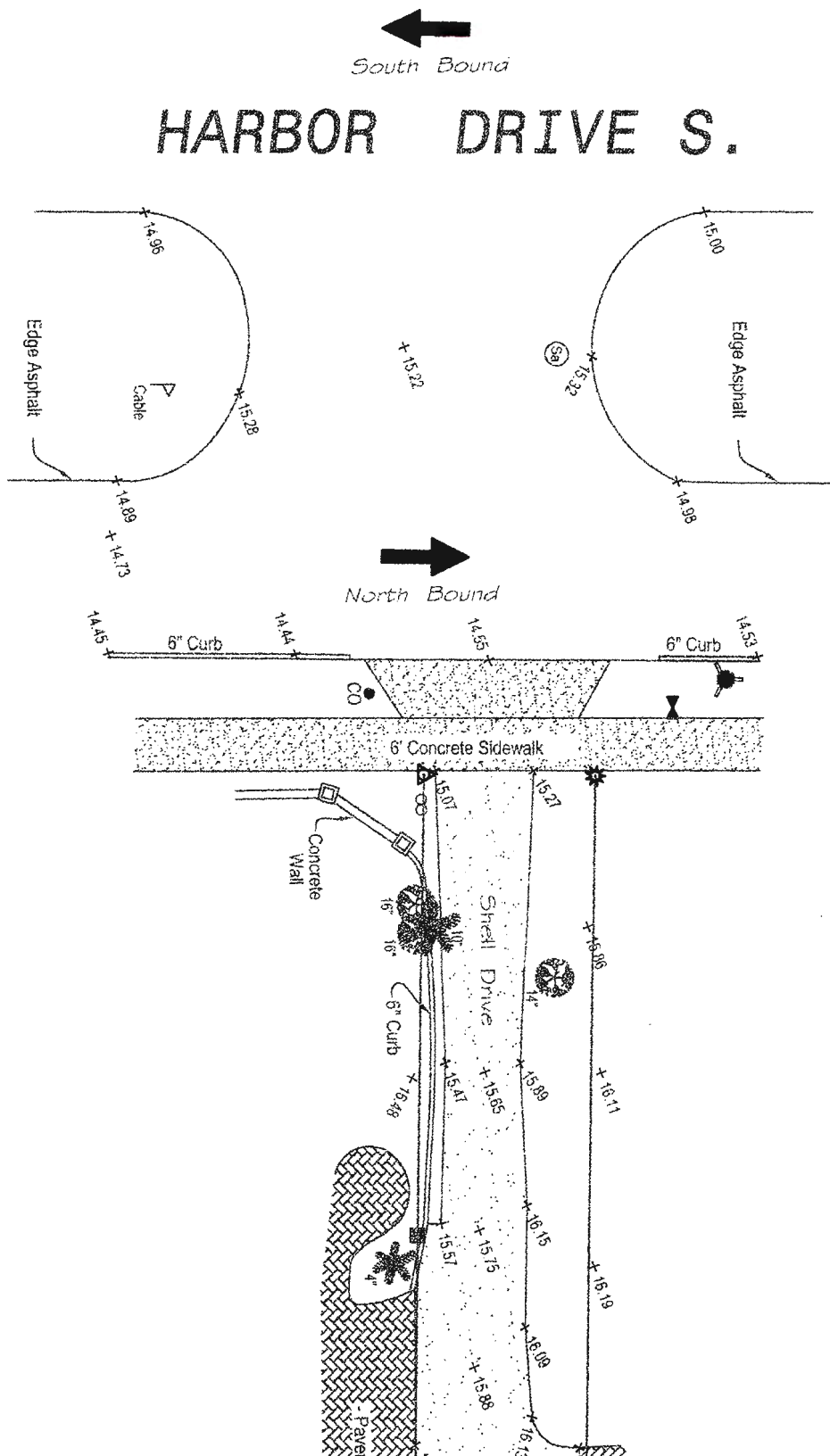

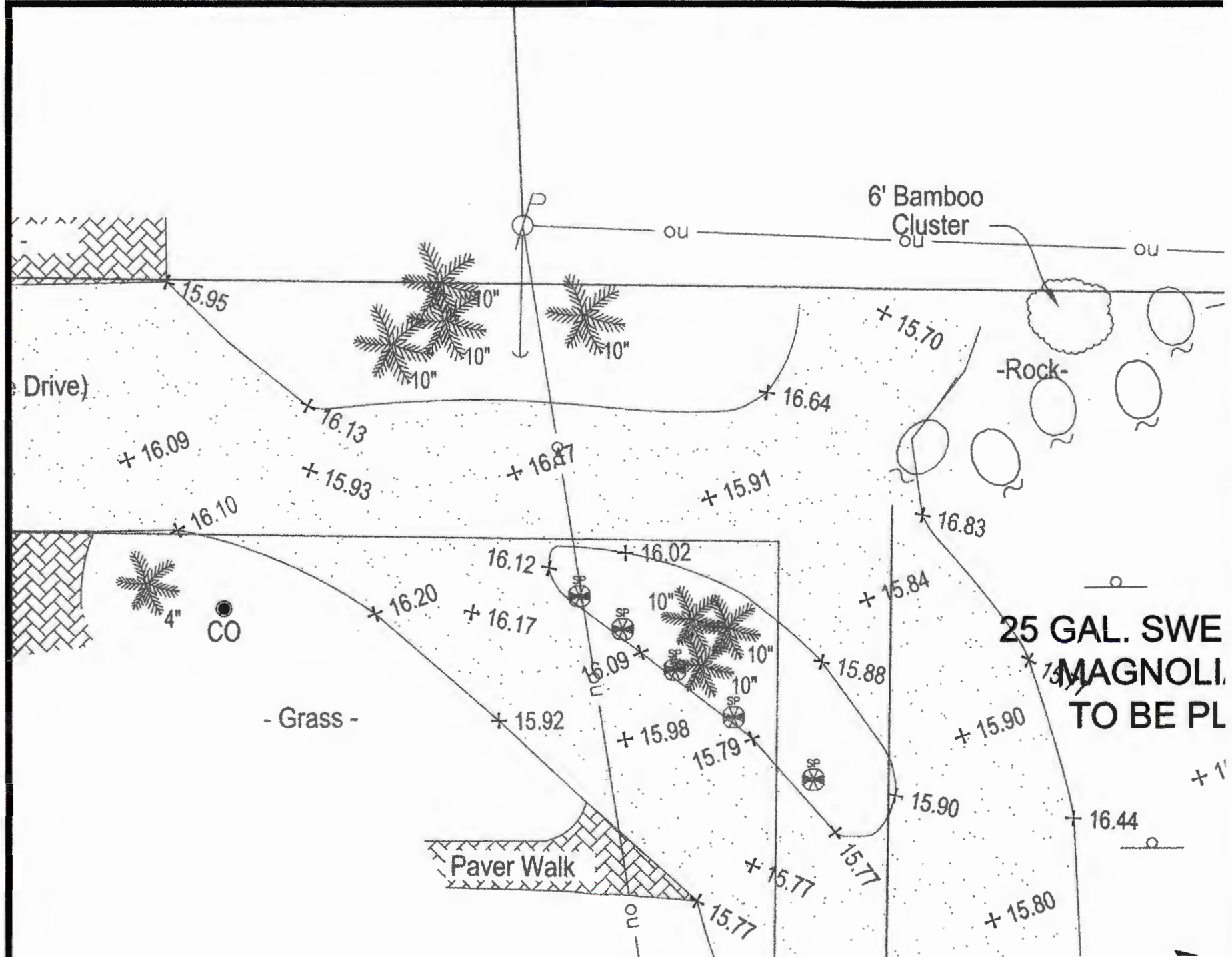

UTILITY NOTIFICATION

UTILITY LOCATIONS DEPICTED WITHIN THIS CONSTRUCTION PLAN SET HAVE BEEN COMPILED FROM FIELD SURVEYS AND DOCUMENTS SUPPLIED BY THE VARIOUS UTILITY COMPANIES. THE ENGINEER MAKES NO CLAIM TO THE ACCURACY OF THE UTILITY LOCATIONS SHOWN ON THESE PLANS. THE CONTRACTOR SHALL NOTIFY ALL UTILITIES AND IS RESPONSIBLE FOR VERIFYING THE DEPTHS AND FIELD LOCATIONS OF ALL KNOWN AND UNKNOWN EXISTING UTILITIES PRIOR TO COMMENCEMENT OF CONSTRUCTION. ACTUAL UTILITY LOCATIONS AND DEPTHS MAY VARY FROM THOSE DEPICTED WITHIN THIS CONSTRUCTION PLAN SET. PROTECTION OF ALL UTILITIES WITHIN THE AREA OF CONSTRUCTION AND ALL COSTS TO REMEDY DAMAGES TO EXISTING UTILITIES AND DISTURBED AREAS SHALL BE BORNE BY THE CONTRACTOR.



**KNOW WHAT'S BELOW
ALWAYS CALL 811
BEFORE YOU DIG**

It's fast, It's free, It's the law.

www.callsunshine.com

LEGEND:

x

EXISTING ELEVATION ON SURVEY
(BY OTHERS)



PROPOSED SPOT ELEVATION
(M.E. = MATCH EXISTING)



PROPOSED DRAINAGE FLOW



SHELL ROADWAY EXTENDED INTO
THESE AREAS.

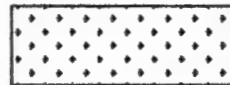

EXISTING ROADWAY TO BE REMOVED
AREA TO BE SODDED WITH BAHIA.



AMERICAN BEAUTY BERRY
PLANTING AREA
(SEE RAIN GARDEN NOTES SHEET 2)



SAND CORDGRASS
PLANTING AREA
(SEE RAIN GARDEN NOTES SHEET 2)



SIDEWALK SECTION TO BE REPLACED

PIPE NOTES:

1. ALL PIPE SHALL BE 12" C900.
2. ALL PIPES SHALL BE PLACED AT THE LOCATIONS AND INVERTS SHOWN ON THE PLANS; ACCORDING TO VENICE STANDARDS..
3. WHERE THE PIPE EXTENDS UNDER THE SIDEWALK ALONG PONCE DE LEON AVENUE, SIDEWALK SHALL BE REMOVED, AND REPLACED; OR REMOVED AT EXISTING JOINTS AND REPLACED.

STRUCTURE AND FITTING NOTES: