

Features

- 1600 Wall System®1 is an outside glazed captured curtain wall
- 1600 Wall System®1 has a 2-1/2" (63.5) sightline
- Standard 6" (152.4) or 7-1/2" (190.5) depth systems
- Standard infill options 1/4" (6.4) and 1" (25.4), other infills available
- Thermally Broken by means of a continuous 1/4" (6.4) low conductance spacer
- Concealed fastener joinery creates smooth, monolithic appearance
- Open-back horizontals and perimeters are available for cost savings
- Shear block fabrication method
- Corners and splayed mullions
- Offers integrated entrance framing systems
- Silicone compatible glazing materials for long-lasting seals
- 1600 Wall System®1 has been small and large missile impact and cycle tested
- Two color option
- Permanodic® anodized finishes in seven choices
- Painted finishes in standard and custom choices

Optional Features

- Steel reinforcing
- Rain screen and backpans
- Optional deep profile and bull nose covers
- Deep and heavy-weight mullions
- Fiberglass pressure plates
- Veneer system
- Integrates with standard Kawneer windows and GLASSvent® windows for curtain wall
- Integrates with Versoleil® Sunshade Outrigger System and Horizontal or Vertical Single Blade System
- Integrates with 1600 PowerShade®
- Profit\$Maker® Plus die sets
- Hurricane impact resistant framing options: 7-1/16" (179.4), 7-13/16" (198.4), 10-1/16" (255.6) & 10-13/16" (274.6)
- Hurricane impact resistant glazed-in panel
- Seismic performance tested with AAMA 501.4 and AAMA 501.6 standards

Product Applications

- Ideal for low to mid-rise applications where high performance is desired
- It also is the right choice for high span applications

For specific product applications,
consult your Kawneer representative.

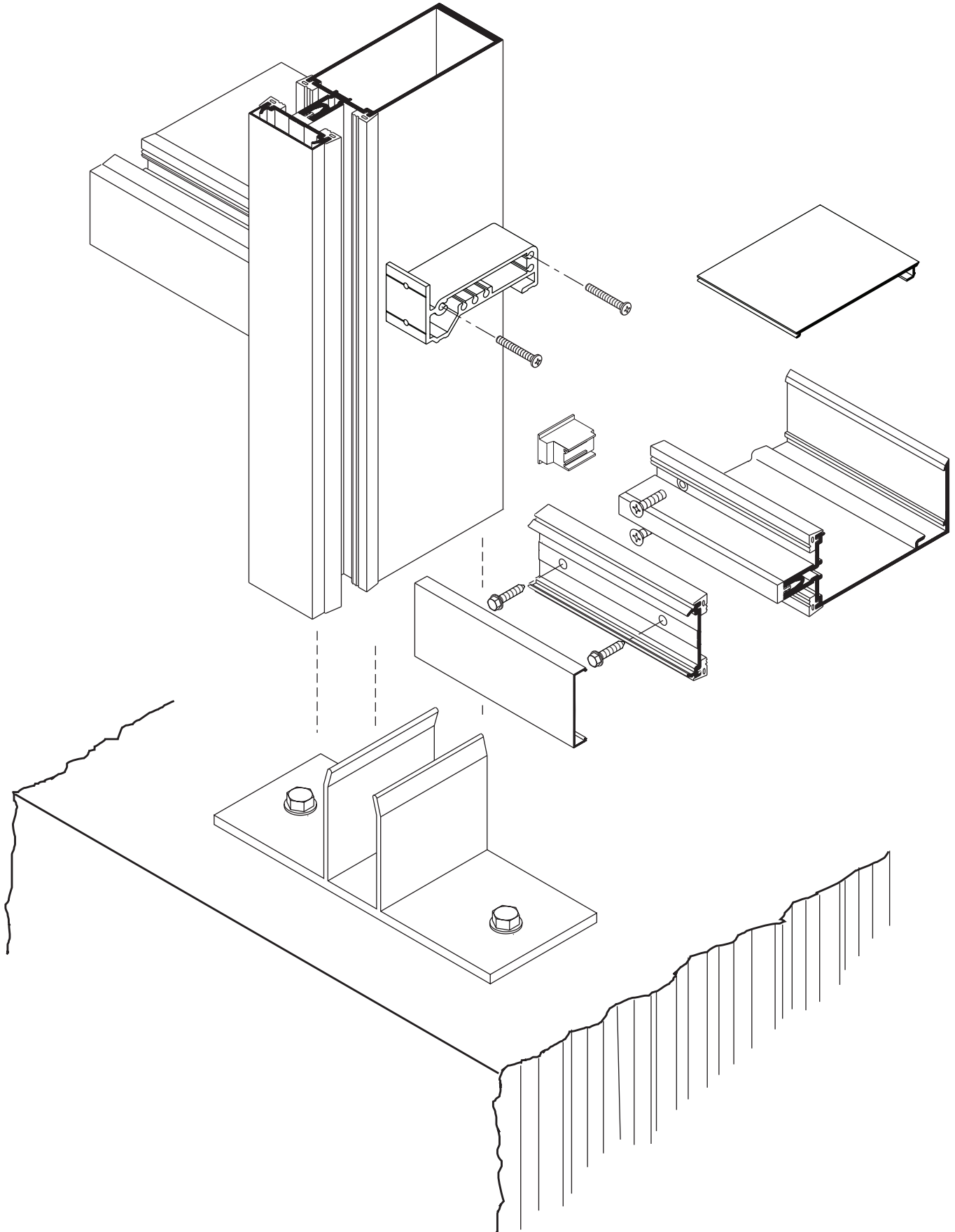

Laws and building and safety codes governing the design and use of Kawneer products, such as glazed entrance, window, and curtain wall products, vary widely. Kawneer does not control the selection of product configurations, operating hardware, or glazing materials, and assumes no responsibility therefor.

Kawneer reserves the right to change configuration without prior notice when deemed necessary for product improvement.
© 2017, Kawneer Company, Inc.

Additional information and CAD details are available at www.kawneer.com

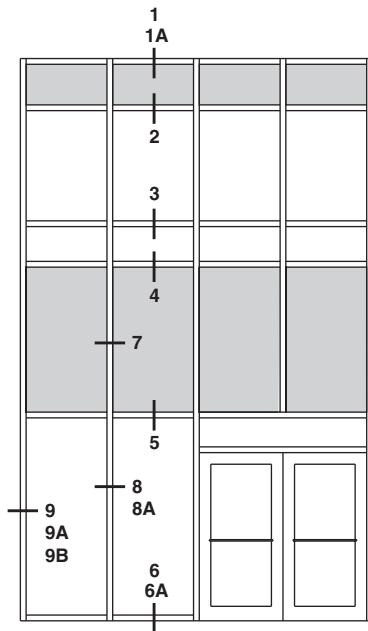

ELEVATION IS NUMBER KEYED TO DETAILS

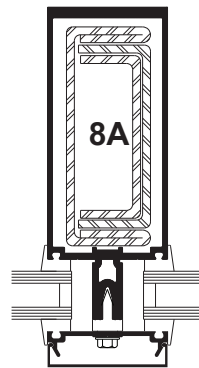
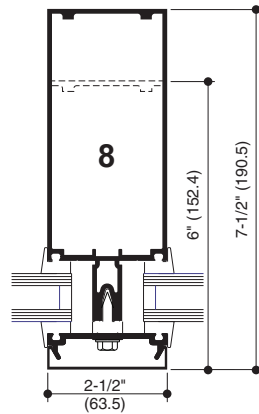
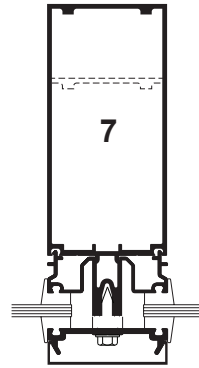

OPTIONAL STEEL REINFORCING AS REQUIRED

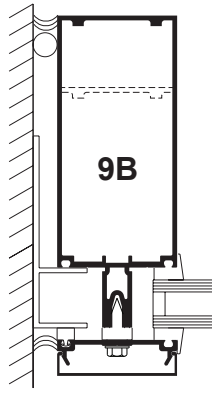
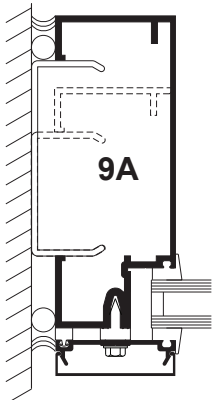
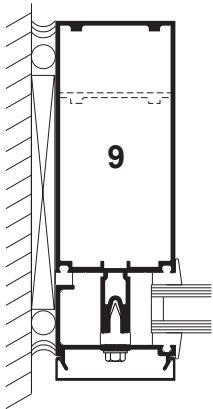
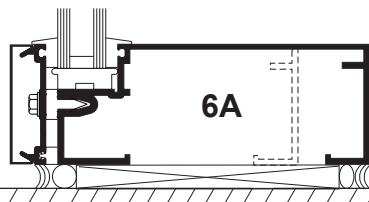
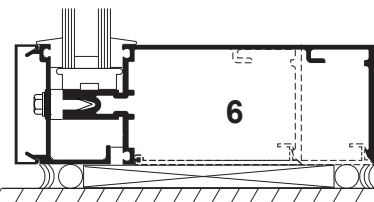
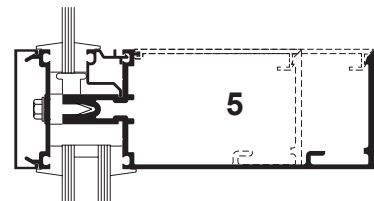
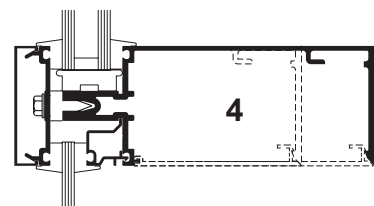
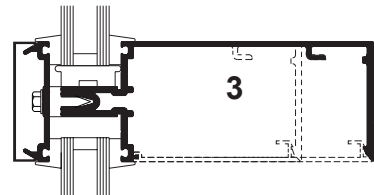
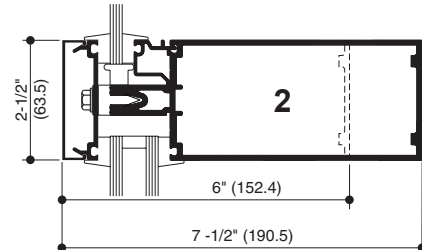
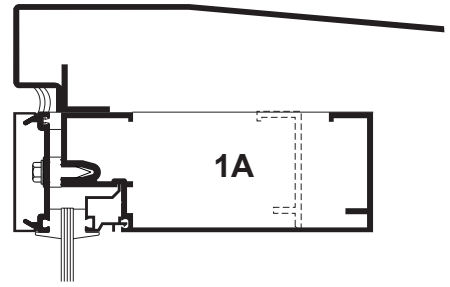
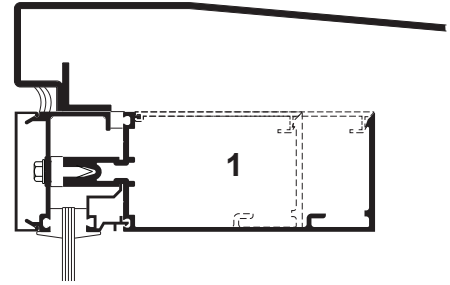



Laws and building and safety codes governing the design and use of Kawneer products, such as glazed entrance, window, and curtain wall products, vary widely. Kawneer does not control the selection of product configurations, operating hardware, or glazing materials, and assumes no responsibility therefor.

Kawneer reserves the right to change configuration without prior notice when deemed necessary for product improvement.
© 2017, Kawneer Company, Inc.

KAWNEER ANODIZED FINISHES

Kawneer gives you a wide variety of anodized finishes with attractive alternatives. The benefit of a durable, anodized finish is married to the beauty of some very dynamic and exciting colors.

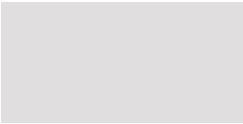
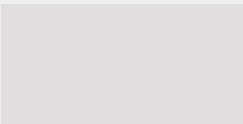
At the start of every design, there's a choice of how you want to finish. Contact your Kawneer sales rep for the information on these and other finishes available from Kawneer.

	KAWNEER FINISH NO.	COLOR	ALUMINUM ASSOCIATION SPECIFICATION	OTHER COMMENTS
	#14	CLEAR	AA-M10C21A41	Architectural Class I (0.7 mils minimum)
	#17	CLEAR	AA-M10C21A31	Architectural Class II (0.4 mils minimum)
	#40	DARK BRONZE	AA-M10C21A44	Architectural Class I (0.7 mils minimum)
	#29	BLACK	AA-M10C21A44	Architectural Class I (0.7 mils minimum)



Features

- 350 IR medium stile has 3-1/2" (88.9) vertical stiles, 3-1/2" (88.9) top and 6-1/2" (165.1) bottom rails
- 500 IR wide stile has 5" (127) vertical stile, 5" (127) top and 6-1/2" (165.1) bottom rail.
- Door is 1-3/4" (44.5) deep
- Dual moment welded corner construction
- Single acting
- Square stops for 9/16" (14.3) or 1" (25.4) glazing infill for use with Kuraray SentryGlas® dry glazing
- Offset pivots, butt hinges or continuous geared hinge
- MS locks and 3-point locks or exit device hardware
- Surface mounted or concealed closers
- Architects Classic push/pulls
- Adjustable astragal utilizing pile weathering with polymeric fin at meeting stiles
- Polymeric bulb weatherstripping in door frames
- Permanodic® anodized finishes in seven choices
- Painted finishes in standard and custom choices
- Water performance option (Non-ADA)

Optional Features

- Paneline® / Paneline® MEL exit device (Hurricane Resistant applications only)
- Square stops with interior silicone seal for 9/16" (14.3) glazing infill
- Square stops with 3M® VHB interior tape for 9/16" (14.3) or 1" (25.4) glazing infill
- Variety of bottom rails and horizontal cross rails

Product Applications

- 350 IR medium stile and 500 IR wide stile provides extra strength for schools, institutions and other high traffic applications where codes require wind borne debris protection or blast mitigation protection

For specific product applications,
consult your Kawneer representative.

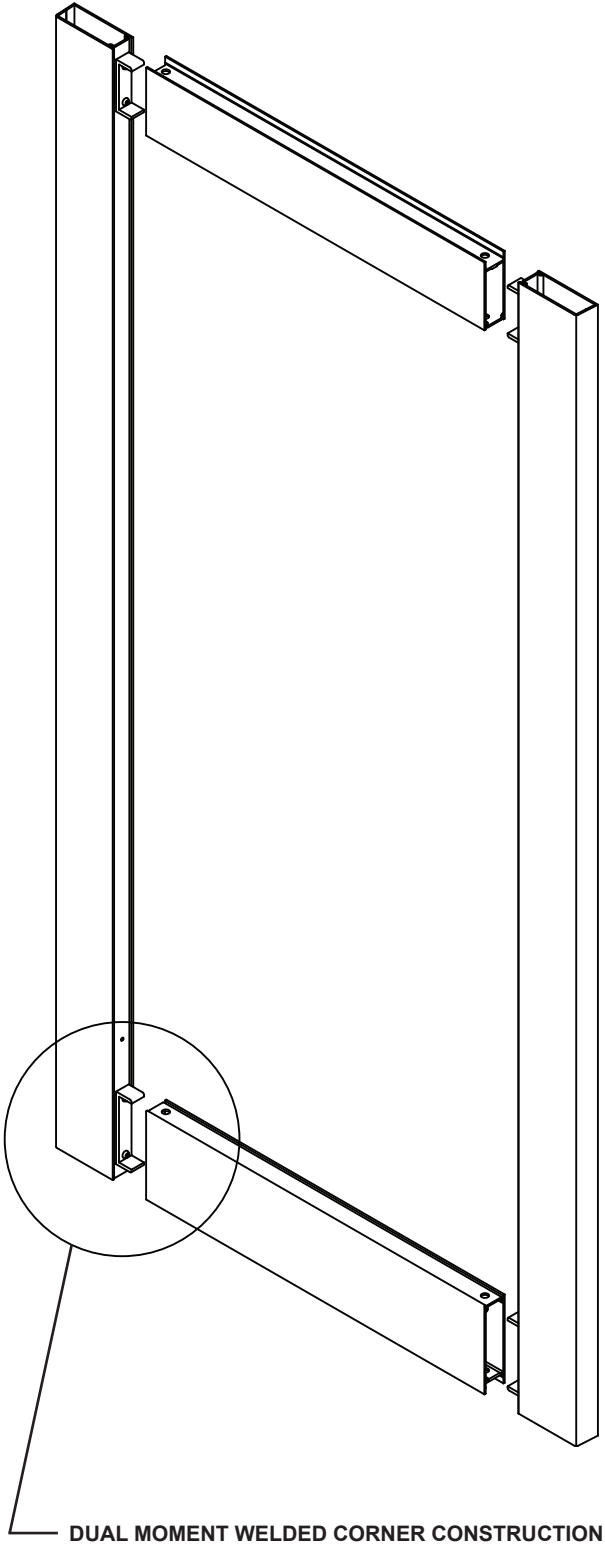

DUAL MOMENT WELDED CORNER CONSTRUCTION

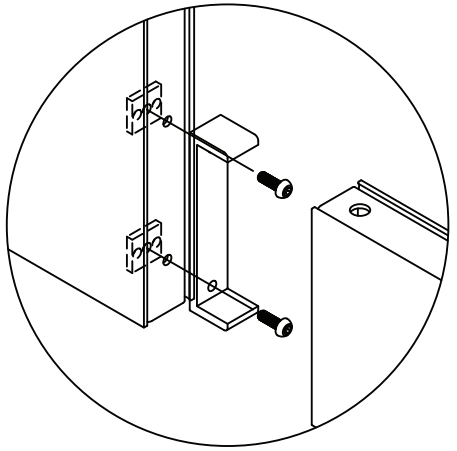

#1 MECHANICAL FASTENING is accomplished by attaching a 5/16" (7.9) thick extruded aluminum channel clip to the vertical stile with 1/4"-20 heat strengthened bolts and 3/16" thick steel nut plates for a high strength welding base for attachment horizontal member.

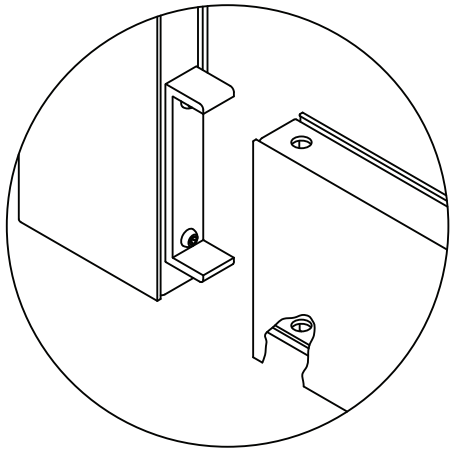

#2 SIGMA* DEEP PENETRATION PLUG WELDS are made top and bottom after the horizontal is properly positioned over the channel clip to help provide the strongest door corner joint currently available.

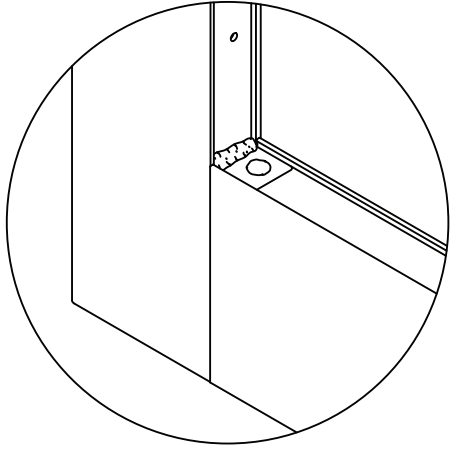

#3 SIGMA* FILLET WELDS along both top and bottom webs of the rail extrusion complete the welded corner construction.

* An arc welding process known as Shielded Inert Gas Metal Arc (SIGMA) or also known as Metal Inert Gas (MIG).

Laws and building and safety codes governing the design and use of Kawneer products, such as glazed entrance, window, and curtain wall products, vary widely. Kawneer does not control the selection of product configurations, operating hardware, or glazing materials, and assumes no responsibility therefor.

Kawneer reserves the right to change configuration without prior notice when deemed necessary for product improvement.
© 2014, Kawneer Company, Inc.



Additional information and CAD details are available at www.kawneer.com

350 IR MEDIUM STILE

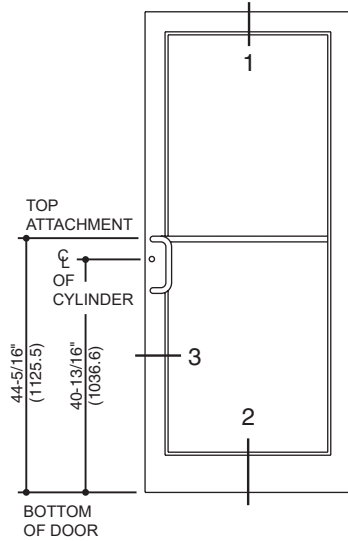

500 IR WIDE STILE

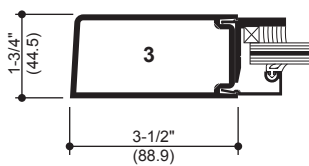
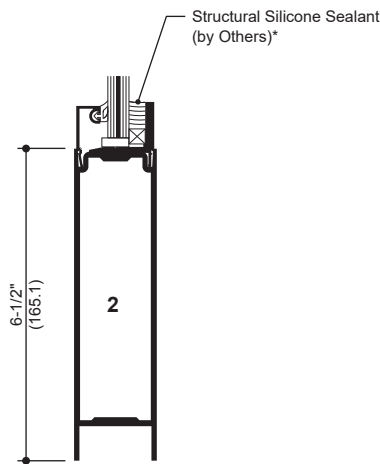
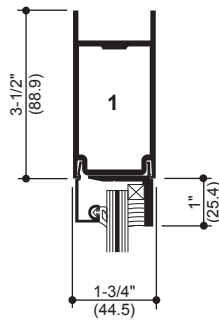
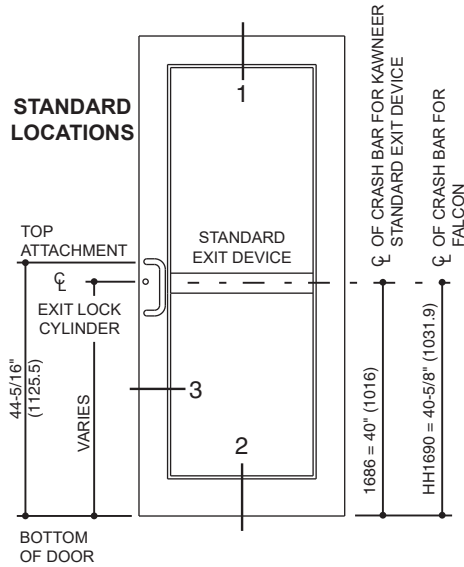

SINGLE ACTING

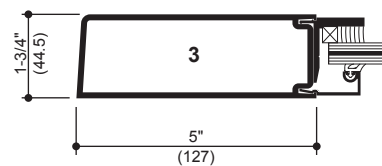
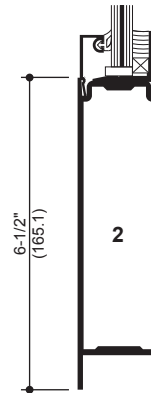
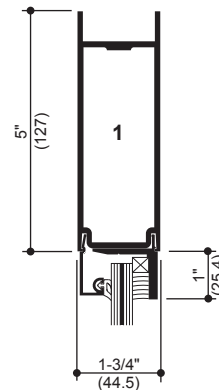

SINGLE ACTING

* INSTALLER NOTE: Installer is responsible for all required compatibility review and approvals with the Structural Silicone Manufacturer and the Insulating Glass Unit Manufacturer.

SIMPLE. *elegant*. SOLUTIONS.
from a company you can trust



Eagle Tile Product Sample

www.eagleroofing.com



3664 Terracambra Range
Capistrano Profile

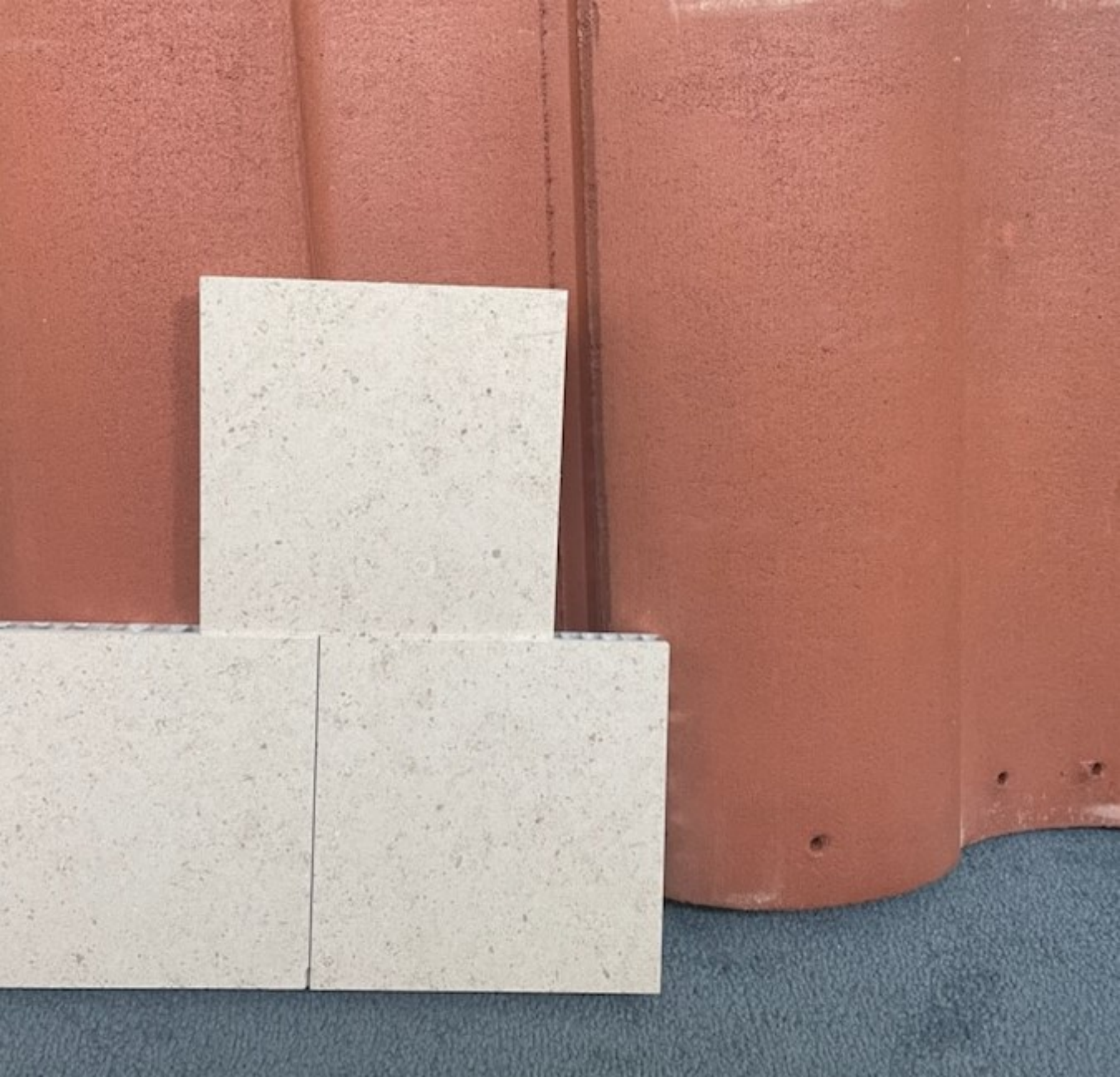

Firestone

UltraPly™ TPO

Scrim Reinforced Thermoplastic Polyolefin
(TPO) Roofing Membrane

Membrane TPO, armée d'une natte

Membrana TPO, con malla reforzada de
poliéster

60 mil (1.5 mm)

09/2018

Item # 1135