

CONTRACT PLANS FOR CITY OF VENICE DOWNTOWN ROADWAY CORRIDOR IMPROVEMENTS

CONTRACT PLANS COMPONENTS

- ROADWAY PLANS
- LANDSCAPE PLANS
- SIGNING & PAVEMENT MARKING PLANS
- SIGNALIZATION (PEDESTRIAN MID-BLOCK CROSSINGS)
- LIGHTING PLANS (PHASE 1)

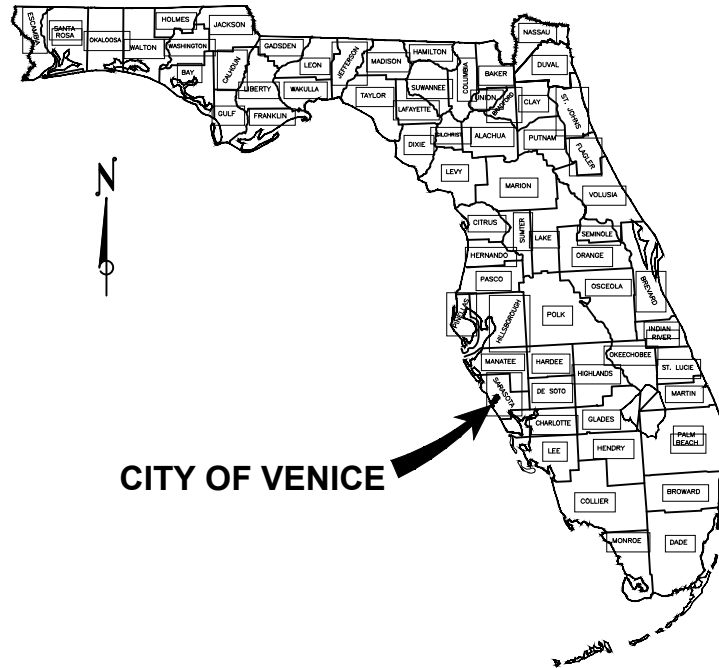

CITY PROJECT #: 2017-03
 FDOT FINANCIAL PROJECT ID: 435092-1-58-01
 FDOT EDTF #: 439455-1-54-01
 FEDERAL FUNDS

CITY of VENICE
 ENGINEERING DEPARTMENT
 401 WEST VENICE AVENUE
 Venice, Florida 34285
 ph: (941) 486-2626

INDEX OF SIGNING & PAVEMENT PLANS

SHEET #	TITLE
1	COVER SHEET
SPM-1 - SPM-14	SIGNING & PAVEMENT PLANS

MAYOR AND CITY COUNCIL

- JOHN HOLIC MAYOR
 RICHARD CAUTERO..... VICE MAYOR
 BOB DANIELS COUNCIL MEMBER
 KIT McKEON..... COUNCIL MEMBER
 FRED FRAIZE COUNCIL MEMBER
 DEBORAH ANDERSON COUNCIL MEMBER
 JEANETTE GATES..... COUNCIL MEMBER

GOVERNING DESIGN STANDARDS:

Florida Department of Transportation, FY 2017-18 Design Standards eBook (DSeB) and applicable Design Standards Revisions (DSRs) at the following website:
<http://www.fdot.gov/roadway/DesignStandards/Standards.shtm>

GOVERNING STANDARD SPECIFICATIONS:

Florida Department of Transportation, July 2017 Standard Specifications for Road and Bridge Construction at the following website:
<http://www.fdot.gov/programmanagement/Implemented/SpecBooks>

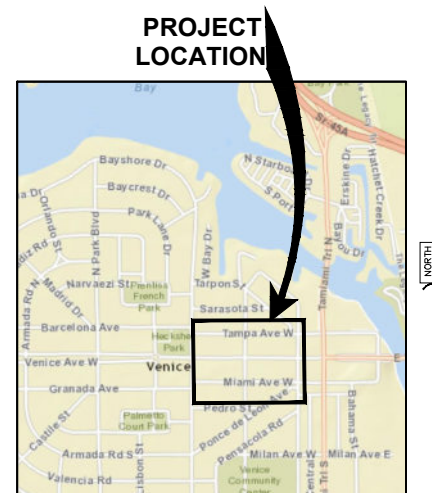

LOCATION MAP

PREPARED BY:



PRINCIPAL ADDRESS:
 4030 W. BOY SCOUT BLVD.
 SUITE 700
 TAMPA, FL. 33607-1712
 FBPR CERT. OF AUTH. No. 24

60% PLANS
 8-1-2017



PROFESSIONAL ENGINEER
 CHRISTOPHER R. SCHULTZ
 LICENSE # 76854
 PHONE: 407-806-4370

Z:\Projects\City Of Venice\Downtown Roadway\CAD\05_60% Design\SPM & Signals\02_SPM Plan.dwg, Aug 09, 2017 - 9:52am

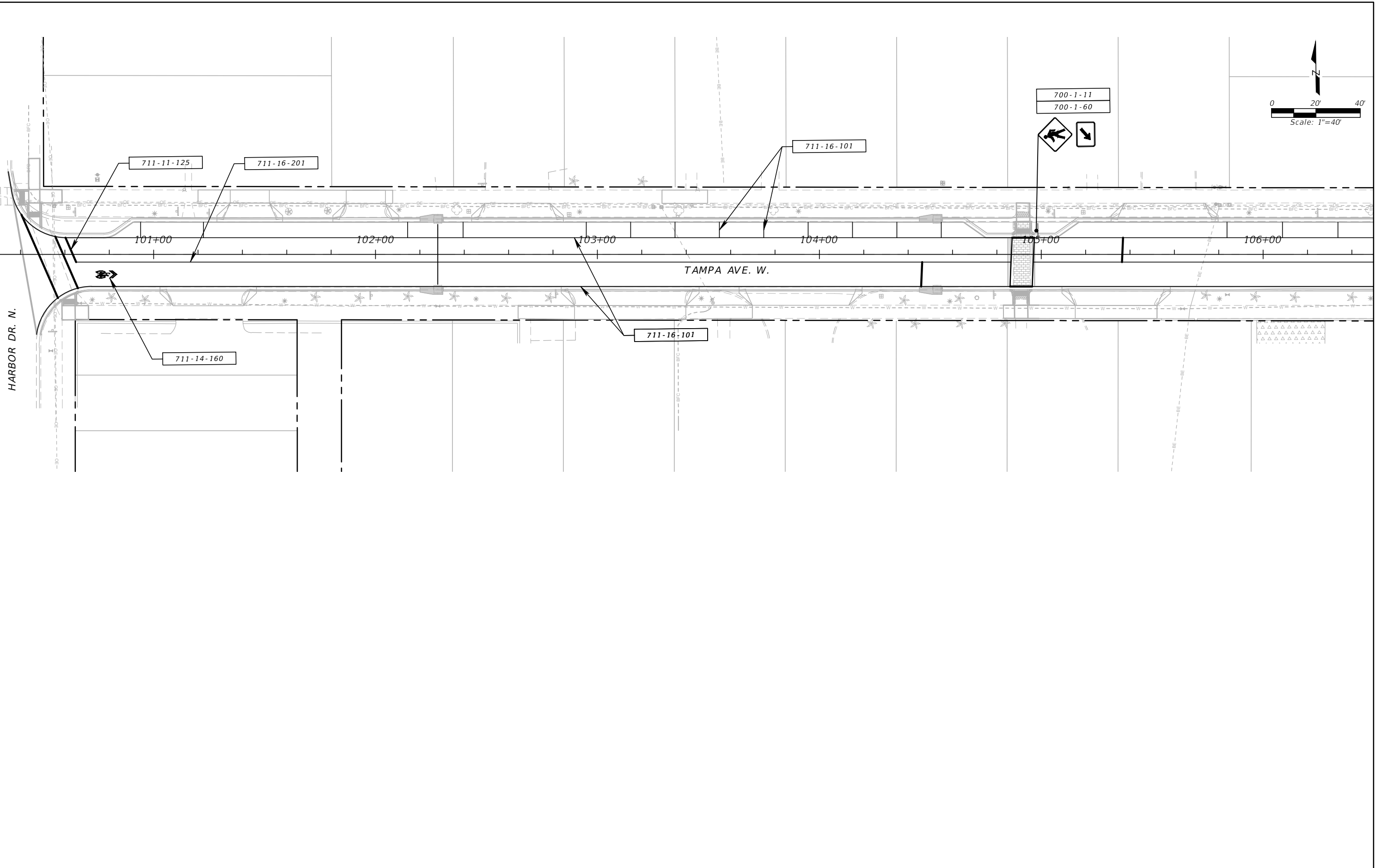

<table border="1"> <tr> <td>DESIGNED</td> <td>ALC</td> </tr> <tr> <td>DRAWN</td> <td>SWC</td> </tr> <tr> <td>CHECKED</td> <td>CRS</td> </tr> </table>			DESIGNED	ALC	DRAWN	SWC	CHECKED	CRS	PREPARED FOR: 	PREPARED BY: 	PROJECT: CITY OF VENICE DOWNTOWN ROADWAY CORRIDOR IMPROVEMENTS	DESCRIPTION: TAMPA AVE. SIGNING & PAVEMENT STA.100+40 TO STA.106+40	APPROVED BY: CHRISTOPHER R. SCHULTZ, P.E. FLA. REG. NO 76854 ATKINS NORTH AMERICA (FBPR CA No.24) 482 SOUTH KELLER ROAD ORLANDO, FL 32810-6101	DATE: 8/9/2017 PROJECT NO.: 100054389 SHEET: SPM-1
DESIGNED	ALC													
DRAWN	SWC													
CHECKED	CRS													
REV. NO.	DATE	DESCRIPTION												

Z:\Projects\City Of Venice\Downtown Roadway\CAD\05_60% Design\SPM & Signals\SPM Plan.dwg, Aug 09, 2017 - 9:53am

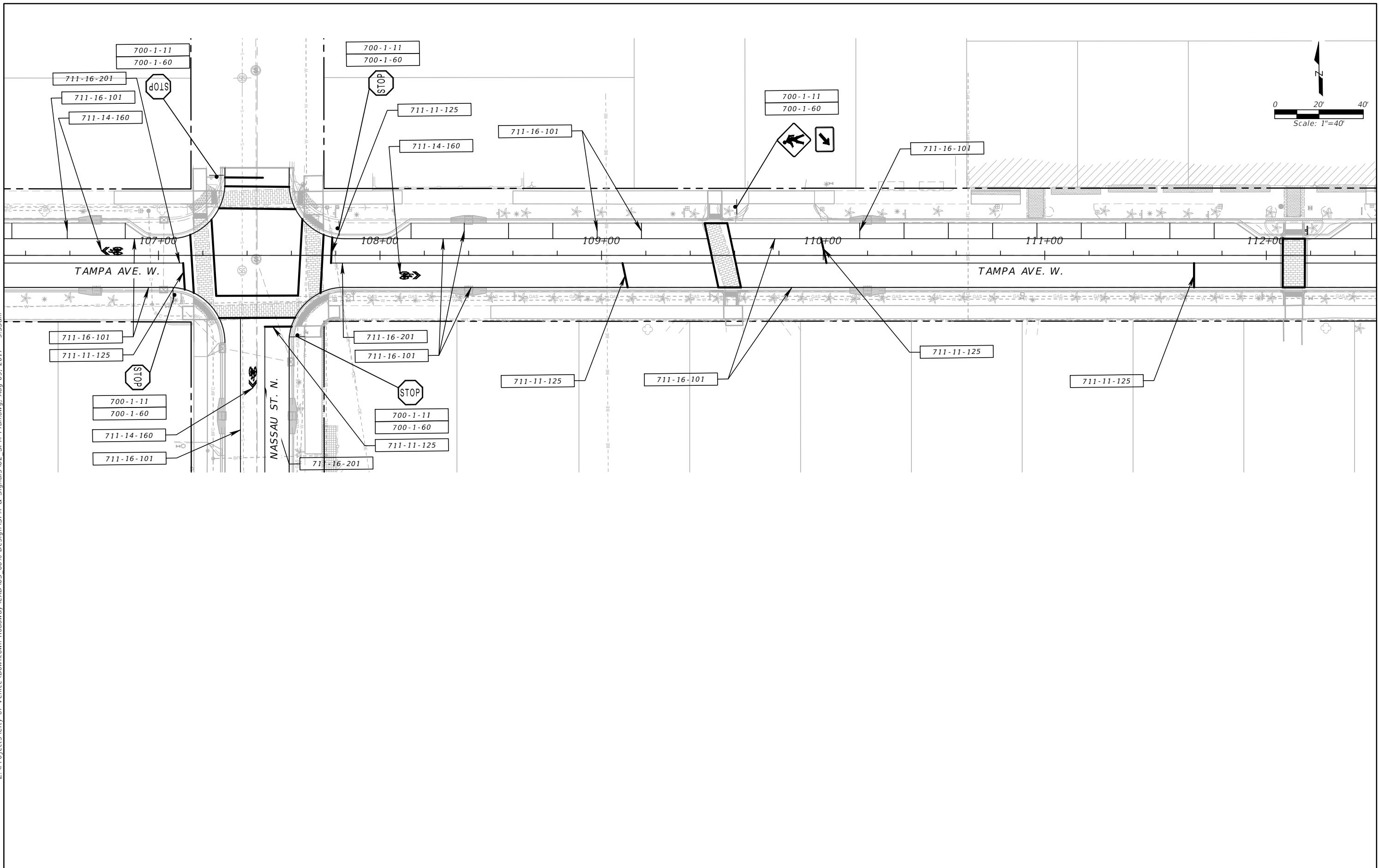

<table border="1"> <tr> <td>DESIGNED</td> <td>ALC</td> </tr> <tr> <td>DRAWN</td> <td>SWC</td> </tr> <tr> <td>CHECKED</td> <td>CRS</td> </tr> </table>			DESIGNED	ALC	DRAWN	SWC	CHECKED	CRS	PREPARED FOR: 	PREPARED BY: 	PROJECT: CITY OF VENICE DOWNTOWN ROADWAY CORRIDOR IMPROVEMENTS	DESCRIPTION: TAMPA AVE. SIGNING & PAVEMENT STA.106+40 TO STA.112+40	APPROVED BY: CHRISTOPHER R. SCHULTZ, P.E. FLA. REG. NO 76854 ATKINS NORTH AMERICA (FBPR CA No.24) 482 SOUTH KELLER ROAD ORLANDO, FL 32810-6101	DATE: 8/9/2017 PROJECT NO.: 100054389 SHEET: SPM-2
DESIGNED	ALC													
DRAWN	SWC													
CHECKED	CRS													
REV. NO.	DATE	DESCRIPTION												

Z:\Projects\City Of Venice\Downtown Roadway\CAD\05 60% Design\SPM & Signals\SPM Plan.dwg, Aug 09, 2017 - 9:54am

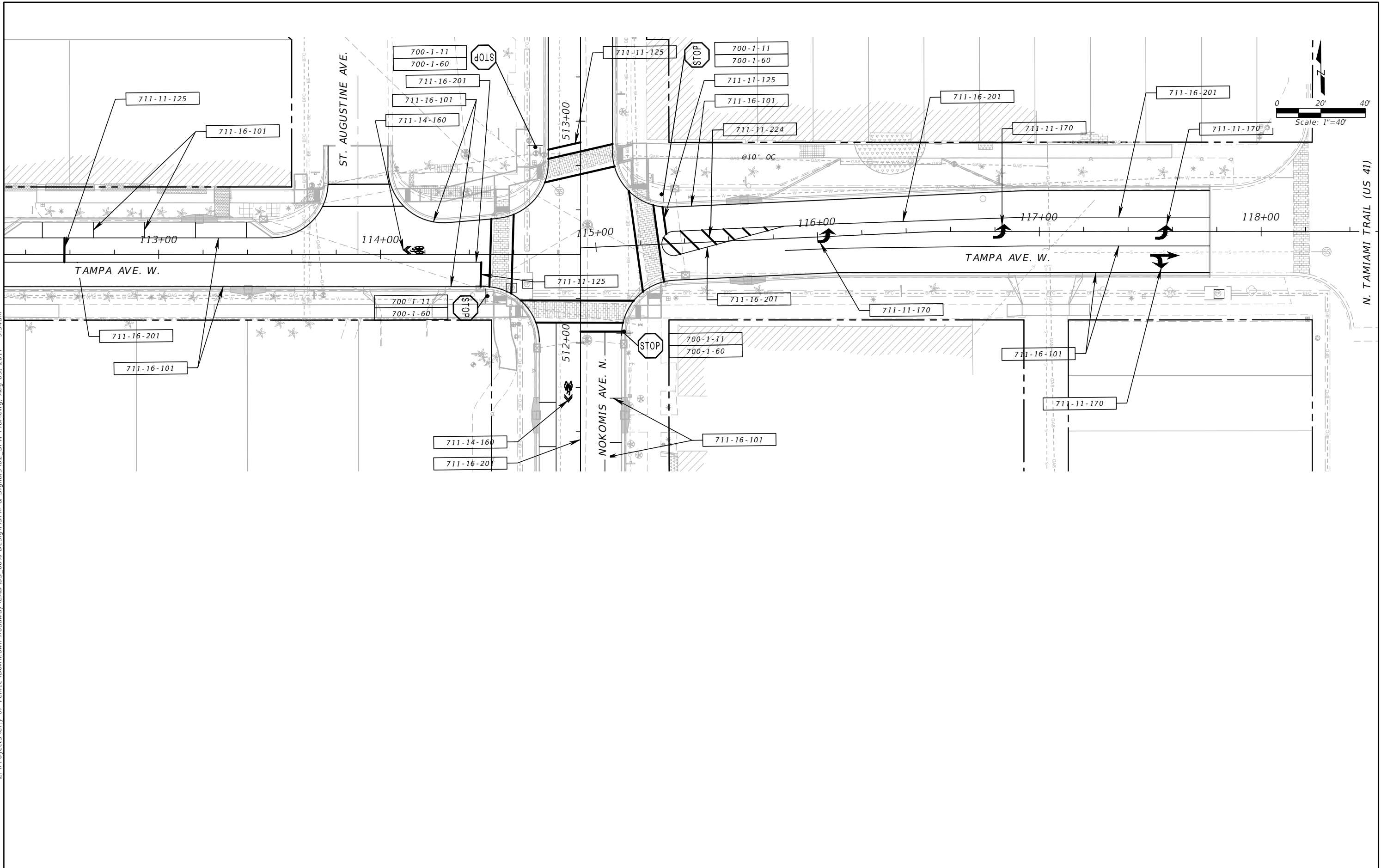

<table border="1"> <tr> <td>DESIGNED</td> <td>ALC</td> </tr> <tr> <td>DRAWN</td> <td>SWC</td> </tr> <tr> <td>CHECKED</td> <td>CRS</td> </tr> </table>			DESIGNED	ALC	DRAWN	SWC	CHECKED	CRS	PREPARED FOR: 	PREPARED BY: 	PROJECT: CITY OF VENICE DOWNTOWN ROADWAY CORRIDOR IMPROVEMENTS	DESCRIPTION: TAMPA AVE. SIGNING AND PAVEMENT STA.112+40 TO STA.118+40	APPROVED BY: CHRISTOPHER R. SCHULTZ, P.E. FLA. REG. NO 76854 ATKINS NORTH AMERICA (FBPR CA No.24) 482 SOUTH KELLER ROAD ORLANDO, FL 32810-6101	DATE: 8/9/2017 PROJECT NO.: 100054389 SHEET: SPM-3
DESIGNED	ALC													
DRAWN	SWC													
CHECKED	CRS													
REV. NO.	DATE	DESCRIPTION												

Z:\Projects\City Of Venice\Downtown Roadway\CAD\05 60% Design\SPM & Signals\SPM Plan.dwg, Aug 09, 2017 - 9:54am

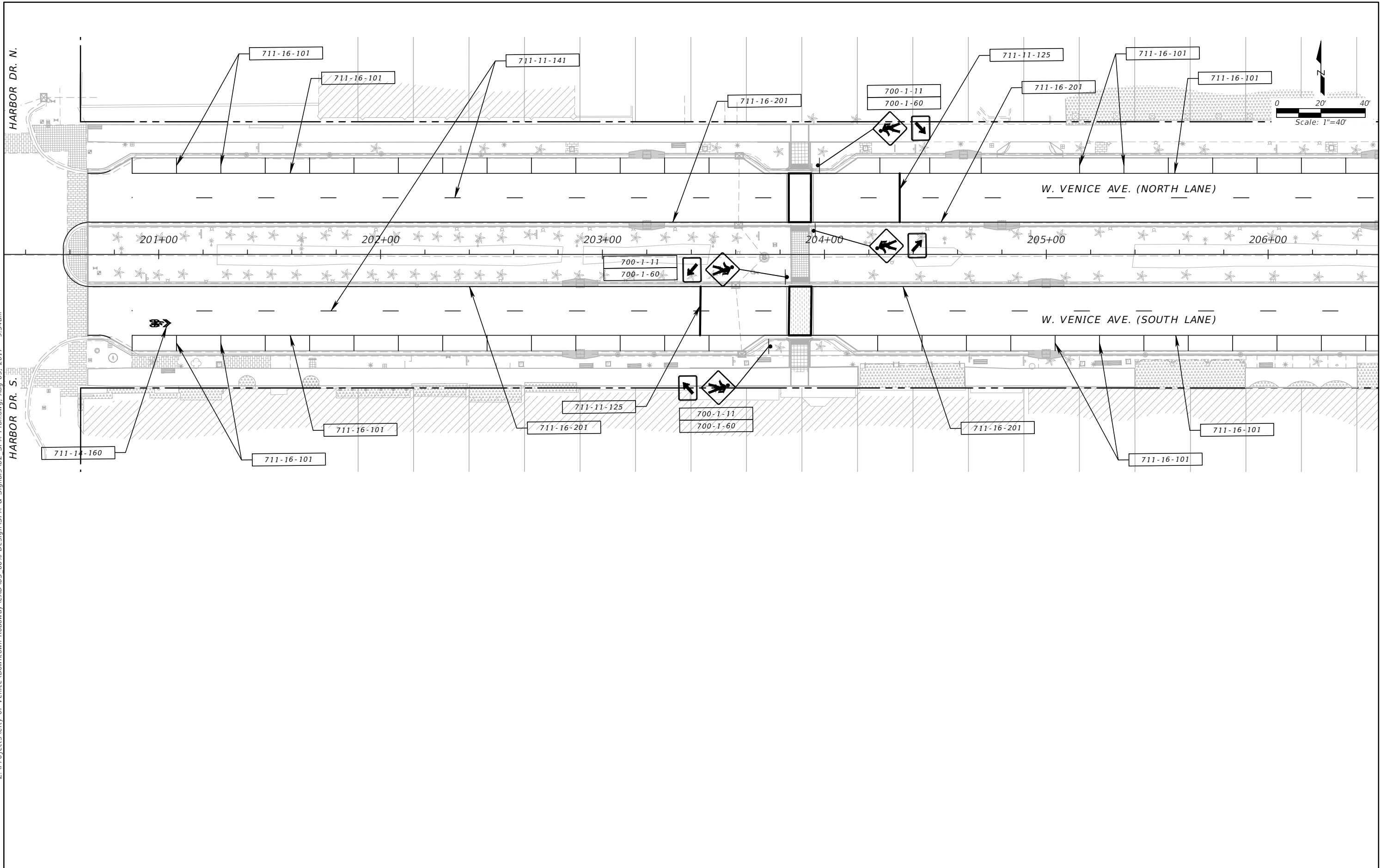

DESIGNED <u>ALC</u>		PREPARED FOR:	PREPARED BY:	PROJECT:	DESCRIPTION:	APPROVED BY:	DATE:
DRAWN <u>SWC</u>				CITY OF VENICE DOWNTOWN ROADWAY CORRIDOR IMPROVEMENTS	VENICE AVE. SIGNING & PAVEMENT STA.200+40 TO STA.206+40	CHRISTOPHER R SCHULTZ, P.E. FLA. REG. NO 76854 ATKINS NORTH AMERICA (FBPR CA No.24) 482 SOUTH KELLER ROAD ORLANDO, FL 32810-6101	8/9/2017
CHECKED <u>CRS</u>							PROJECT NO.:
REV. NO.	DATE	DESCRIPTION					SHEET: SPM-4

Z:\Projects\City Of Venice\Downtown Roadway\CAD\05_60% Design\SPM & Signals\SPM Plan.dwg, Aug 09, 2017 - 9:55am

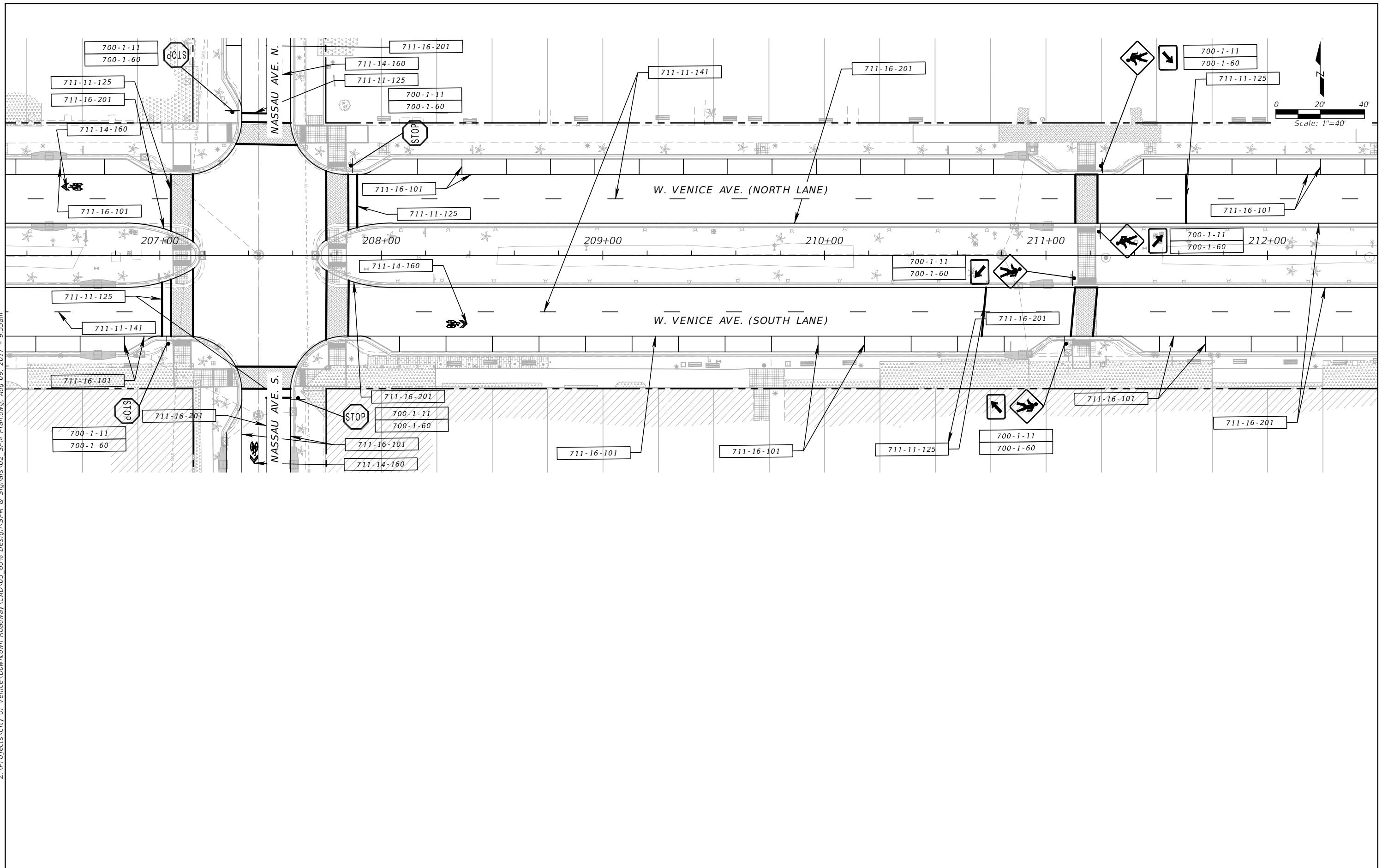

<table border="1"> <tr> <td>DESIGNED</td> <td>ALC</td> </tr> <tr> <td>DRAWN</td> <td>SWC</td> </tr> <tr> <td>CHECKED</td> <td>CRS</td> </tr> </table>			DESIGNED	ALC	DRAWN	SWC	CHECKED	CRS	PREPARED FOR: 	PREPARED BY: 	PROJECT: CITY OF VENICE DOWNTOWN ROADWAY CORRIDOR IMPROVEMENTS	DESCRIPTION: VENICE AVE. SIGNING & PAVEMENT STA.206+40 TO STA.212+40	APPROVED BY: CHRISTOPHER R. SCHULTZ, P.E. FLA. REG. NO 76854 ATKINS NORTH AMERICA (FBPR CA No.24) 482 SOUTH KELLER ROAD ORLANDO, FL 32810-6101	DATE: 8/9/2017 PROJECT NO.: 100054389 SHEET: SPM-5
DESIGNED	ALC													
DRAWN	SWC													
CHECKED	CRS													
REV. NO.	DATE	DESCRIPTION												

Z:\Projects\City Of Venice\Downtown Roadway\CAD\05_60% Design\SPM & Signals\02_SPM Plan.dwg, Aug 09, 2017 - 9:56am

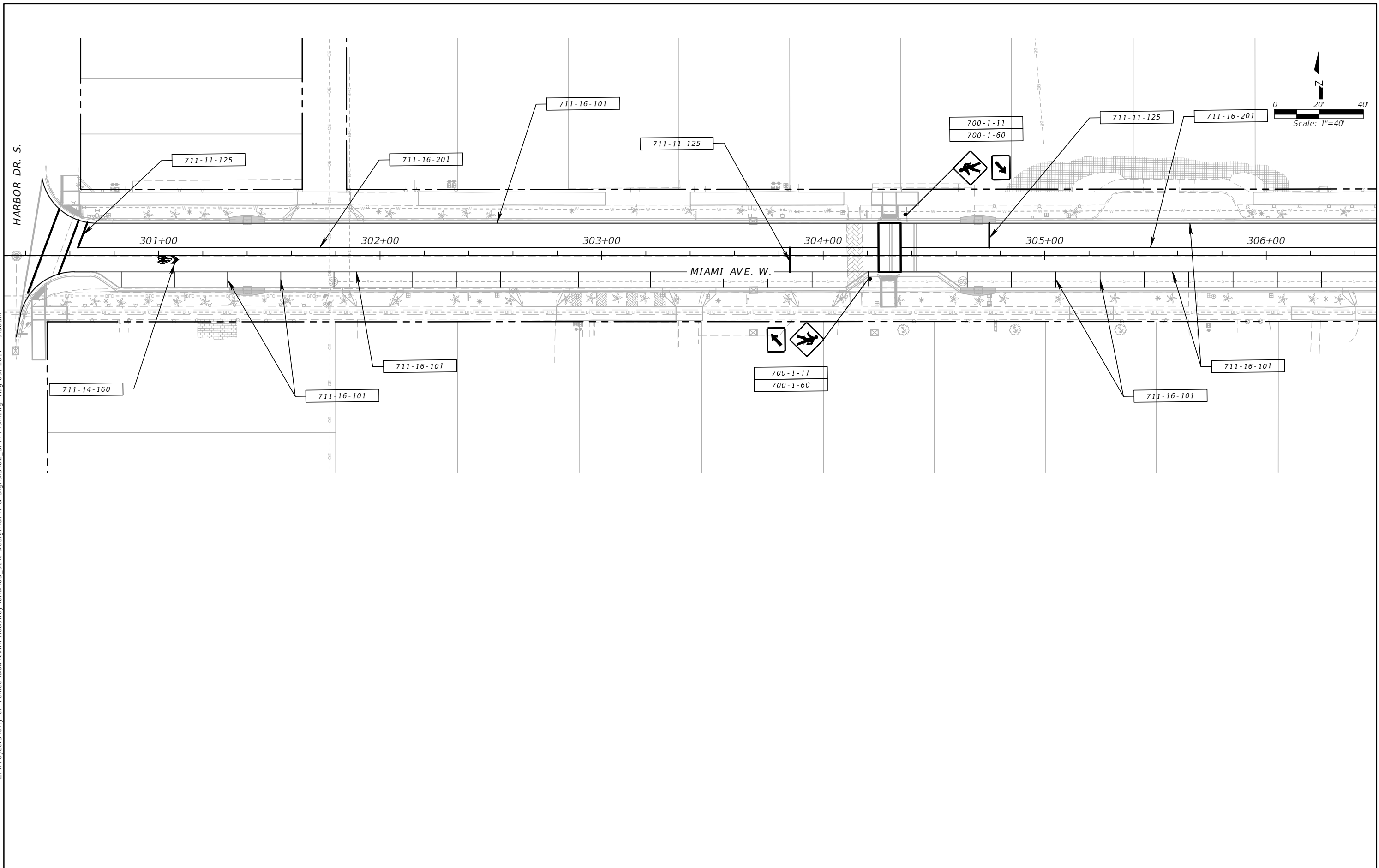

<table border="1"> <tr> <td>DESIGNED</td> <td>ALC</td> </tr> <tr> <td>DRAWN</td> <td>SWC</td> </tr> <tr> <td>CHECKED</td> <td>CRS</td> </tr> </table>			DESIGNED	ALC	DRAWN	SWC	CHECKED	CRS	PREPARED FOR: 	PREPARED BY: 	PROJECT: CITY OF VENICE DOWNTOWN ROADWAY CORRIDOR IMPROVEMENTS	DESCRIPTION: MIAMI AVE. SIGNING & PAVEMENT STA.300+40 TO STA.306+40	APPROVED BY: CHRISTOPHER R SCHULTZ, P.E. FLA. REG. NO 76854 ATKINS NORTH AMERICA (FBPR CA No.24) 482 SOUTH KELLER ROAD ORLANDO, FL 32810-6101	DATE: 8/9/2017 PROJECT NO.: 100054389 SHEET: SPM-7
DESIGNED	ALC													
DRAWN	SWC													
CHECKED	CRS													
REV. NO.	DATE	DESCRIPTION												

Z:\Projects\City Of Venice\Downtown Roadway\CAD\05 60% Design\SPM & Signals\02_SPM Plan.dwg, Aug 09, 2017 - 9:56am

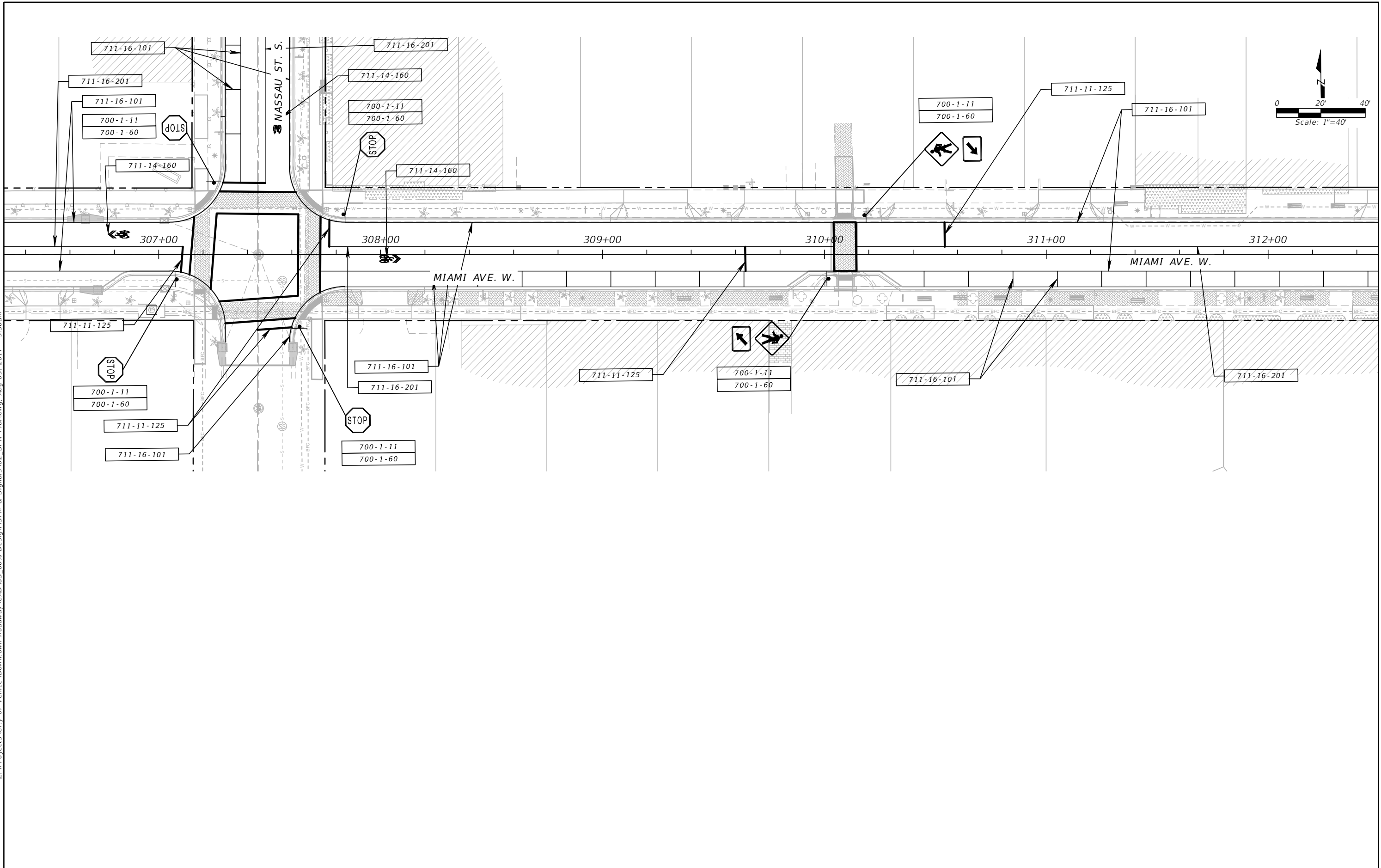

<table border="1"> <tr> <td>DESIGNED</td> <td>ALC</td> </tr> <tr> <td>DRAWN</td> <td>SWC</td> </tr> <tr> <td>CHECKED</td> <td>CRS</td> </tr> </table>			DESIGNED	ALC	DRAWN	SWC	CHECKED	CRS	PREPARED FOR: 	PREPARED BY: 	PROJECT: CITY OF VENICE DOWNTOWN ROADWAY CORRIDOR IMPROVEMENTS	DESCRIPTION: MIAMI AVE. SIGNING & PAVEMENT STA.306+40 TO STA.312+40	APPROVED BY: CHRISTOPHER R. SCHULTZ, P.E. FLA. REG. NO 76854 ATKINS NORTH AMERICA (FBPR CA No.24) 482 SOUTH KELLER ROAD ORLANDO, FL 32810-6101	DATE: 8/9/2017 PROJECT NO.: 100054389 SHEET: SPM-8
DESIGNED	ALC													
DRAWN	SWC													
CHECKED	CRS													
REV. NO.	DATE	DESCRIPTION												

Z:\Projects\City Of Venice\Downtown Roadway\CAD\05_60% Design\SPM & Signals\SPM Plan.dwg, Aug 09, 2017 - 9:57 am

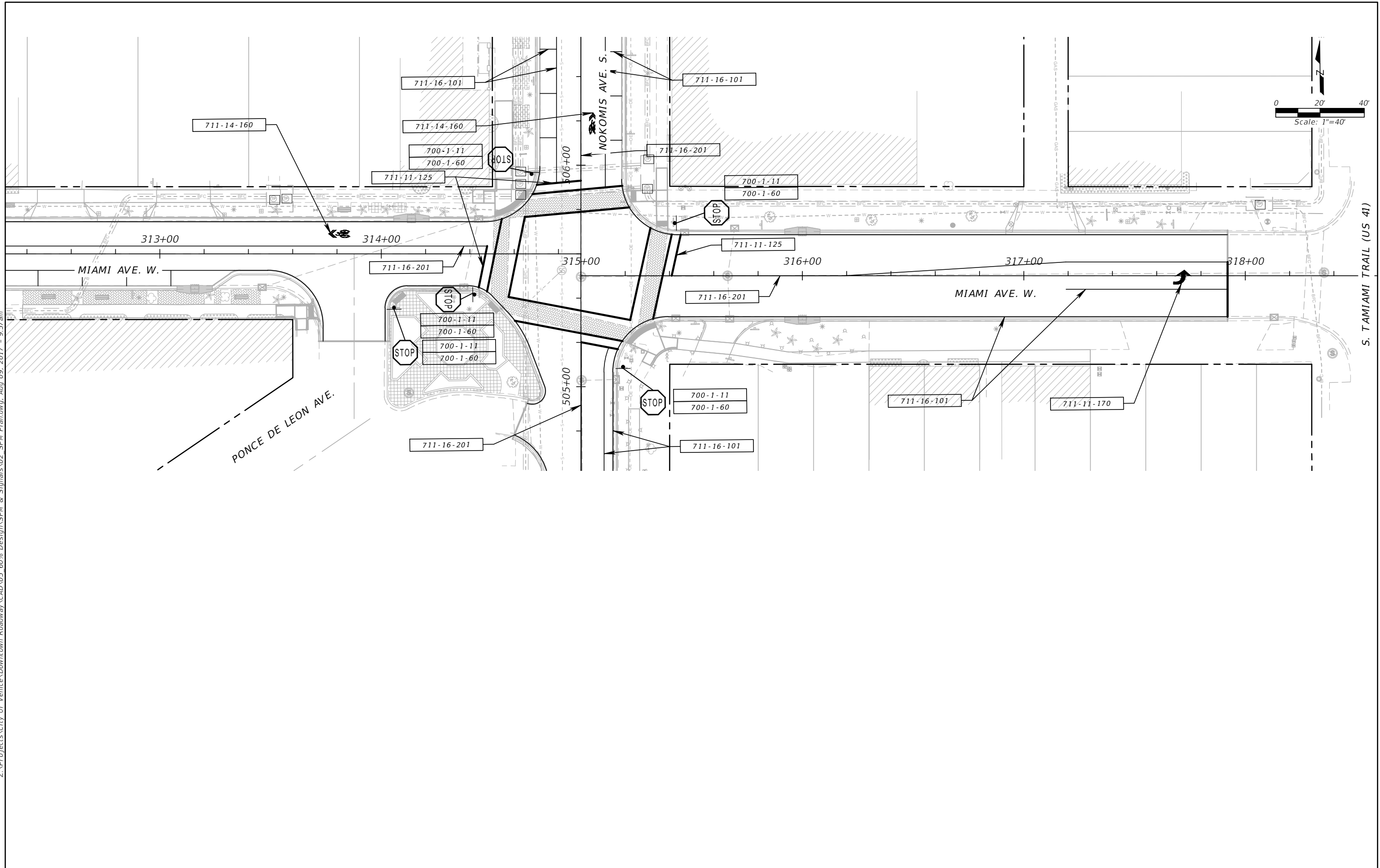

<table border="1"> <tr> <td>DESIGNED</td> <td>ALC</td> </tr> <tr> <td>DRAWN</td> <td>SWC</td> </tr> <tr> <td>CHECKED</td> <td>CRS</td> </tr> </table>			DESIGNED	ALC	DRAWN	SWC	CHECKED	CRS	PREPARED FOR: 	PREPARED BY: 	PROJECT: CITY OF VENICE DOWNTOWN ROADWAY CORRIDOR IMPROVEMENTS	DESCRIPTION: MIAMI AVE. SIGNING & PAVEMENT STA.312+40 TO STA.318+40	APPROVED BY: CHRISTOPHER R. SCHULTZ, P.E. FLA. REG. NO 76854 ATKINS NORTH AMERICA (FBPR CA No.24) 482 SOUTH KELLER ROAD ORLANDO, FL 32810-6101	DATE: 8/9/2017 PROJECT NO.: 100054389 SHEET: SPM-9
DESIGNED	ALC													
DRAWN	SWC													
CHECKED	CRS													
REV. NO.	DATE	DESCRIPTION												

Z:\Projects\City Of Venice\Downtown Roadway\CAD\05_60% Design\SPM & Signals\02_SPM Plan.dwg, Aug 09, 2017 - 9:58 am

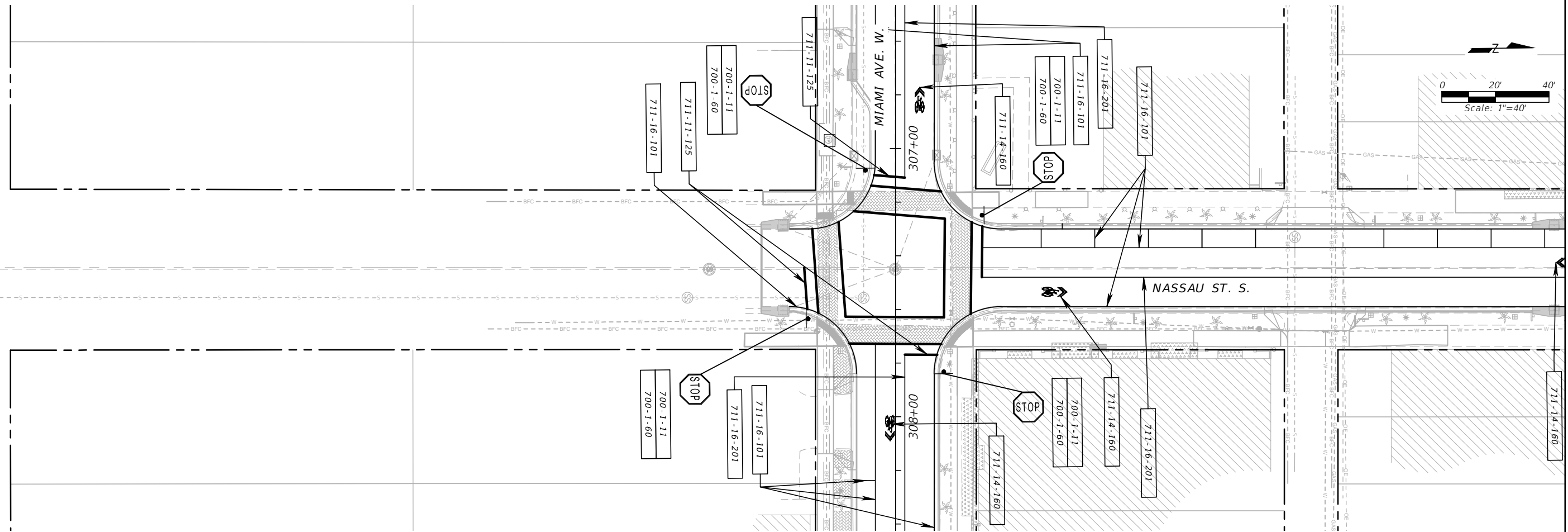

REV. NO.	DATE	DESCRIPTION

DESIGNED	ALC
DRAWN	SWC
CHECKED	CRS

PREPARED FOR:

PREPARED BY:

PROJECT:
**CITY OF VENICE
 DOWNTOWN ROADWAY
 CORRIDOR IMPROVEMENTS**

DESCRIPTION:
**NASSAU ST.
 SIGNING & PAVEMENT
 STA.400+00 TO STA.406+00**

APPROVED BY:

CHRISTOPHER R SCHULTZ, P.E.
 FLA. REG. NO 76854
 ATKINS NORTH AMERICA (FBPR CA No.24)
 482 SOUTH KELLER ROAD
 ORLANDO, FL 32810-6101

DATE: 8/9/2017
 PROJECT NO.: 100054389
 SHEET: SPM-10

Z:\Projects\City Of Venice\Downtown Roadway\CAD\05 60% Design\SPM & Signals\02_SPM Plan.dwg, Aug 09, 2017 - 9:58am

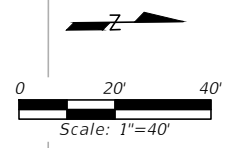
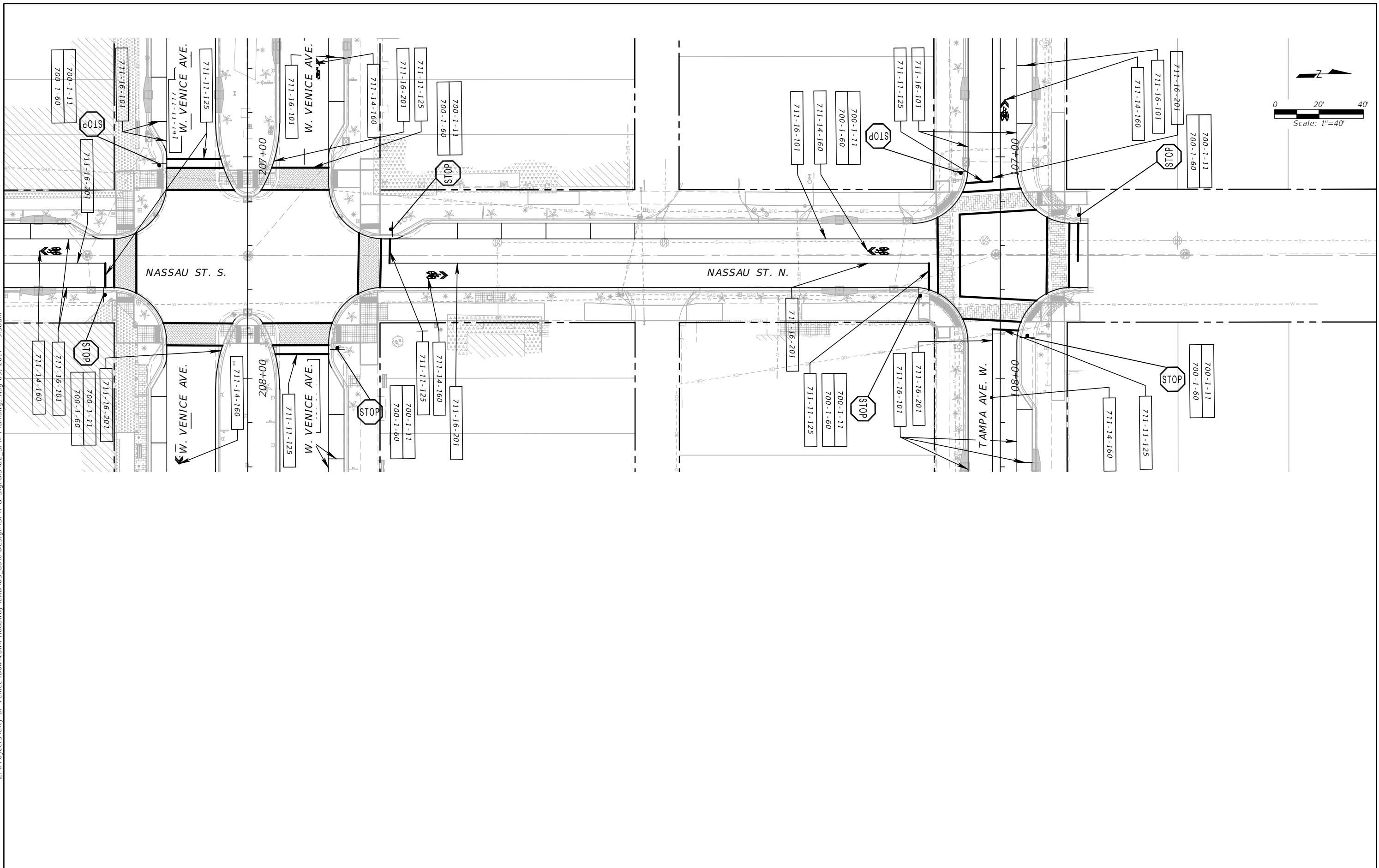

REV. NO.	DATE	DESCRIPTION

DESIGNED ALC
 DRAWN SWC
 CHECKED CRS



PROJECT:
**CITY OF VENICE
 DOWNTOWN ROADWAY
 CORRIDOR IMPROVEMENTS**

DESCRIPTION:
**NASSAU ST.
 SIGNING & PAVEMENT
 STA.406+00 TO STA.412+00**

APPROVED BY:

CHRISTOPHER R. SCHULTZ, P.E.
 FLA. REG. NO 76854
 ATKINS NORTH AMERICA (FBPR CA No.24)
 482 SOUTH KELLER ROAD
 ORLANDO, FL 32810-6101

DATE: 8/9/2017
 PROJECT NO.: 100054389
 SHEET: SPM-11

Z:\Projects\City Of Venice\Downtown Roadway\CAD\05_60% Design\SPM & Signals\SPM Plan.dwg, Aug 09, 2017 - 9:58am

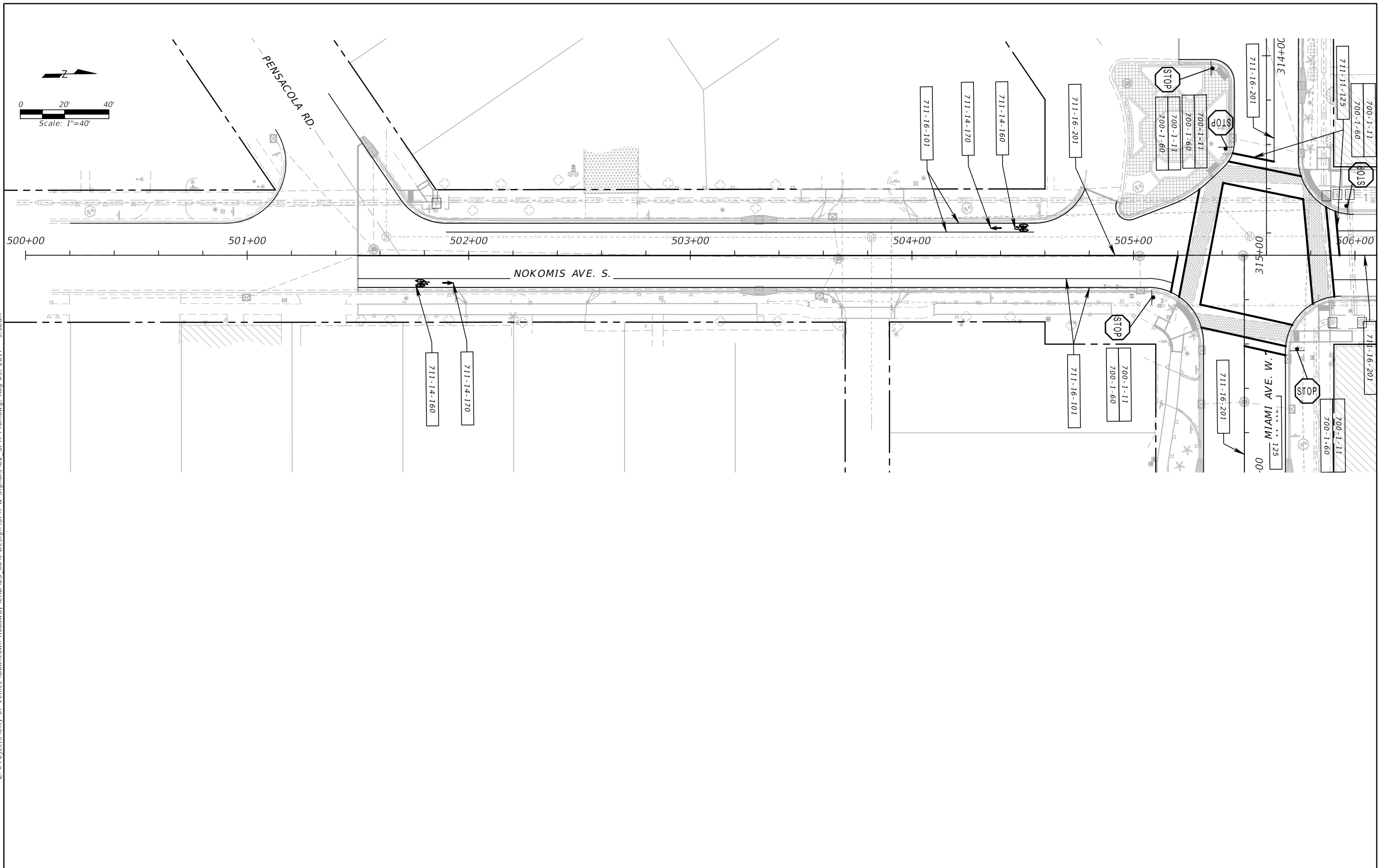

<table border="1"> <tr> <td>DESIGNED</td> <td>ALC</td> </tr> <tr> <td>DRAWN</td> <td>SWC</td> </tr> <tr> <td>CHECKED</td> <td>CRS</td> </tr> </table>			DESIGNED	ALC	DRAWN	SWC	CHECKED	CRS	PREPARED FOR: 	PREPARED BY: 	PROJECT: CITY OF VENICE DOWNTOWN ROADWAY CORRIDOR IMPROVEMENTS	DESCRIPTION: NOKOMIS AVE. SIGNING & PAVEMENT STA.500+00 TO STA.506+00	APPROVED BY: CHRISTOPHER R. SCHULTZ, P.E. FLA. REG. NO 76854 ATKINS NORTH AMERICA (FBPR CA No.24) 482 SOUTH KELLER ROAD ORLANDO, FL 32810-6101	DATE: 8/9/2017 PROJECT NO.: 100054389 SHEET: SPM-12
DESIGNED	ALC													
DRAWN	SWC													
CHECKED	CRS													
REV. NO.	DATE	DESCRIPTION												

Z:\Projects\City Of Venice\Downtown Roadway\CAD\05 60% Design\SPM & Signals\SPM Plan.dwg, Aug 09, 2017 - 9:59am

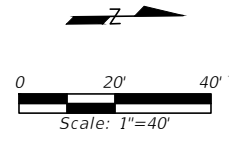
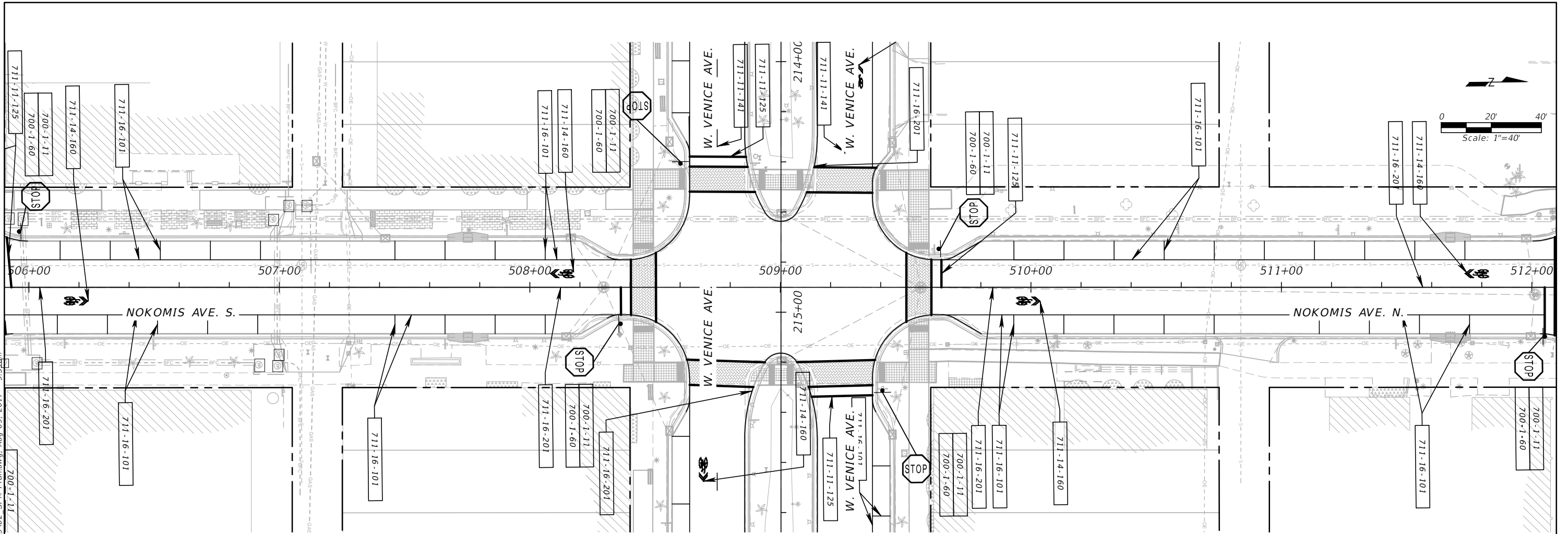

REV. NO.	DATE	DESCRIPTION	DESIGNED	ALC			PROJECT: CITY OF VENICE DOWNTOWN ROADWAY CORRIDOR IMPROVEMENTS	DESCRIPTION: NOKOMIS AVE. SIGNING & PAVEMENT STA.506+00 TO STA.512+00	APPROVED BY: CHRISTOPHER R. SCHULTZ, P.E. FLA. REG. NO 76854 ATKINS NORTH AMERICA (FBPR CA No.24) 482 SOUTH KELLER ROAD ORLANDO, FL 32810-6101	DATE:	8/9/2017
			DRAWN	SWC						PROJECT NO.:	100054389
			CHECKED	CRS						SHEET:	SPM-13

Z:\Projects\City Of Venice\Downtown Roadway\CAD\05_60% Design\SPM & Signals\02_SPM Plan.dwg, Aug 09, 2017 - 10:04am

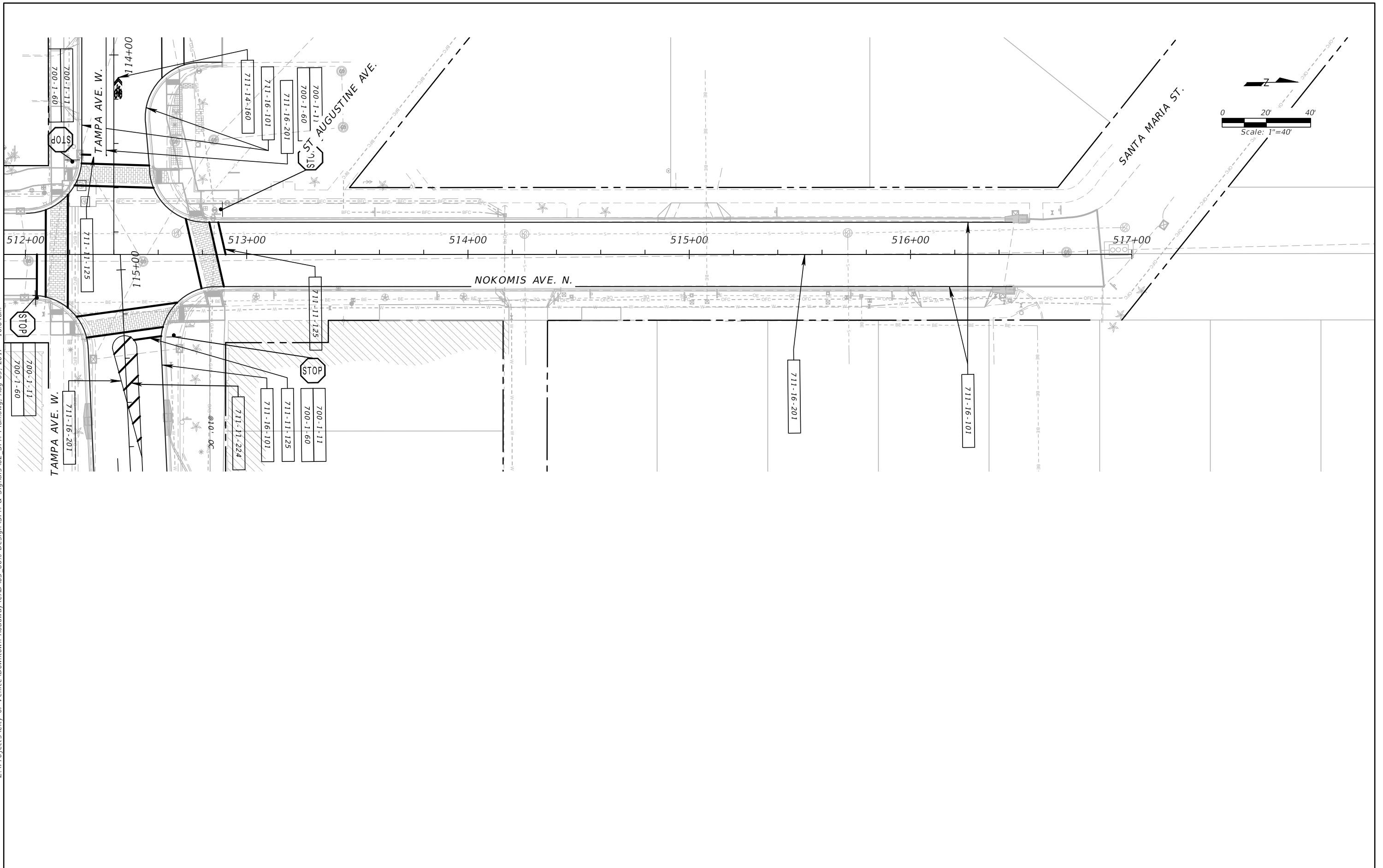

<table border="1"> <tr> <td>DESIGNED</td> <td>ALC</td> </tr> <tr> <td>DRAWN</td> <td>SWC</td> </tr> <tr> <td>CHECKED</td> <td>CRS</td> </tr> </table>			DESIGNED	ALC	DRAWN	SWC	CHECKED	CRS	PREPARED FOR: 	PREPARED BY: 	PROJECT: CITY OF VENICE DOWNTOWN ROADWAY CORRIDOR IMPROVEMENTS	DESCRIPTION: NOKOMIS AVE. SIGNING & PAVEMENT STA.512+00 TO STA.518+00	APPROVED BY: CHRISTOPHER R. SCHULTZ, P.E. FLA. REG. NO 76854 ATKINS NORTH AMERICA (FBPR CA No.24) 482 SOUTH KELLER ROAD ORLANDO, FL 32810-6101	DATE: 8/9/2017 PROJECT NO.: 100054389 SHEET: SPM-14
DESIGNED	ALC													
DRAWN	SWC													
CHECKED	CRS													
REV. NO.	DATE	DESCRIPTION												