

WATER AND SEWER RECORD DRAWINGS PUBLIC TURNOVER/CERTIFICATION FOR

CATALYST HEALTHCARE FACILITY

SECTION 33, TOWNSHIP 38 S, RANGE 19 E
NORTH VENICE, FLORIDA

APRIL 2023

RECORD DRAWINGS
June 22, 2023
APPROVED

GENERAL NOTES:

- ALL CONSTRUCTION TO BE IN ACCORDANCE WITH THE CITY OF VENICE LAND DEVELOPMENT REGULATIONS.
- THE CONTRACTOR SHALL RETAIN ON THE WORK SITE AT ALL TIMES COPIES OF ALL PERMITS NECESSARY FOR CONSTRUCTION.
- THE NORTH AMERICAN VERTICAL DATUM (NAVD) OF 1988 IS THE BENCHMARK DATUM FOR THIS PROJECT. CONVERSION FACTOR: NAVD 1988 + 1.11 FT = NGVD 1929.
- ALL AREAS DESIGNATED AS "PRESERVE OR CONSERVATION" TO BE CLEARLY DELINEATED PRIOR TO CONSTRUCTION.

GENERAL CONSTRUCTION NOTES:

- THERE SHALL BE NO CHANGE OR DEVIATION FROM THESE PLANS UNLESS APPROVED BY THE ENGINEER OR CITY OF VENICE.
- ALL CLEARING AND GRUBBING DEBRIS TO BE BURNED OR REMOVED FROM SITE AND IS PART OF CLEARING AND GRUBBING ITEM.
- IT IS THE INTENT OF THE OWNER THAT CERTAIN TREES BE DESIGNATED TO BE SAVED AND PROTECTED BY THE CONTRACTOR. IT IS ASSUMED THESE TREES ARE HEALTHY AND ARE EXPECTED TO BE PART OF THE LANDSCAPE DEVELOPMENT. THEREFORE, IF ANY TREE(S) DAMAGED BY CONSTRUCTION OPERATION OR BY OTHER MEANS (EXCLUDING LIGHTNING, WINDSTORM AND OTHER ACTS OF GOD) PERISHES WITHIN THE CONSTRUCTION PERIOD, IT WILL BE THE RESPONSIBILITY OF THE CONTRACTOR TO REMOVE AND DISPOSE OF THOSE TREES. NO ADDITIONAL COMPENSATION WILL BE MADE BY THE OWNER FOR THE LABOR, MATERIAL OR MACHINERY REQUIRED TO REMOVE SAID TREES. EXOTIC VEGETATION (E.G., MELALEUCA AND BRAZILIAN PEPPER) EXISTING WITHIN THE PROJECT AREA SHALL BE REMOVED AND PROPERLY DISPOSED OF IN AN APPROVED LANDFILL.
- WHERE EXCAVATIONS ARE IN CLOSE PROXIMITY OF TREES, THE CONTRACTOR SHALL USE EXTREME CARE IN NOT DAMAGING THE ROOT SYSTEM. NO EQUIPMENT, SUPPLIES OR VEHICLES SHALL BE STORED OR PARKED WITHIN THE DRIP LINE OF TREES TO REMAIN AND BE PRESERVED. IT WILL BE THE RESPONSIBILITY OF THE CONTRACTOR TO INFORM ALL OF HIS EMPLOYEES AND SUBCONTRACTORS OF THIS REQUIREMENT AND TO ENFORCE SAME.
- LAY SOD AROUND ALL INLETS, MITERED ENDWALLS, SWALES, LAKE SLOPES, AND TWO FEET (2') WIDE STRIP ADJACENT TO ALL CURBING, AND AS DIRECTED BY THE ENGINEER. ALL PROPOSED GROUND ELEVATIONS ARE FINISHED SOD ELEVATIONS. FINISH EARTHWORK GRADING WILL BE 0.2 FEET BELOW ELEVATIONS SHOWN TO ALLOW FOR SOD THICKNESS. SODDING INCLUDES MAINTAINING SLOPES AND SOD UNTIL COMPLETION AND ACCEPTANCE OF TOTAL PROJECT OR GROWTH IS ESTABLISHED WHICHEVER COMES LAST. ALL EROSION SILTATION AND MAINTAINING GRADES IS THE RESPONSIBILITY OF THE CONTRACTOR UNTIL THEN.
- CALL "SUNSHINE" (1-800-432-4770), COMCAST, FPL, CITY OF VENICE UTILITIES DEPARTMENT, TECO, AND FRONTIER PRIOR TO CONSTRUCTION AND CONNECTION TO EXISTING UTILITIES. IT IS THE CONTRACTOR'S RESPONSIBILITY TO PROTECT EXISTING UTILITIES FROM DAMAGE.
- ALL UTILITY LINES, STORM DRAIN LINES AND ACCESSORIES SUCH AS, BUT NOT LIMITED TO MANHOLES, CLEANOUTS, SEWER AND WATER SERVICES, VALVES, FIRE HYDRANTS AND INLETS WILL BE CONSTRUCTED TO ALIGNMENT AND LOCATIONS SHOWN ON PLANS UNLESS OTHERWISE DIRECTED BY THE ENGINEER.
- CLEARING, GRUBBING, STRIPPING, AND COMPACTION WILL BE INSPECTED BY THE ENGINEER PRIOR TO FILLING.
- PRIOR TO THE START OF CONSTRUCTION ACTIVITIES, CONSERVATION/PRESERVE AREAS, EXISTING LAKES & WATERWAYS WITHIN AND ADJOINING THE AREA OF CONSTRUCTION ACTIVITY SHALL BE PROTECTED BY ERECTION OF TREE PROTECTION BARRICADES AND/OR SILT BARRIERS. TREE PROTECTION BARRICADES SHALL MEET THE STANDARDS OF THE CITY OF VENICE. SILT BARRIERS SHALL BE CONSTRUCTED IN ACCORDANCE WITH THE "BEST MANAGEMENT PRACTICES PLAN" AND THE "BMP DETAILS" OF BOTH TRENDS. BEFORE ANY CIVIL CONSTRUCTION PLANS, THE ENGINEER WILL DETERMINE THE EXTENT AND TYPE OF PROTECTIVE MEASURES TO BE CONSTRUCTED FOR PROTECTION OF CONSERVATION/PRESERVE AREAS. THE ENGINEER SHALL BE NOTIFIED WHEN PRESERVE AREA BARRICADES AND BARRIERS ARE IN PLACE.
- THE SITE CONSTRUCTION STAKEOUT SHALL BE PERFORMED UNDER THE DIRECTION OF A FLORIDA REGISTERED SURVEYOR. AUTOCAD FILES WILL BE FURNISHED TO AID IN THE SITE CONSTRUCTION STAKEOUT. ANY DISCREPANCIES FOUND BETWEEN THE AUTOCAD FILES AND SITE CONSTRUCTION PLANS SHALL BE BROUGHT TO THE ENGINEER'S ATTENTION FOR CLARIFICATION PRIOR TO THAT STAKEOUT.
- ALL DRAINAGE PIPE JOINTS SHALL BE WRAPPED PER FOOT INDEX NO. 280, SHEET 1.
- ROADWAY AND DRAINAGE STRUCTURES SHALL MEET FDOT STANDARD SPECIFICATIONS SECTION 346 OF 3000 PSI CONCRETE.
- THE WETLAND AND ASSOCIATED UPLAND VEGETATIVE BUFFER SHALL BE MAINTAINED IN ACCORDANCE WITH MANAGEMENT GUIDELINES CONTAINED WITHIN THE COMPREHENSIVE PLAN AS A CONSERVATION AREA OR PRESERVE. ALL ACTIVITIES INVOLVING FILLING, EXCAVATING, WELL DRILLING, ALTERING VEGETATION (INCLUDING TRIMMING OF BOTH TREES AND UNDERSTORY) AND STORING OF MATERIALS SHALL BE PROHIBITED WITHIN PRESERVATION AREAS. UNLESS WRITTEN APPROVAL IS FIRST OBTAINED FROM RESOURCE PROTECTION SERVICES TO FACILITATE IMPLEMENTATION OF APPROVED HABITAT MANAGEMENT PLANS OR THE REMOVAL OF NUISANCE/INVASIVE VEGETATION.
- A TREE REMOVAL AND PROTECTION PERMIT WILL BE REQUIRED PRIOR TO ANY CONSTRUCTION, CLEARING OR TREE REMOVAL. ALL WORK PERFORMED SHALL BE IN ACCORDANCE WITH THE CITY OF VENICE CODE.
- EROSION AND SEDIMENT CONTROL BMPs IN ADDITION TO THOSE PRESENTED ON THE PLANS AND OUTLINED IN THE EROSION AND SEDIMENT CONTROL PLAN (ECP), BEST MANAGEMENT PRACTICES (BMP) PLAN, OR STORMWATER POLLUTION PREVENTION PLAN (SWPPP) SHALL BE IMPLEMENTED AS NECESSARY TO PREVENT TURBID DISCHARGES FROM FLOWING ONTO ADJACENT PROPERTIES OR ROADWAYS, OFF SITE STORMWATER CONVEYANCES OR RECEIVING WATERS, OR ON SITE WETLANDS AND SURFACE WATERS. BMPs SHALL BE DESIGNED, INSTALLED, AND MAINTAINED BY THE SITE OPERATOR TO ENSURE THAT OFF SITE SURFACE WATER QUALITY REMAINS CONSISTENT WITH STATE AND LOCAL REGULATIONS. [THE OPERATOR IS THE ENTITY THAT OWNS OR OPERATES THE CONSTRUCTION ACTIVITY AND HAS AUTHORITY TO CONTROL THOSE ACTIVITIES AT THE PROJECT NECESSARY TO ENSURE COMPLIANCE].
- OFFSITE SURFACE WATER DISCHARGES, DISCHARGES TO THE M4, OR DISCHARGES TO ONSITE WETLANDS OR SURFACE WATERS WITH TURBIDITY IN EXCESS OF 29 NEPHELOMETRIC TURBIDITY UNITS (NTU) ABOVE BACKGROUND LEVEL SHALL BE IMMEDIATELY CORRECTED. SUCH INCIDENTS SHALL BE REPORTED TO THE CITY OF VENICE WITHIN 24 HOURS OF THE OCCURRENCE. THE REPORT SHALL INCLUDE THE CAUSE OF THE DISCHARGE AND CORRECTIVE ACTIONS TAKEN.
- FUEL AND OTHER PETROLEUM PRODUCT SPILLS THAT ENTER STORMWATER DRAINS OR WATERBODIES, OR FUEL AND OTHER PETROLEUM PRODUCT SPILLS THAT ARE IN EXCESS OF 25 GALLONS SHALL BE CONTAINED, CLEANED UP, AND IMMEDIATELY REPORTED TO THE CITY OF VENICE. SMALLER GROUND SURFACE SPILLS SHALL BE CLEANED UP AS SOON AS PRACTICAL.
- IF CONTAMINATED SOIL AND/OR GROUNDWATER IS DISCOVERED DURING DEVELOPMENT OF THE SITE, ALL ACTIVITY IN THE VICINITY OF THE CONTAMINATION SHALL IMMEDIATELY CEASE, AND THE CITY OF VENICE SHALL BE CONTACTED.
- FERTILIZER APPLICATION SHALL BE CONSISTENT WITH THE CITY OF VENICE CODE.
- NATIONAL POLLUTANT DISCHARGE ELIMINATION SYSTEM - STORMWATER:
 - NPDES CONSTRUCTION GENERIC PERMIT COVERAGE SHALL BE OBTAINED AT LEAST 48 HOURS IN ADVANCE OF CONSTRUCTION COMMENCEMENT IN ACCORDANCE WITH RULE 62-421.300(4)(A), F.A.C.
 - A COPY OF THE CERTIFIED NPDES NOI, OR A COPY OF THE FDEP COVERAGE CONFIRMATION LETTER SHALL BE POSTED AT THE SITE IN ACCORDANCE WITH RULE 62-421.300(4)(A)PART III.C.2, F.A.C.
 - A COPY OF THE CERTIFIED NPDES NOI, OR A COPY OF THE FDEP COVERAGE CONFIRMATION LETTER SHALL BE PROVIDED TO AIR AND WATER QUALITY IN ACCORDANCE WITH RULE 62-421.300(4)(A)PART III.D.1, F.A.C.
 - THE SWPPP SHALL BE CERTIFIED IN ACCORDANCE WITH RULE 62-421.300(4)(A)PART V.D.6, F.A.C. AND A COPY OF THE CERTIFIED DOCUMENT SHALL BE SUBMITTED TO AIR AND WATER QUALITY AT LEAST 48 HOURS PRIOR TO THE COMMENCEMENT OF CONSTRUCTION.
 - A COPY OF THE SWPPP, AND COPIES OF THE INSPECTION AND MAINTENANCE RECORDS SHALL BE MAINTAINED AT THE PROJECT SITE, AND SHALL BE READILY AVAILABLE TO STATE INSPECTORS.
 - NATIONAL POLLUTANT DISCHARGE ELIMINATION SYSTEM - DEWATERING:
THE DISCHARGE OF GROUNDWATER PRODUCED THROUGH DEWATERING, TO SURFACE WATERS, OR TO ANY PORTION OF THE M4 WILL REQUIRE SEPARATE PERMITTING FROM THE DEP. PERMITS SHALL BE OBTAINED PRIOR TO THE COMMENCEMENT OF DEWATERING. ANALYTICAL RESULTS FROM PRE-DISCHARGE TESTING SHALL BE PROVIDED TO AIR AND WATER QUALITY.
- THE CONTRACTOR SHALL ENSURE THAT ADJACENT PROPERTIES ARE NOT IMPACTED BY WIND EROSION OR EMISSIONS OF UNCONFINED PARTICULATE MATTER IN ACCORDANCE WITH RULE 62-236.520(9)(c)1, FLORIDA ADMINISTRATIVE CODE, FROM THE CONSTRUCTION SITE BY TAKING ADEQUATE MEASURES TO STABILIZE AFFECTED AREAS.
- DEPARTMENT OF ENVIRONMENTAL PROTECTION WATER AND WASTEWATER PERMITS ARE REQUIRED.
- ANY WELLS DISCOVERED ON SITE THAT WILL HAVE NO USE MUST BE PLUGGED BY A LICENSED WELL DRILLING CONTRACTOR IN AN APPROVED MANNER.
- IN THE EVENT THAT THE CONSTRUCTION SITE IS ABANDONED PRIOR TO THE PROJECT COMPLETION, ALL CONSTRUCTION AND VEGETATIVE DEBRIS SHALL BE REMOVED FROM THE SITE AND DISPOSED OF AT AN APPROVED LANDFILL FACILITY.
- A SEPARATE BUILDING PERMIT MUST BE APPLIED FOR AND ISSUED FOR EVERY SIGN, WALL, OUTDOOR LIGHTING AND STRUCTURE ON THE SITE. THE APPROVAL OF THESE CONSTRUCTION PLANS DOES NOT EXEMPT THE CONTRACTOR FROM OBTAINING THE NECESSARY BUILDING PERMITS.

CITY OF VENICE REQUIRED NOTES:

- ALL WORK CONDUCTED IN THE CITY OF VENICE RIGHT-OF-WAY (ROW) WILL REQUIRE THE ISSUANCE OF A ROW PERMIT.
- ALL WORK CONDUCTED IN SARASOTA COUNTY AND/OR FDOT ROW SHALL REQUIRE A COPY OF STATE ISSUED PERMITS.
- TREE REMOVAL PERMIT MUST BE OBTAINED FROM THE CITY OF VENICE.
- POST DEVELOPMENT RUNOFF DOES NOT EXCEED PRE-DEVELOPMENT RUNOFF VOLUME OR RATE FOR A 24-HOUR, 25-YEAR STORM EVENT.
- ALL FIRE SERVICE BACKFLOW ASSEMBLIES SHALL BE INSTALLED BY A CERTIFIED CONTRACTOR WITH A CLASS I, II, OR V CERTIFICATE OF COMPETENCY ISSUED BY THE STATE FIRE MARSHAL AS PER F.S. 633.521.
- CONSTRUCTION SITE MUST BE POSTED WITH 24-HOUR CONTACT INFORMATION.
- ALL UTILITIES, WHETHER PUBLIC OR PRIVATE, SHALL MEET CITY OF VENICE STANDARDS.
- CONTACT PUBLIC WORKS SOLID WASTE DIVISION (941-486-2422) FOR APPROVAL OF DUMPSTER LOCATION AND LAYOUT PRIOR TO CONSTRUCTION.
- CONSTRUCTION PLAN APPROVAL WILL NOT BE ISSUED UNTIL CONSTRUCTION PLANS FOR THE REQUIRED CURRY LANE ROADWAY AND UTILITY IMPROVEMENTS HAVE BEEN APPROVED.



Sheet List Table	
Sheet Number	Sheet Title
A-1	COVER SHEET
A-2	GENERAL NOTES
A-3	AERIAL SITE PLAN
A-4	EXISTING CONDITIONS PLAN
A-5	DEMOLITION PLAN
A-6	SITE PLAN
A-7	BEST MANAGEMENT PRACTICES PLAN
A-8	BEST MANAGEMENT PRACTICES DETAILS
A-9	PAVING GRADING AND DRAINAGE PLAN
A-10	CITY OF VENICE PAVING AND SIDEWALK DETAILS
A-11	STORMWATER DETAILS
A-12	SMALL CONTROL STRUCTURE DETAILS
A-13	MISCELLANEOUS DETAILS
A-14	ADS DETAILS
A-15	ADS DETAILS
A-16	ADS DETAILS
A-17	SECTION DETAILS
C-1	UTILITY PLAN
C-2A	CITY OF VENICE UTILITY DETAILS
C-2B	CITY OF VENICE UTILITY DETAILS

DEVELOPER: CAH DEVELOPMENTS, LLC
41 N JEFFERSON ST. 4TH FLOOR
PENSACOLA, FL 32502
PH: 850-607-6069
CONTACT: PHIL SHUCK

ARCHITECT: ACI BOLAND ARCHITECTS
1710 WYANDOTTE STREET
KANSAS CITY, MO 64108
PH: 816-595-9506
CONTACT: BRANDAN SMITH, AIA

ENGINEER AND LANDSCAPE ARCHITECTURE:
KIMLEY HORN AND ASSOCIATES, INC.
1777 MAIN STREET, SUITE 200
SARASOTA, FL 34236
PH: (941)379-7600
CONTACT: KYLE C. KRAGEL, P.E.

SURVEYOR: BRITT SURVEYING, INC.
606 CYPRESS AVENUE
VENICE, FL 34285
PH: (941) 493-1396
CONTACT: RANDALL E. BRITT, PSM

PREPARED BY
Kimley»Horn

© 2021 KIMLEY-HORN AND ASSOCIATES, INC.
1777 MAIN STREET, Suite 200, Sarasota, FL 34236
PHONE (941) 379-7600
WWW.KIMLEY-HORN.COM CA 00000696

UTILITY COMPANIES:

FPL
5657 NORTH McINTOSH ROAD
SARASOTA, FLORIDA 34233

TECO GAS
8261 VICO COURT
SARASOTA, FLORIDA 34240-7844

FRONTIER
1701 RINGLING BLVD.
SARASOTA, FLORIDA 34236
941-906-6711

VENICE UTILITIES
401 W. VENICE AVE.
VENICE, FL 34285
(941)882-7297
CONTACT: PATIENCE ANATASIO

LAND USE DEVELOPMENT DATA

PARCEL AREA: 5.0 ACRES
PRESENT ZONING: OUE - OPEN USE ESTATE
ABUTTING ZONING: WEST: OUE - OPEN USE ESTATE
EAST: OUE - OPEN USE ESTATE
NORTH: PCD - PLANNED COMMERCIAL DISTRICT
SOUTH: PRIVATE RIGHT-OF-WAY (CURRY LANE)

PROPOSED ZONING: OPI - OFFICE, PROFESSIONAL AND INSTITUTIONAL

PROJECT ADDRESS: 2705 CURRY LANE
NORTH VENICE, FL 34275

PID: 0387120004

PROJECT AREA: 5.0 ACRES

PROPOSED NUMBER OF BEDS: 42 BEDS
PROPOSED BUILDING AREA: 48,600 SQFT (1.2 ACRES)
PROPOSED FLOOR AREA RATIO (FAR): 22.4% (1.12 ACRES/5.00 ACRES)

PROPOSED LAND USE:		
BUILDING (HEALTHCARE FACILITY)	1.12 ACRES	(22.4%)
ROADS AND PARKING	1.56 ACRES	(31.2%)
SIDEWALK	0.35 ACRES	(7.0%)
PERVIOUS AREA	1.97 ACRES	(39.4%)
TOTAL AREA	5.0 ACRES	(100%)

BUILDING SETBACKS: FRONT : 50"
SIDE : 50"
REAR : 50"
*PER CODE SEC. 86-90(b)(2) - HOSPITALS SHALL HAVE NO BUILDING CLOSER THAN 50 FEET TO THE LOT LINE OF ANY ADJOINING PROPERTY

MAXIMUM BUILDING HEIGHT: 35'
PROPOSED BUILDING HEIGHT: 23'-3.25"
MAXIMUM LOT COVERAGE BY BUILDINGS: 30%
PROPOSED LOT COVERAGE BY BUILDINGS: 22.4% (1.12 ACRES / 5.0 ACRES)

RECLAIMED WATER: PROVIDED BY CITY OF VENICE.
WATER: POTABLE WATER SUPPLY WILL BE FROM CITY OF VENICE UTILITIES.
SEWER: WASTEWATER SERVICES WILL BE PROVIDED BY CITY OF VENICE UTILITIES.
GARBAGE: GARBAGE PICKUP WILL BE PROVIDED BY CITY OF VENICE.
ROADWAYS: ACCESS TO THIS PROJECT IS PROVIDED FROM CURRY LANE.
PARKING LOT: TO BE PRIVATELY MAINTAINED.

LOADING ZONES REQUIRED:
PER CODE SEC. 86-422(D)(3) AGGREGATE AREA OF OVER 40,000 SQUARE FEET: ONE SPACE PLUS ONE SPACE FOR EACH ADDITIONAL 60,000 SQUARE FEET OVER 40,000 SQUARE FEET OR MAJOR FRACTION THEREOF.
48,600 SQUARE FEET PROPOSED = 2 SPACES REQUIRED

LOADING ZONES PROVIDED:
2 SPACES PROVIDED (SEE SHEET A-6)

TREE LOCATION: THE PROPOSED DEVELOPMENT AND ITS ORIENTATION TO THE EXISTING TREES IS SHOWN ON THE AERIAL PHOTOGRAPH. TREES WILL BE PRESERVED WHERE POSSIBLE. TREE REMOVAL PERMIT WILL BE APPLIED FOR PRIOR TO CONSTRUCTION.

FEMA DESIGNATION:
NOTE: THE SUBJECT PROPERTY LIES IN FLOOD ZONE "X". BASE FLOOD ELEVATION NOT DETERMINED PER FLOOD INSURANCE RATE MAP FOR SARASOTA COUNTY, FLORIDA, COMMUNITY NO. 1211500243F, DATED NOVEMBER 4, 2016, AND ISSUED BY THE FEDERAL EMERGENCY MANAGEMENT AGENCY.
FEMA DATUM IS NORTH AMERICAN VERTICAL DATUM 1988 (NAVD 88).

ENVIRONMENTAL AND SURFACE WATER MANAGEMENT SYSTEM:
DRAINAGE SYSTEM WILL BE PRIVATELY MAINTAINED.

WELLS: THERE ARE NO KNOWN WELLS WITHIN PROJECT BOUNDARY.

IMPERVIOUS/PERVIOUS AREAS:	ACRES	PERCENTAGE
IMPERVIOUS AREA:	2.83	56.52%
PERVIOUS AREA:	2.17	43.48%
TOTAL:	5.0	100%

ADA: ALL SIDEWALK STREET CROSSINGS AT CURBS, GUTTERS AND INTERSECTIONS SHALL COMPLY WITH THE AMERICANS WITH DISABILITIES ACT AND FLORIDA ACCESSIBILITY CODE.

LANDSCAPE PLANS: INCLUDED WITH THIS SUBMITTAL.

TREE MITIGATION PLANS: TO BE SUBMITTED ONCE TREE SURVEY IS COMPLETE.

REQUIRED PARKING CALCULATION:
HOSPITALS: 1.5 SPACES PER BED
TOTAL REQUIRED PARKING SPACES = 1.5 SPACES/BED * 42 BEDS = 63 TOTAL SPACES REQUIRED (2 ADA)

PARKING SPACES PROVIDED:
PROVIDED PARKING SPACES = 128 SPACES PROVIDED (9 ADA)

I HEREBY CERTIFY THAT THE DESIGN OF THIS PROJECT, AS PREPARED UNDER MY PERSONAL DIRECTION AND CONTROL, COMPLIES WITH ALL APPLICABLE STANDARDS, INCLUDING THE "MANUAL OF UNIFORM MINIMUM STANDARDS FOR DESIGN, CONSTRUCTION AND MAINTENANCE FOR STREETS AND HIGHWAYS" AS ADOPTED BY THE FLORIDA DEPARTMENT OF TRANSPORTATION PURSUANT TO SUBSECTIONS 335.075(1) AND (4), FLORIDA STATUTES.

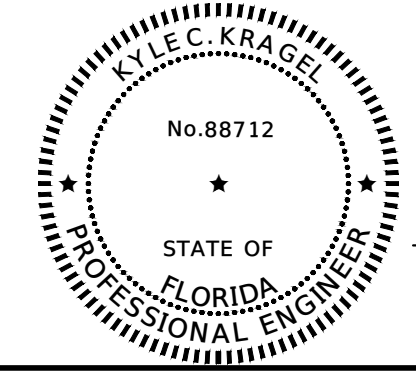

Kyle C. Kragel
KYLE C. KRAGEL, P.E.
FLA. P.E. LICENSE # 88712
CA. NO. 00000696

DATE:

This document, together with the concepts and designs presented herein, is intended only for the specific purpose and client for which it was prepared. Reuse of and improper reliance on this document without written authorization and adaptation by Kimley-Horn and Associates, Inc. shall be without liability to Kimley-Horn and Associates, Inc.

Plotted By: Bunde, Nick - Sheet Set: Catalyst HC Curry Lane - Layout: C-2A - CITY OF VENICE UTILITY DETAILS - September 23, 2021 - 08:09:43am - K:\NSAR-Civil\04-3480000 - Catalyst HC Curry Lane\CAD\PlanSheets\C-2A - CITY OF VENICE UTILITY DETAILS.dwg
 This document, together with the concepts and designs presented herein, is intended only for the specific purpose and client for which it was prepared. Reuse of and improper reliance on this document without written authorization and adaptation by Kimley-Horn and Associates, Inc. shall be without liability to Kimley-Horn and Associates, Inc.

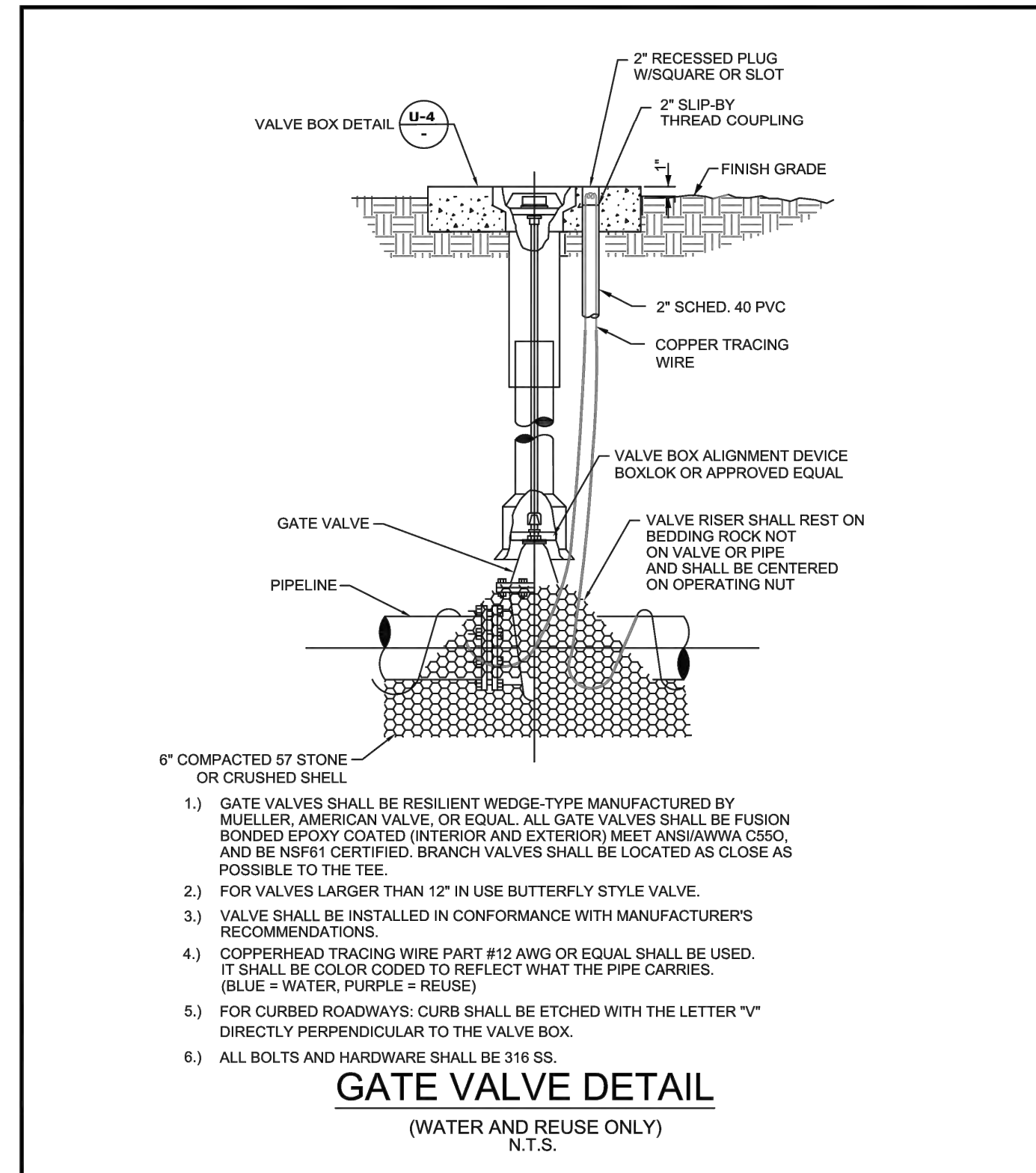

CITY OF VENICE ENGINEERING DEPARTMENT 401 WEST VENICE AVE. VENICE FL 34285 (941) 486-2626 FAX (941) 480-3031	UTILITIES - WATER	DATE JAN 2021
	GATE VALVE	SHEET NO. W-1

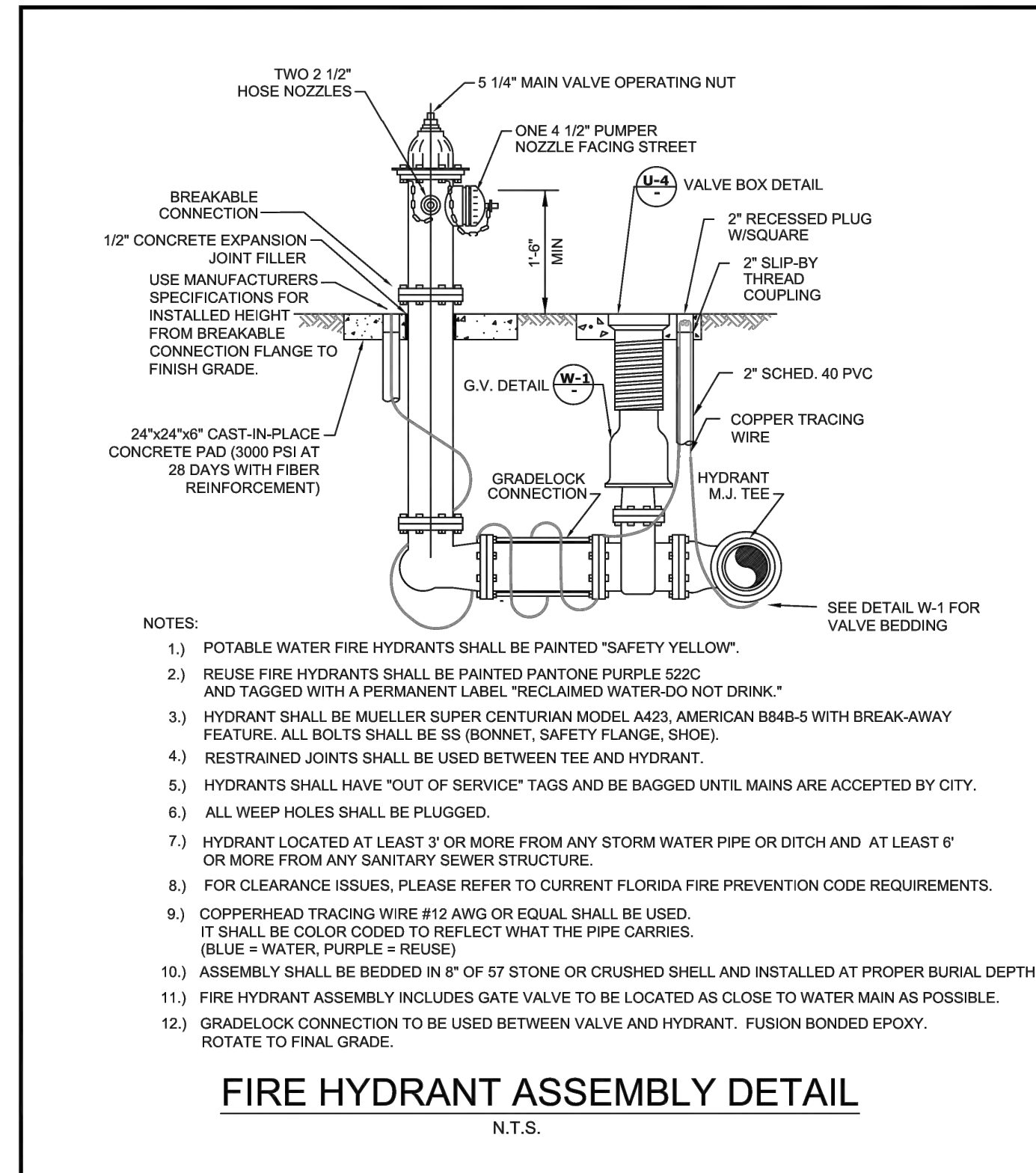

CITY OF VENICE ENGINEERING DEPARTMENT 401 WEST VENICE AVE. VENICE FL 34285 (941) 486-2626 FAX (941) 480-3031	UTILITIES - WATER	DATE JAN 2021
	FIRE HYDRANT ASSEMBLY	SHEET NO. W-2

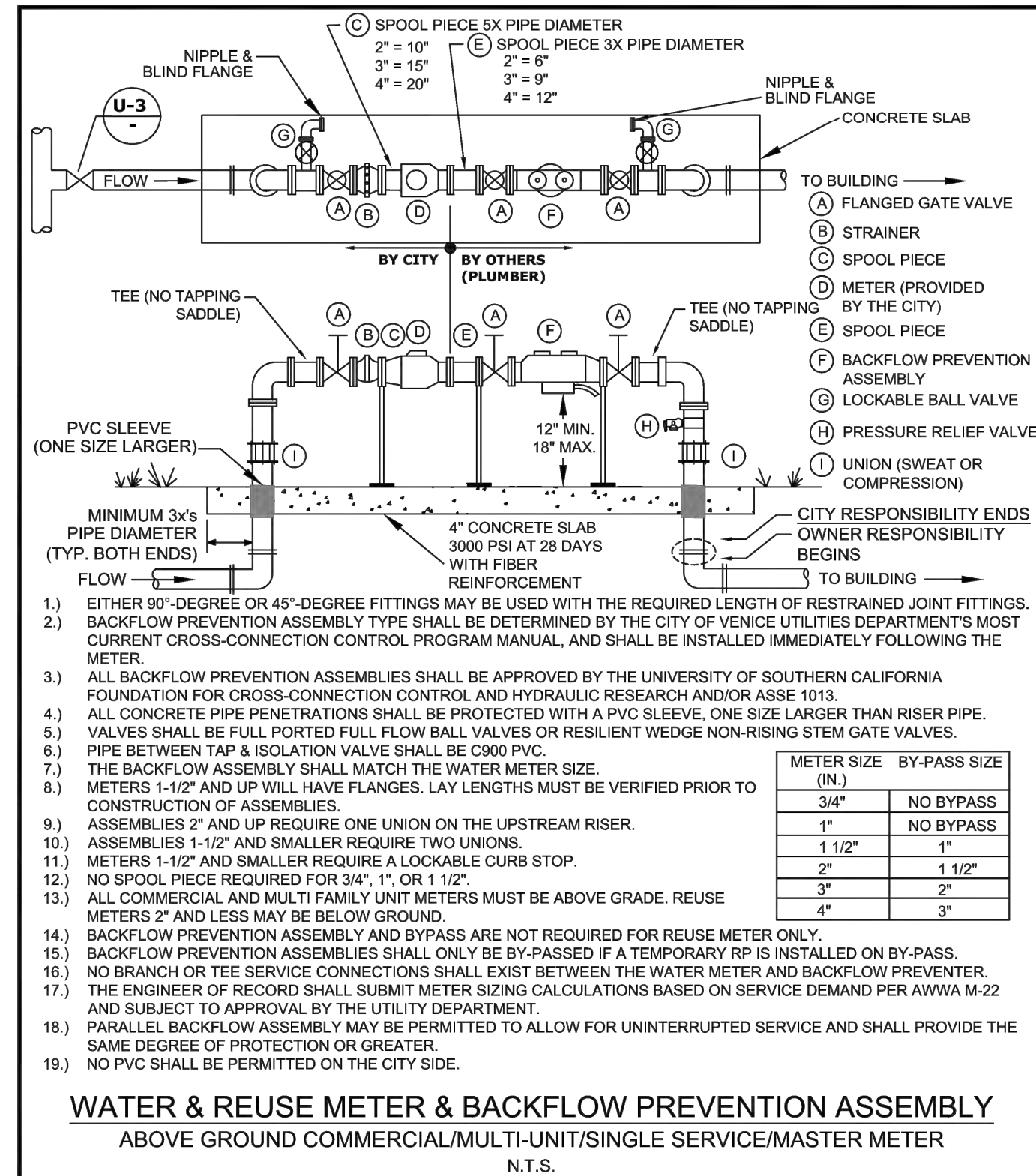

CITY OF VENICE ENGINEERING DEPARTMENT 401 WEST VENICE AVE. VENICE FL 34285 (941) 486-2626 FAX (941) 480-3031	UTILITIES - WATER	DATE JAN 2021
	WATER & REUSE METER & BACKFLOW	SHEET NO. W-4

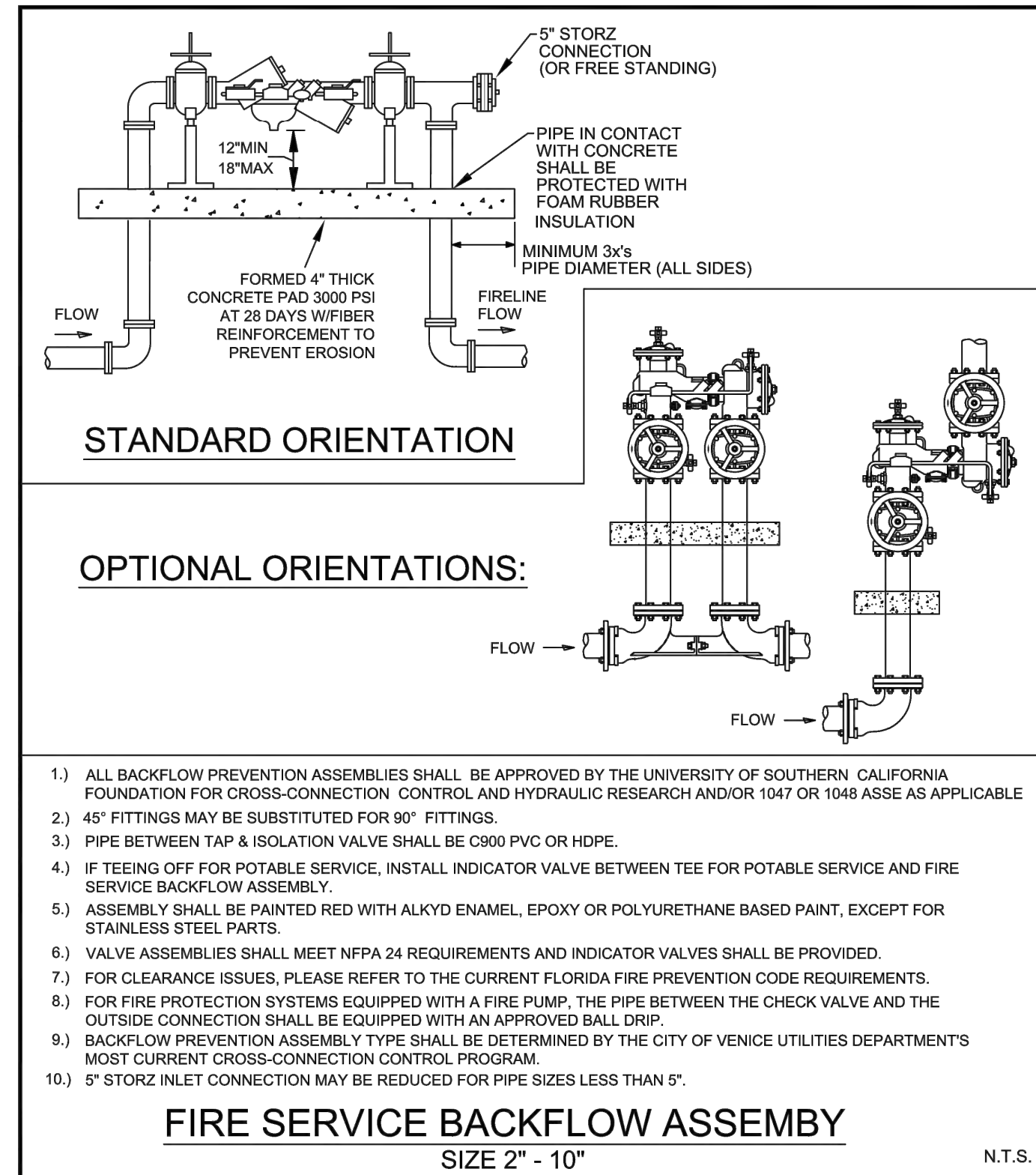

CITY OF VENICE ENGINEERING DEPARTMENT 401 WEST VENICE AVE. VENICE FL 34285 (941) 486-2626 FAX (941) 480-3031	UTILITIES - WATER	DATE JAN 2021
	FIRE SERVICE BACKFLOW ASSEMBLY	SHEET NO. W-9

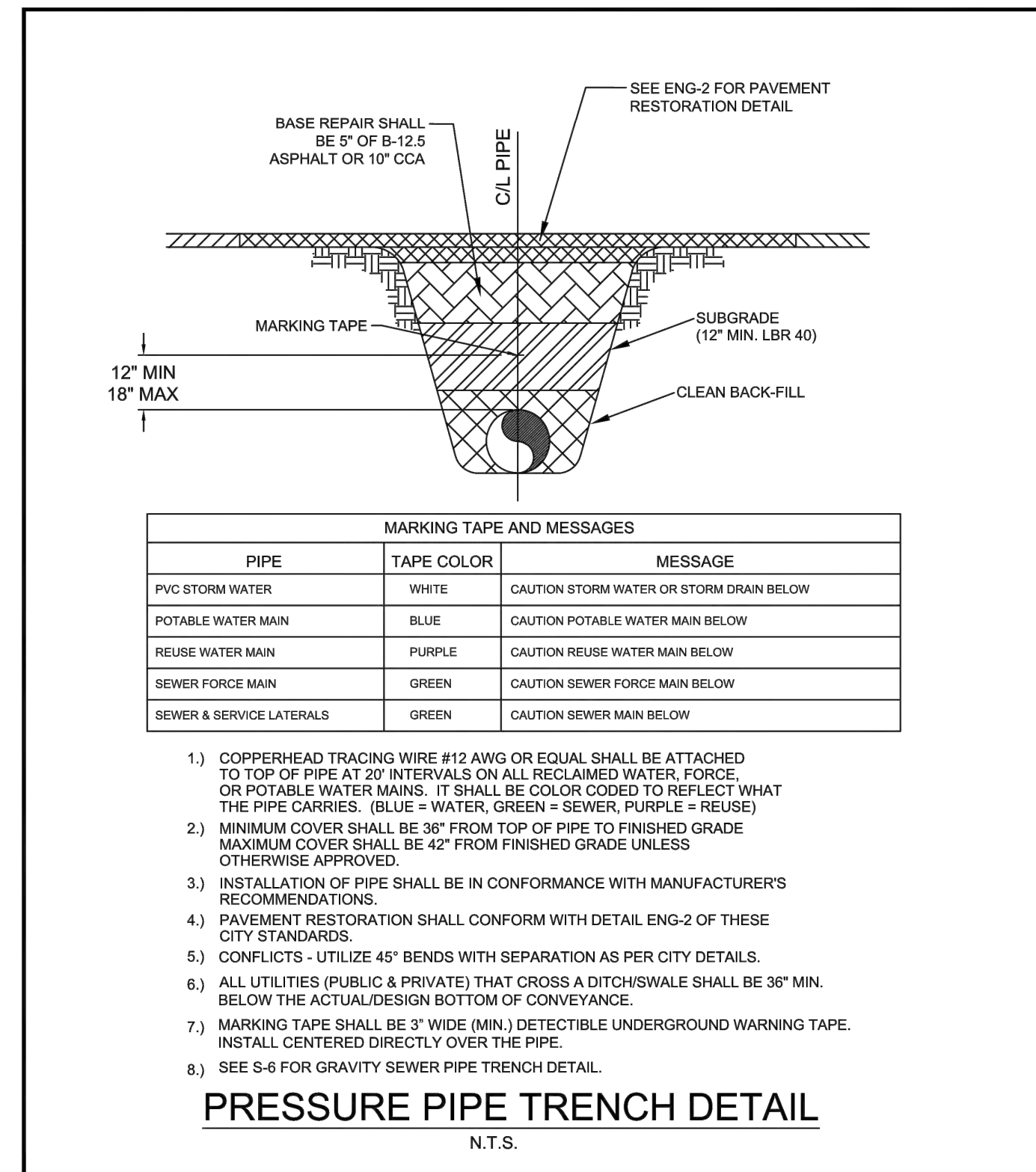

CITY OF VENICE ENGINEERING DEPARTMENT 401 WEST VENICE AVE. VENICE FL 34285 (941) 486-2626 FAX (941) 480-3031	UTILITIES - GENERAL	DATE JAN 2021
	UTILITY PIPE TRENCH	SHEET NO. U-1

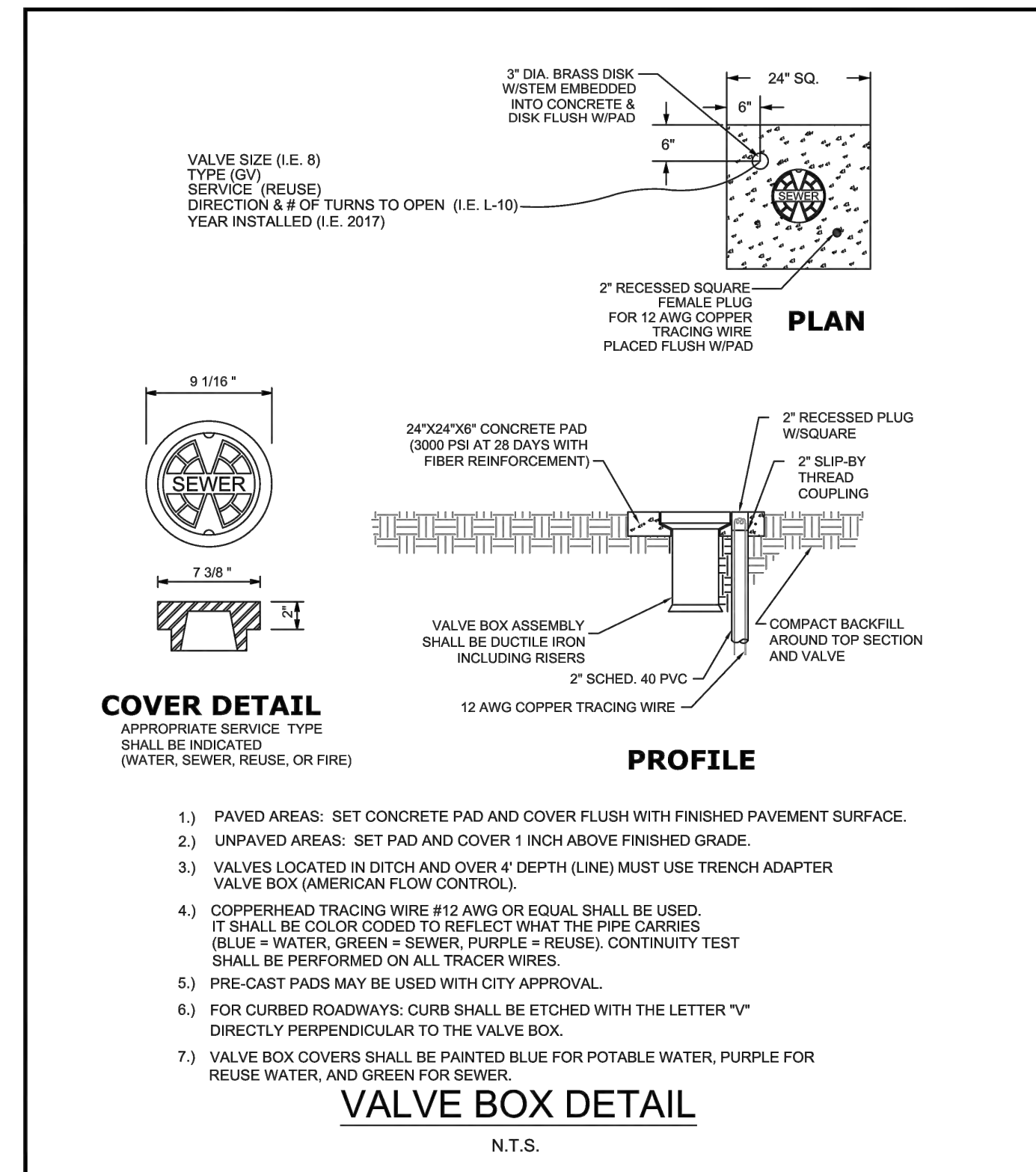

CITY OF VENICE ENGINEERING DEPARTMENT 401 WEST VENICE AVE. VENICE FL 34285 (941) 486-2626 FAX (941) 480-3031	UTILITIES - GENERAL	DATE JAN 2021
	VALVE BOX	SHEET NO. U-4

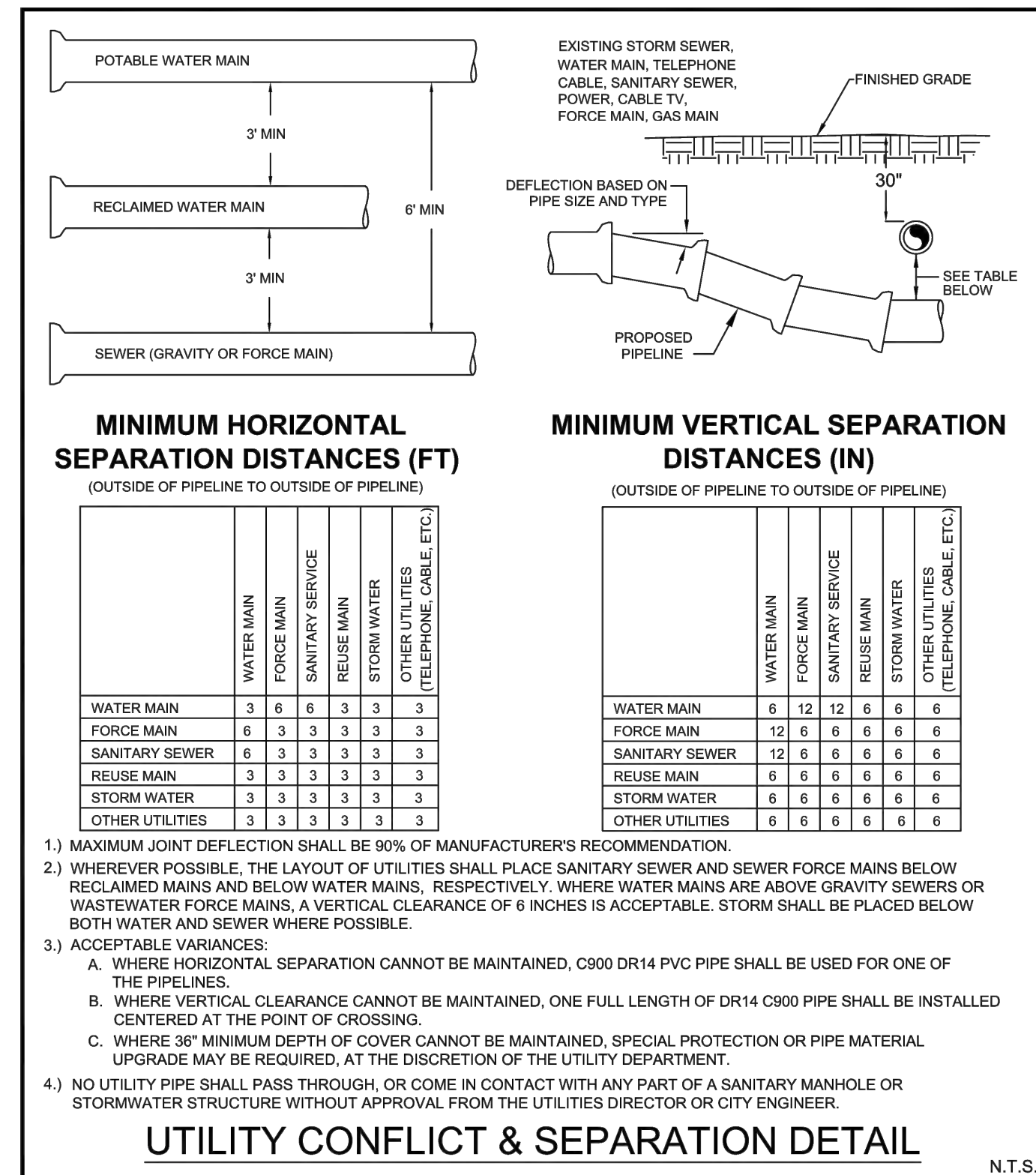

CITY OF VENICE ENGINEERING DEPARTMENT 401 WEST VENICE AVE. VENICE FL 34285 (941) 486-2626 FAX (941) 480-3031	UTILITIES - GENERAL	DATE JAN 2021
	UTILITY CONFLICTS & SEPARATIONS	SHEET NO. U-5

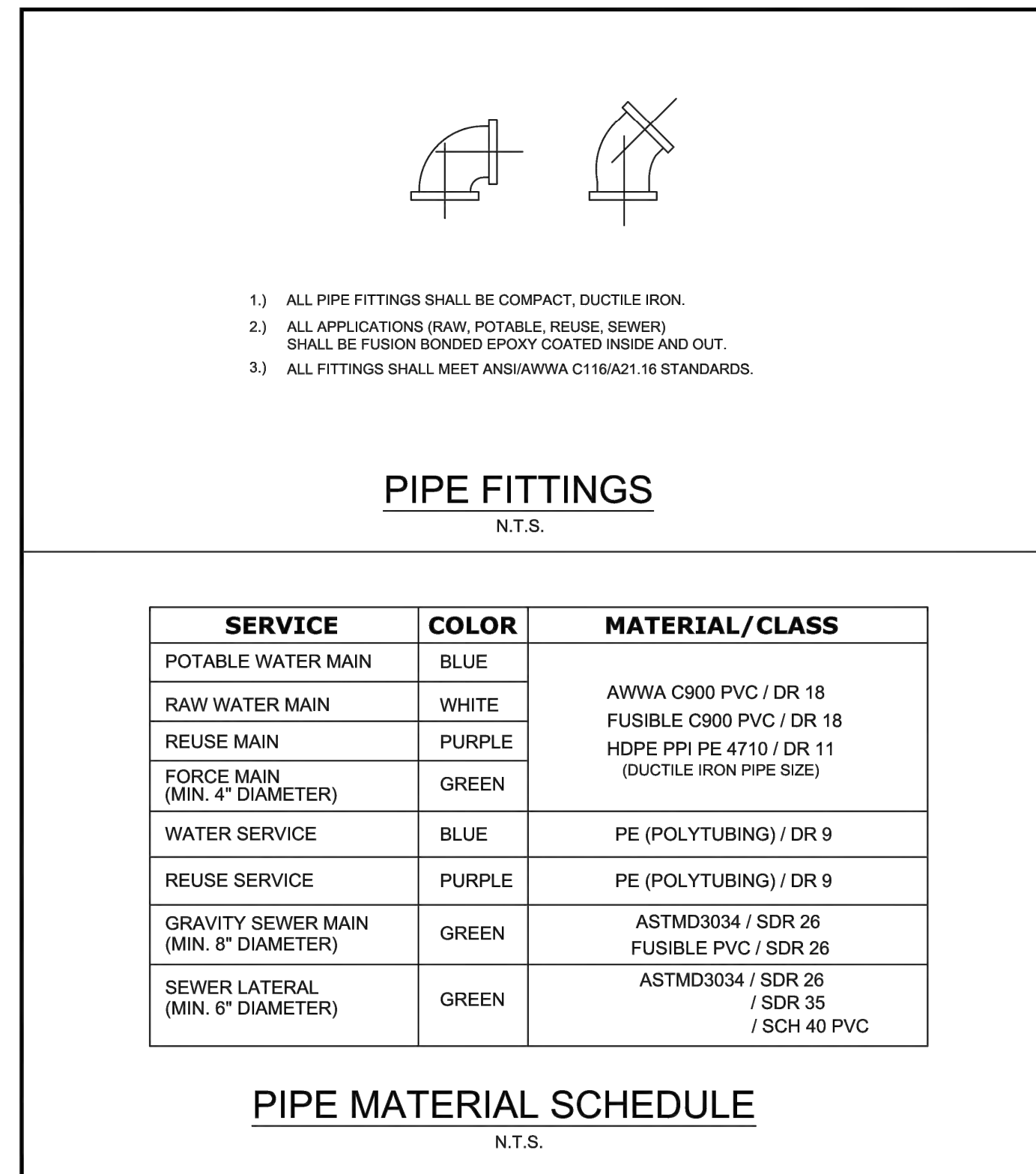

CITY OF VENICE ENGINEERING DEPARTMENT 401 WEST VENICE AVE. VENICE FL 34285 (941) 486-2626 FAX (941) 480-3031	UTILITIES - GENERAL	DATE JAN 2021
	PIPE FITTINGS & MATERIAL	SHEET NO. U-6

RECORD DRAWINGS
June 22, 2023
APPROVED

Kimley-Horn
 1777 MAIN STREET, SUITE 200, SARASOTA, FL 34236
 PHONE: 941-379-7600
 WWW.KIMLEY-HORN.COM REGISTRY NO. 696

CITY OF VENICE HEALTHCARE FACILITY
 PREPARED FOR
CAH DEVELOPMENTS, LLC
 CITY OF VENICE, FLORIDA

KHA PROJECT 043490000
 DATE SEPTEMBER 2022
 SCALE 2x AS SHOWN
 DESIGNED BY [Signature]
 DRAWN BY [Signature]
 CHECKED BY [Signature] DATE: 04/11/2023

SHEET NUMBER
C-2A

Plotted By: Runo, Nick - Sheet Set: Catalyst HC Curry Lane - Layout: C-2B CITY OF VENICE UTILITY DETAILS - September 23, 2021 - 08:00:55am - K:\SAR-Civil\043490000 - Catalyst HC Curry Lane\CAD\PlanSheets\C-2B CITY OF VENICE UTILITY DETAILS.dwg
This document, together with the concepts and designs presented herein, is intended only for the specific purpose and client for which it was prepared. Reuse of and improper reliance on this document without written authorization and adaptation by Kimley-Horn and Associates, Inc. shall be without liability to Kimley-Horn and Associates, Inc.

MINIMUM LENGTH (FT) OF FORCE MAIN TO BE RESTRAINED ON EACH SIDE OF FITTING										
FITTING	PIPE SIZE (INCHES)									
	4	6	8	10	12	16	18	24		
45 BEND:	H	6	9	12	14	16	21	23	25	29
	VU	4	6	7	9	10	13	15	16	19
	VD	12	20	26	32	37	48	53	28	68
22.5 BEND:	H	3	4	6	7	8	10	11	12	14
	VU	2	3	4	4	5	6	7	8	9
	VD	7	10	13	15	18	23	26	28	33
11.25 BEND:	H	2	2	3	3	4	5	5	6	7

MINIMUM LENGTH (FT) OF WATER OR REUSE MAIN TO BE RESTRAINED ON EACH SIDE OF FITTING										
FITTING	PIPE SIZE (INCHES)									
	4	6	8	10	12	16	18	24		
90 BEND:	H	23	33	43	51	60	76	83	90	104
	VU	10	14	18	21	25	31	34	37	43
	VD	6	8	11	13	16	20	22	24	28
22.5 BEND:	H	5	7	8	10	12	15	17	18	21
	VU	3	4	5	6	7	10	11	12	14
	VD	10	15	19	23	27	35	38	42	49
11.25 BEND:	H	2	3	4	5	6	7	8	9	10

PLUGS:

PIPE SIZE (INCHES)	4	6	8	10	12	16	18	24	
PLUGS:	52	73	96	115	136	174	193	211	246

ABBREVIATIONS: H=HORIZONTAL, VU=VERTICAL UP, VD=VERTICAL DOWN.

- FOR TEE OR REDUCER FITTINGS SUBMIT RESTRAINED JOINT LENGTH CALCULATIONS TO CITY ENGINEER FOR REVIEW AND APPROVAL, USING THE ASSUMPTIONS LISTED ABOVE.
- RESTRAINED JOINT LENGTH FOR WATER AND REUSE MAINS BASED ON TEST PRESSURE OF 150 PSI. RESTRAINED JOINT LENGTH FOR FORCE (SEWER) MAINS BASED ON TEST PRESSURE OF 100 PSI. CALCULATIONS WERE MADE USING EBAA IRON SOFTWARE (AVAILABLE AT WWW.EBAA.COM) AND THE FOLLOWING ASSUMPTIONS: GRANULAR MATERIAL (GM) SOIL TYPE, TRENCH TYPE 3, BURIED DEPTH OF 3 FT, AND SAFETY FACTOR OF 2 TO 1. IF FIELD CONDITIONS DIFFER FROM ABOVE ASSUMPTIONS EOR SHALL PROVIDE CALCULATIONS BASED ON ACTUAL CONDITIONS.
- RESTRAINED JOINT SHALL BE USED ON ALL JOINTS FROM ANY MAIN TEE TO ANY FIRE HYDRANT ASSEMBLY.
- THRUST BLOCKS WILL NOT BE ACCEPTED, UNLESS OTHERWISE APPROVED BY THE CITY ENGINEER.
- ALL HARDWARE SHALL BE 316 SS.

PRESSURE MAIN RESTRAINED JOINT TABLE

N.T.S.

	CITY OF VENICE ENGINEERING DEPARTMENT 401 WEST VENICE AVE. VENICE FL 34285 (941) 489-2626 FAX (941) 480-3031	UTILITIES - GENERAL RESTRAINED JOINT TABLE	DATE JAN 2021 SHEET NO. U-7
---	--	---	---

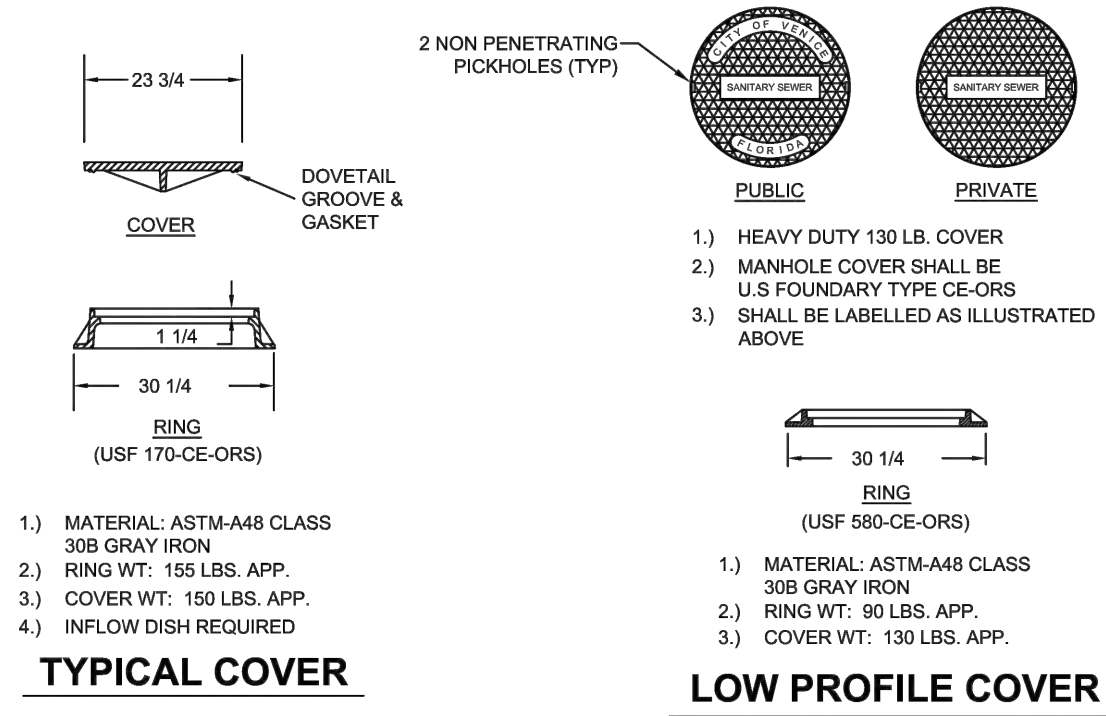
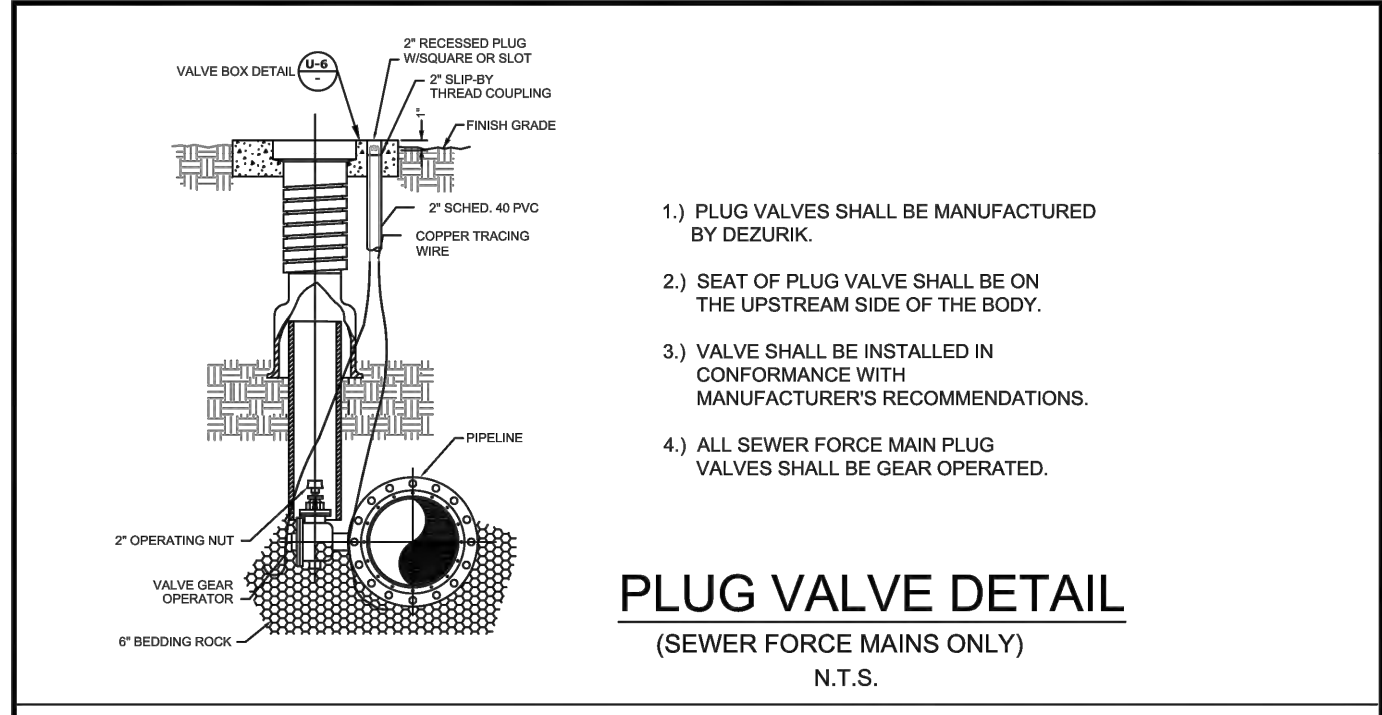

MANHOLE COVERS DETAIL

N.T.S.

	CITY OF VENICE ENGINEERING DEPARTMENT 401 WEST VENICE AVE. VENICE FL 34285 (941) 489-2626 FAX (941) 480-3031	UTILITIES - SEWER PLUG VALVE & MANHOLE COVERS	DATE JAN 2021 SHEET NO. S-1
---	--	--	---

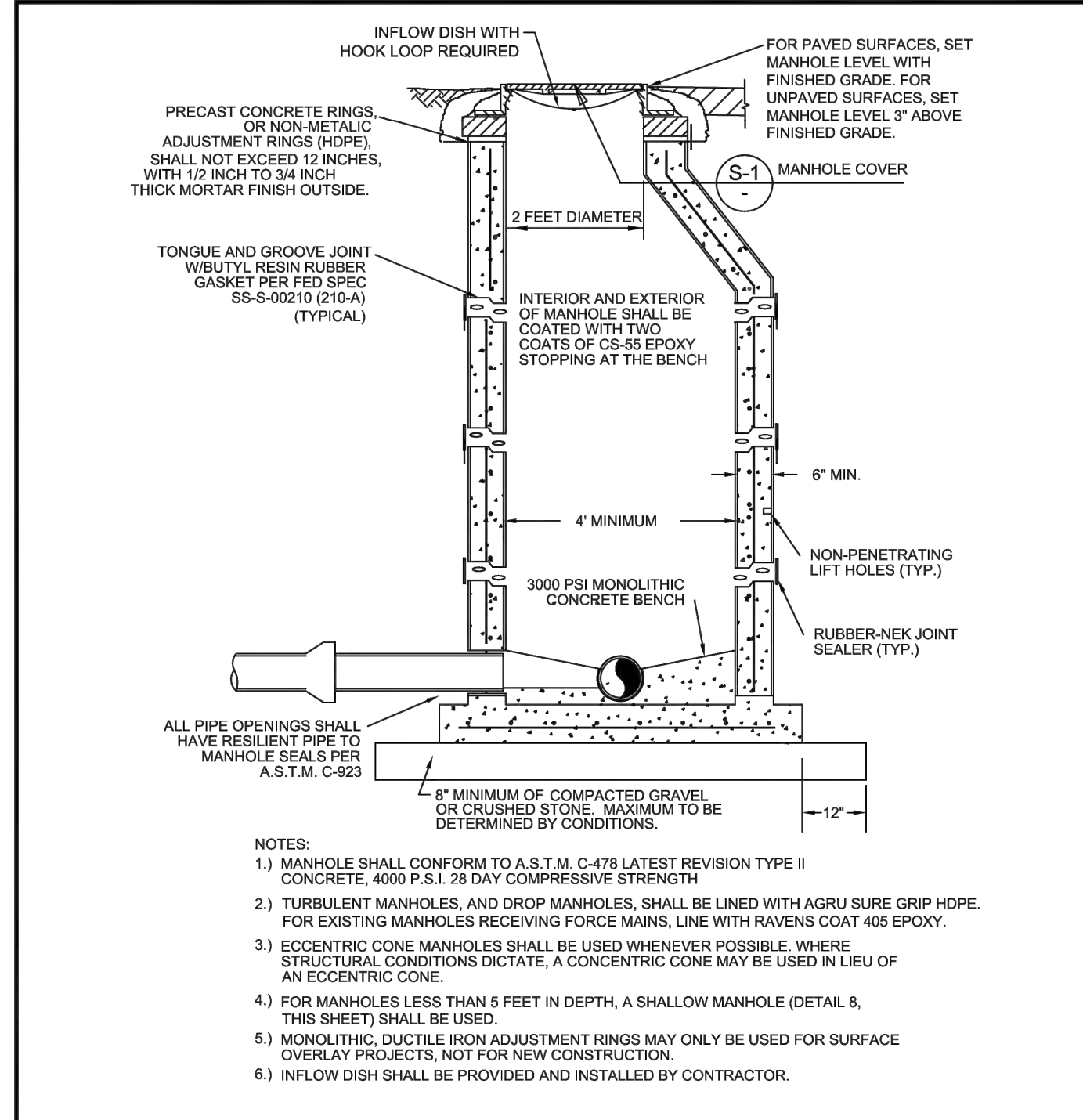

SANITARY SEWER MANHOLE

N.T.S.

	CITY OF VENICE ENGINEERING DEPARTMENT 401 WEST VENICE AVE. VENICE FL 34285 (941) 489-2626 FAX (941) 480-3031	UTILITIES - SEWER SANITARY SEWER MANHOLE	DATE JAN 2021 SHEET NO. S-2
---	--	---	---

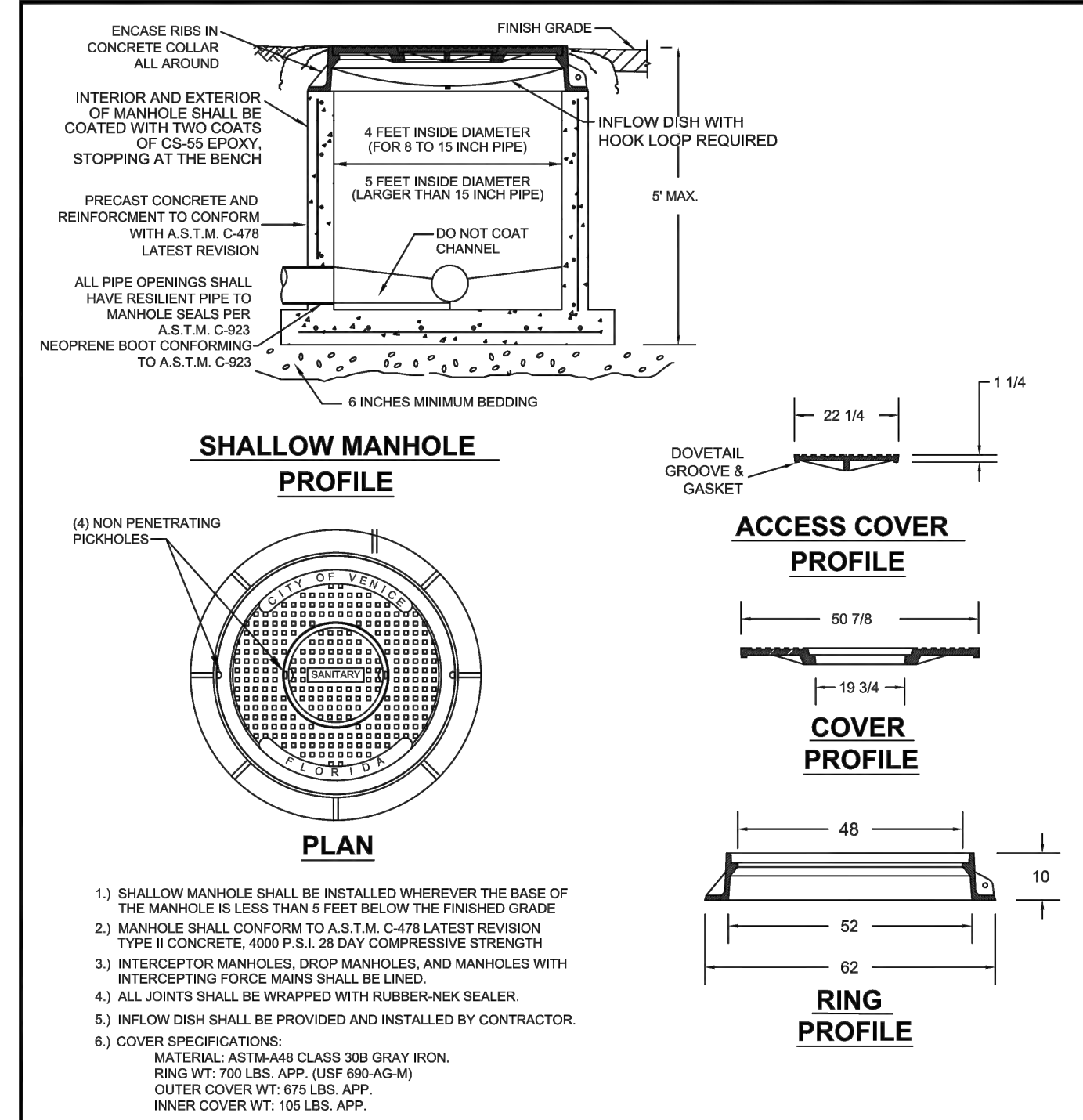

PRECAST SHALLOW MANHOLE

N.T.S.

	CITY OF VENICE ENGINEERING DEPARTMENT 401 WEST VENICE AVE. VENICE FL 34285 (941) 489-2626 FAX (941) 480-3031	UTILITIES - SEWER PRECAST SHALLOW MANHOLE	DATE JAN 2021 SHEET NO. S-3
---	--	--	---

RECORD DRAWINGS

June 22, 2023

APPROVED

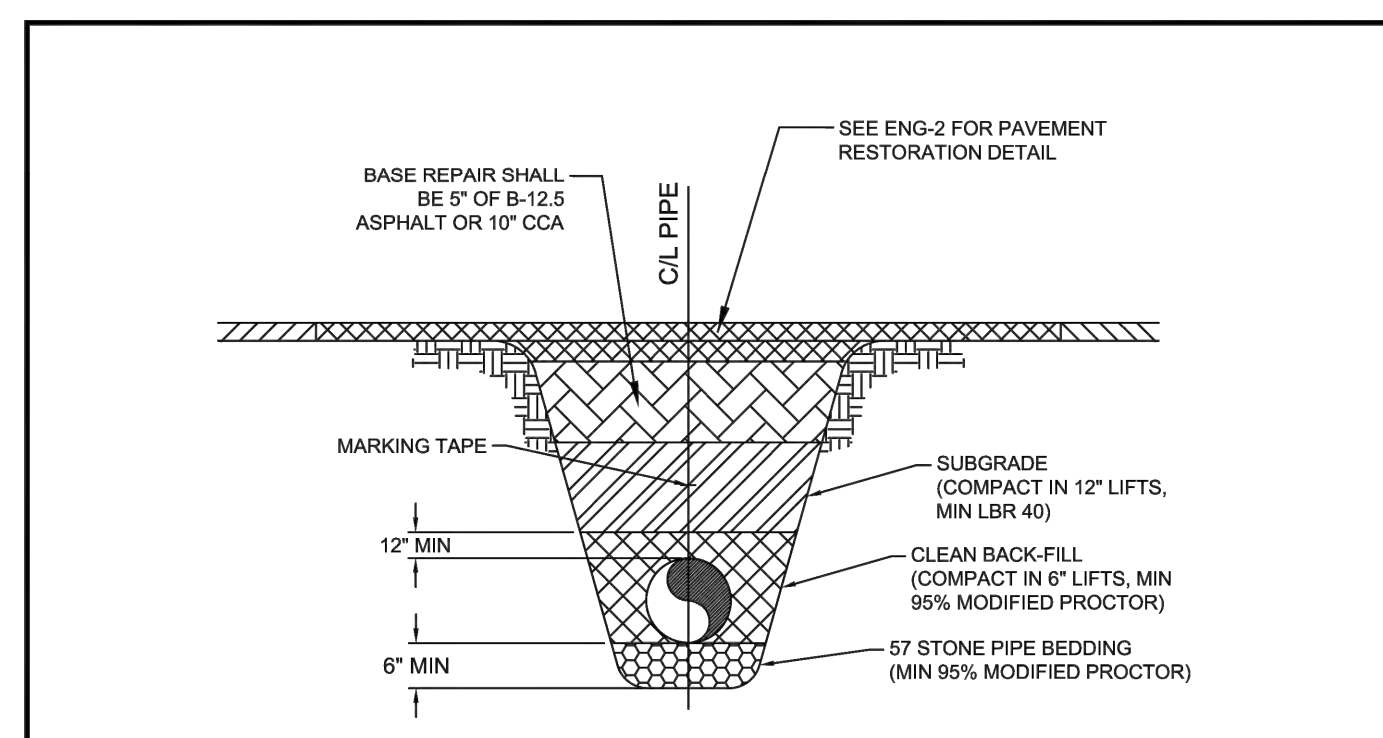

SEWER PIPE TRENCH

N.T.S.

	CITY OF VENICE ENGINEERING DEPARTMENT 401 WEST VENICE AVE. VENICE FL 34285 (941) 489-2626 FAX (941) 480-3031	UTILITIES - GENERAL SEWER PIPE TRENCH	DATE JAN 2021 SHEET NO. S-6
---	--	--	---

KHA PROJECT 043490000		DATE SEPTEMBER 2022	SCALE AS SHOWN	DESIGNED BY KCK	MSL	CHECKED BY KCK	DATE 04/11/2023
CITY OF VENICE UTILITY DETAILS		CITY OF VENICE UTILITY DETAILS		CITY OF VENICE UTILITY DETAILS		CITY OF VENICE UTILITY DETAILS	
CITY OF VENICE HEALTHCARE FACILITY PREPARED FOR CAH DEVELOPMENTS, LLC		CITY OF VENICE HEALTHCARE FACILITY PREPARED FOR CAH DEVELOPMENTS, LLC		CITY OF VENICE HEALTHCARE FACILITY PREPARED FOR CAH DEVELOPMENTS, LLC		CITY OF VENICE HEALTHCARE FACILITY PREPARED FOR CAH DEVELOPMENTS, LLC	
SHEET NUMBER C-2B		SHEET NUMBER C-2B		SHEET NUMBER C-2B		SHEET NUMBER C-2B	

Kimley»Horn
1777 MAIN STREET, SUITE 200, SARASOTA, FL 34236
PHONE: 941-379-7600
WWW.KIMLEY-HORN.COM REGISTRY NO. 696

PROFESSIONAL ENGINEER
STATE OF FLORIDA
LICENSE NUMBER: 12548
K. CRAIG KIMLEY
KCK