

- EXISTING TREE LEGEND**
- OAK
 - ⊙ PINE
 - ⊖ BALD CYPRESS
 - BRAZILLIAN PEPPER
 - ⊙ CITRUS
 - UNKNOWN
 - * CABBAGE PALM
 - ⊗ TREE (To Be Removed)

EXISTING VEGETATION TO REMAIN CONSISTING OF:
 LIVE + LAUREL OAKS, CEDARS, PINES, CABBAGE PALMS, WAX MYRTLE,
 PALMETTO, BEAUTYBERRY + OTHER DENSE NATIVE VEGETATION.

ALL EXOTIC VEGETATION IS TO BE REMOVED FROM THIS AND / OR ANY
 OTHER BUFFER AREA WITHIN THIS PARCEL.

**Kurt R. Crist -
 Landscape Architect, Inc.**

2350 Bern Creek Loop
 Sarasota, Florida 34240
 Phone: (941) 378-9888
 Fax: (941) 378-9888
 FL REG. LA # 0001444
 email: krc@krc.com

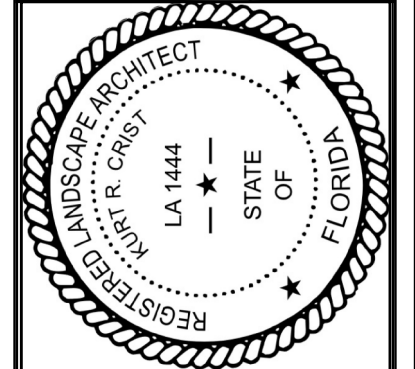

No.	Revision	Date
1	Rev. per City comments	1/23/17
2	Rev. per City comments	2/20/17
3	Rev. per City comments	3/20/17
4	Rev. per City comments	5/15/17
5	Rev. per City comments	6/7/17

PRESERVES OF VENICE
 Border Road
 City of Venice, Florida

**TREE
 REMOVAL**

Designed	krc
Drawn	cadd
Scale	1"=80'
Date	9/2/16
Sheet	15013-F-12/1A

Copyright 2016 KRC-LA, Inc. and may not be reproduced or otherwise used without the express written permission of Kurt R. Crist - Landscape Architect, Inc.

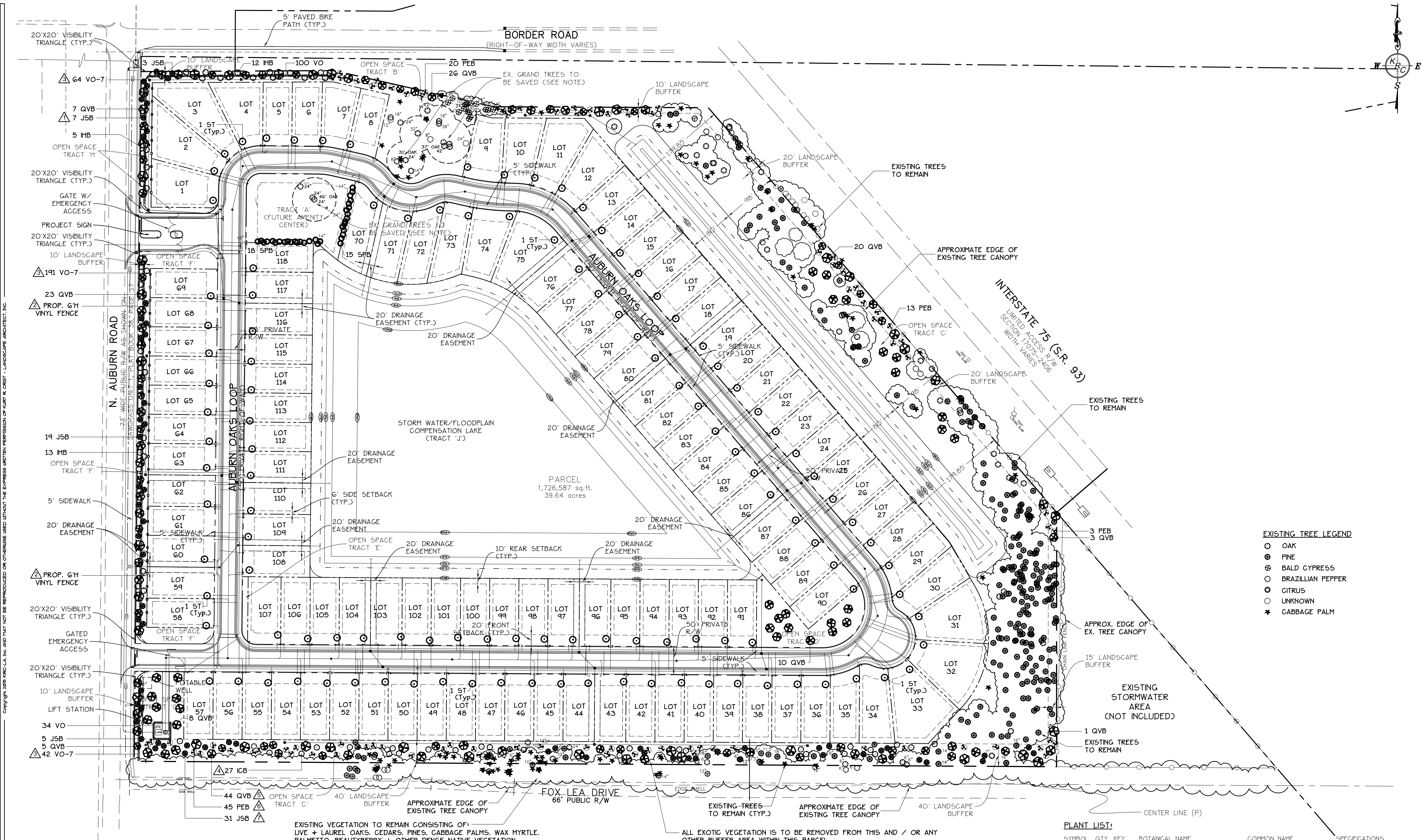

- EXISTING TREE LEGEND**
- ⊙ OAK
 - ⊙ PINE
 - ⊙ BALD CYPRESS
 - ⊙ BRAZILLIAN PEPPER
 - ⊙ CITRUS
 - ⊙ UNKNOWN
 - ★ CABBAGE PALM

REVISION TABLE (6/7/17)

- ▲ Add 1 J5B (So. Red Cedar) tree
- ▲ Add 6' High Vinyl Fence
- ▲ Increased Viburnum size from 24"ht. 3 gal. to 36"ht. 7 gal.
- ▲ Add 11 ICB (Dahoon Holly) tree
- ▲ Add 3 QVB (Live Oak) tree
- ▲ Add 15 PEB (Slash Pine) tree
- ▲ Add 3 J5B (So. Red Cedar) tree
- ▲ Add 6' High Vinyl Fence

EXISTING VEGETATION TO REMAIN CONSISTING OF:
LIVE + LAUREL OAKS, CEDARS, PINES, CABBAGE PALMS, WAX MYRTLE,
PALMETTO, BEAUTYBERRY + OTHER DENSE NATIVE VEGETATION.

ALL EXOTIC VEGETATION IS TO BE REMOVED FROM THIS AND / OR ANY
OTHER BUFFER AREA WITHIN THIS PARCEL.

PLANT LIST:

SYMBOL	QTY.	KEY	BOTANICAL NAME	COMMON NAME	SPECIFICATIONS
⊙	27	ICB	<i>Ilex cassine</i>	Dahoon Holly Tree	10'h x 4'spr., 3'cal.
⊙	30	IHB	<i>Ilex x attenuata</i> 'East Palatka'	East Palatka Holly Tree	10'h x 4'spr., 3'cal.
⊙	65	J5B	<i>Juniperus silicicola</i>	So. Red Cedar Tree	10'h x 4'spr., 3'cal.
⊙	81	PEB	<i>Pinus ellottii</i>	Slash Pine Tree	10'-12'h x 5'spr., 3'cal.
⊙	147	QVB	<i>Quercus virginiana</i>	Live Oak Tree	12'h x 5'spr., 3'cal.
⊙	33	SPB	<i>Sabal palmetto</i>	Cabbage Palm	10'-20'oa. Cropped
⊙	118	ST	See Species List	Street Tree (On Lot)	10'h x 4'spr., 3'cal.
⊙	297	VO-7	<i>Viburnum odoratissimum</i>	Sweet Viburnum	36'h. 7 gal. (42'o.c.)
⊙	134	VO	<i>Viburnum odoratissimum</i>	Sweet Viburnum	24'h. 3 gal. (3'o.c.)

Kurt R. Crist -
Landscape Architect, Inc.

2350 Bern Creek Loop
Sarasota, Florida 34240
Phone: (941) 378-8989
Fax: (941) 378-8989
email: krc@landscapeinc.com

PRESERVES OF VENICE
Border Road
City of Venice, Florida

LANDSCAPE PLAN

Designed: krc
Drawn: cadd
Scale: 1"=80'
Date: 9/2/16
Sheet: 15013-F-122LA

L2

Project: 15013

FL REG. LA # 0001444
email: krc@landscapeinc.com

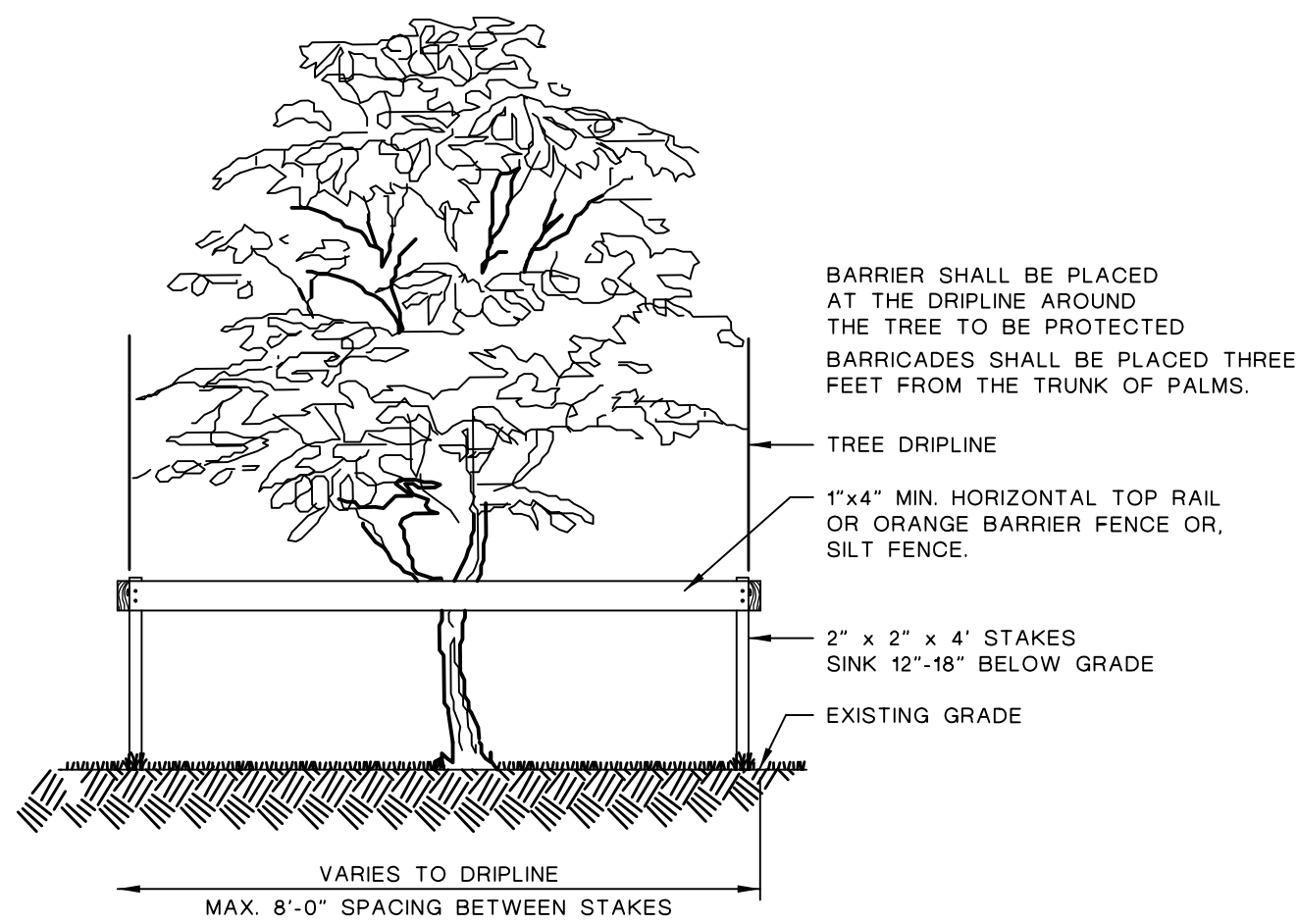

TREE PROTECTION DETAIL
(PRIOR TO CONSTRUCTION ACTIVITIES) N.T.S.

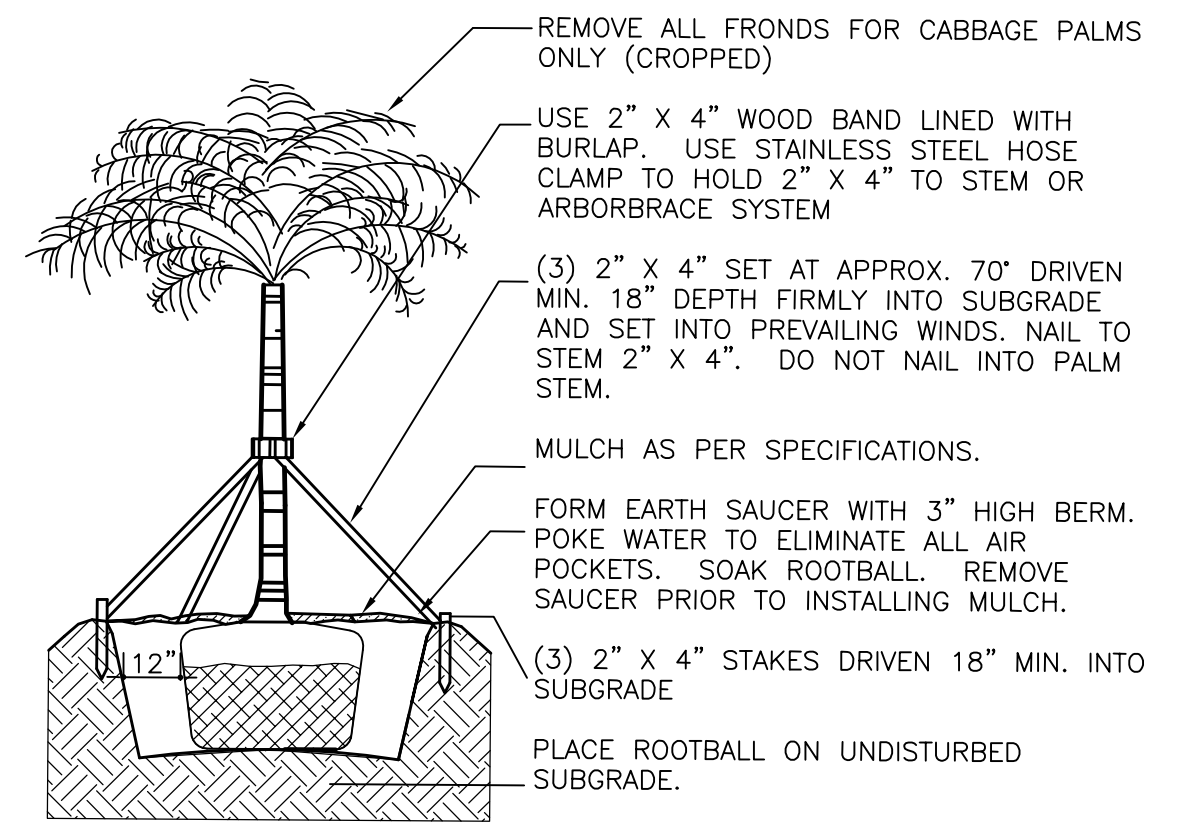

PALM TREE PLANTING DETAIL
SCALE: NOT TO SCALE

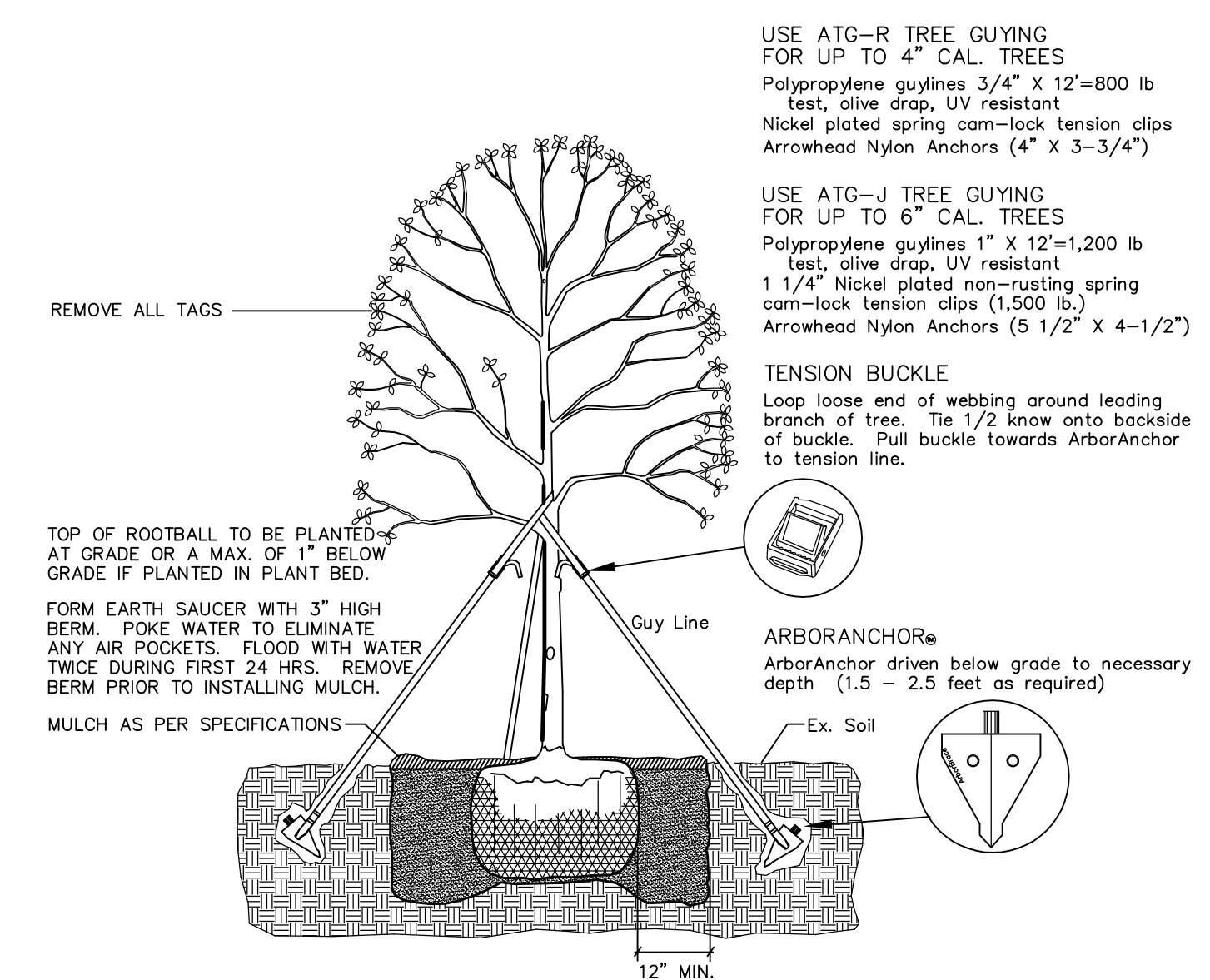

TREE PLANTING DETAIL
SCALE: NOT TO SCALE

GENERAL NOTES:

A minimum of 2 days and a maximum of 5 days prior to the commencement of any work, Sunshine State One Call shall be notified • 1 800 432-4770 per Florida Statute 553.851.

All plants to be Florida grade #1 or better. Workmanship should be of the highest nursery standards.

All plants are to be planted from flush to one inch (1") above finished grade of soil. All trees are to be planted flush with existing grade if surrounded by grass / sod. If planted within a plant bed, trees are to be planted flush to one inch (1") below finished grade to create a shallow basin to hold water and mulch. Soil ring mounds may be installed around plants or trees for water but must be graded / removed prior to installation of mulch. DO NOT backfill any soil over the top of the rootball of any plant or tree.

All areas within the property boundaries which require sod are to be sodded with Argentine Bahia solid sod, unless otherwise specified, free from pests and weeds, layed in staggered rows with no gaps. The contractor is to substantiate all sod quantities before final installation.

Use only Grade 'A' cypress bark, Melaleuca, Eucalyptus or Pine Bark mulch, 3' deep in all plant bed areas. All trees are to have a mulched bed a minimum of three feet (3') in diameter and two inches (2") deep. Grade 'B' Cypress mulch is not acceptable or will be approved. A 6' diameter ring around each trunk will remain free of mulch.

All trees are to be guaranteed for six (6) months and all plants are to be guaranteed for ninety (90) days from the date of final acceptance of the job by the owner / representative. Vandalism, theft, abuse, lack of proper maintenance, watering, or abnormal acts of God, are not included.

ADDITIONAL NOTES:

No clearing with heavy equipment, filling, or placement of improvements or utility lines shall occur within the protected root zone of any canopy tree to be saved, per Section 54-488 (1) (b) of Sarasota County code. The protected root zone is defined as the dripline of the tree. Only hand clearing or mowing is permitted within the protected root zone of canopy trees to be saved if authorized by the Administrator. Where unauthorized removal of native vegetation within the protected root zone occurs the Administrator may require the replanting of understory vegetation. Full dripline protection is required; however the Administrator may allow certain activities to be conducted within the barricaded dripline of a tree, so long as the County determines that the tree will not be adversely affected.

All replacement trees shall be a minimum of 3' feet from a property line and 6' feet from any utilities (above or below ground). All trees planted and pruned must adhere to the ANSI A30D standards and must have adequate room, when planted, to mature freely.

A Tree Permit will be required prior to any construction, native vegetative removal within the dripline of a tree, and / or tree removal.

All Grand Trees will be protected as per the barricade detail. All work within the dripline including pruning must receive written approval from the Administrator and Best Management Practices must be followed per Section 54-588 (2). THE AMENITY CENTER INFRASTRUCTURE SHALL NOT ENCRoACH INTO DRIPLINE OF GRAND TREE.

No single tree species may account for more than 50% of the total number of required trees.

IRRIGATION NOTES:

GENERAL - Work consists of furnishing all labor, equipment and materials necessary to produce a complete and functional irrigation system that will supply 100% coverage of the landscaped areas within the limits of work which is to include areas as shown and drawn on the plan (Grassed areas optional). The irrigation contractor is to visit the site and become familiar with all conditions prior to commencement of work and is responsible for locating all existing utilities and lighting conduit and is responsible for any damages or repairs incurred. All minor items implied, usually included, or required for the complete construction of the irrigation system shall be installed whether shown in the drawing / specifications or not. All equipment shall be installed per the manufacturer's recommendations. As-built drawings for the owners use shall be provided by the irrigation contractor after completion of work. Test and demonstrate to the owner / landscape architect the operations of the system. Instruct the owner's designated personnel in the operations of the system including adjustment of sprinklers, controller, valves and manufacturer's manuals.

WATER SOURCE - A well with a submersible pump or reclaimed water (if available) is to be utilized for irrigation purposes. The irrigation system will be designed to provide 50 GPM at 50 PSI. The irrigation contractor is responsible for compliance with any requirements or codes, with local and state authorities, and is to be responsible for all licenses, permits, and fees pertaining to this irrigation system.

CONTROLLER / RAINSENSOR - A RAINBRD ESP Model outside irrigation controller + Mniclk II rain shut off device is to be installed on a post at the controller location. (Location to be determined).

PERIMETER ROADWAY BUFFERS

N. AUBURN RD. (10'wide)

1230.35 l.f. (Less Ingress-143.64) / 50 = 21.7	22 TREES REQUIRED
35 QVB Live Oak 10'h. 3'cal.	84 TREES PROPOSED
31 JSB So. Red Cedar 10'h. 3'cal.	⚠ Add 1 JSB (So. Red Cedar) tree
18 IHB E.P. Holly 10'h. 3'cal.	Incorrect original calculation was less 5 IHB
297 VO-7 Sweet Viburnum 36'h. 7 gal.	297 SHRUBS PROPOSED
	⚠ Increased Viburnum size from 24'ht. 3 gal. to 36'ht. 7 gal.

BORDER RD. (10'wide)

1.018.26 l.f. / 50 = 20.3	21 TREES REQUIRED
26 QVB Live Oak 10'h. 3'cal.	61 TREES PROPOSED
20 PEB Slash Pine 10'h. 3'cal.	
3 JSB So. Red Cedar 10'h. 3'cal.	
12 IHB E.P. Holly 10'h. 3'cal.	
100 VO Sweet Viburnum 24'h. 3 gal.	100 SHRUBS PROPOSED

I-75 (20'wide)

1.405.82 l.f. / 50 = 28.1	29 TREES REQUIRED
24 QVB Live Oak 10'h. 3'cal.	94 TREES PROPOSED
16 PEB Slash Pine 10'h. 3'cal.	
54 Ex. Trees (44 Pines, 10 Oaks)	

FOX LEA DRIVE (40'wide)

1.644.32 l.f. / 50 = 32.8	33 TREES REQUIRED
44 QVB Live Oak 10'h. 3'cal.	167 TREES PROPOSED
45 PEB Slash Pine 10'h. 3'cal.	⚠ Add 3 QVB (Live Oak) tree
31 JSB So. Red Cedar 10'h. 3'cal.	⚠ Add 15 PEB (Slash Pine) tree
27 ICB Dahoon Holly Tree 10'h. 3'cal.	⚠ Add 3 JSB (So. Red Cedar) tree
52 Ex. Trees (22 Pines, 7 Oaks, 23 Palms)	⚠ Add 11 ICB (Dahoon Holly) tree
	Removed Additional Trees (3 Pines, 1 Oak)
	Added Existing Palms (23)

TREE REMOVAL / REPLACEMENT

1 Tree is required for every 2,000 sq.ft. of site.

SITE = 1,726,586.77 sq.ft.

1,726,586.77 / 2,000 =	863 TREES REQUIRED
373 Ex. Trees (236 Pines, 45 Oaks, 13 Cypress, 5 Unknown, 74 Cabbage Palm)	873 TREES PROPOSED
27 ICB Dahoon Holly 10'h. 3'cal.	Removed Additional Trees (7 Pines, 1 Oak, 13 Cabbage Palm)
30 IHB E.P. Holly 10'h. 3'cal.	Added 11 ICB (E.P. Holly)
64 JSB So. Red Cedar 10'h. 3'cal.	Added 3 JSB (So. Red Cedar)
81 PEB Slash Pine 10'h. 3'cal.	Added 15 JSB (Dahoon Holly)
147 QVB Live Oak 10'h. 3'cal.	Added 2 QVB (Live Oak)
33 SPB Cabbage Palm 10'-20'oa	
118 ST Street Tree (On Lot)	
	Silver Buttonwood 10'h. 3'cal.
	Dahoon Holly 10'h. 3'cal.
	Eagleston Holly 10'h. 3'cal.
	East Palatka Holly 10'h. 3'cal.
	Yaupon Holly 10'h. 3'cal.
	Magnolia 10'h. 3'cal.
	Simpson's Stopper 10'h. 3'cal.
	Cabbage Palm 10'-20'oa
	Royal Palm 16'-20'oa

- Cabbage and Royal Palms can only account for a maximum of 15% or 17 total of the 118 Street Trees.
- Street Trees must be chosen from the list and Cabbage Palms can not consist of more than 25% of the overall (863) tree requirement. Maximum of 215.
- All Street Trees (planted on Lots) must be installed a minimum of 10' from sidewalk.
- If a tree is removed anytime after planting it must be replaced with a tree from the approved list.

Kurt R. Crist - Landscape Architect, Inc.

2350 Barn Creek Loop
Sarasota, Florida 34240
Phone: (941) 319-8986
Fax: (941) 319-8986
FL REG. LA # 00201444
email: krc@krcinc.com

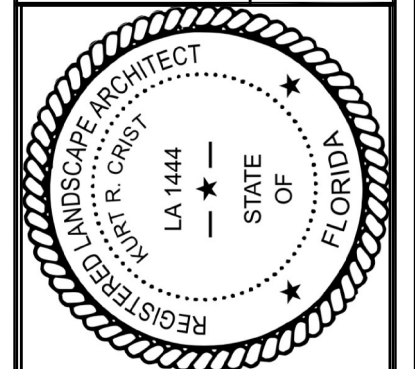

Date	Revision
1/3/17	1 Rev. per City comments
2/20/17	2 Rev. per City comments
3/20/17	3 Rev. per City comments
5/15/17	4 Rev. per City comments
6/7/17	5 Rev. per City comments

PRESERVES OF VENICE
Border Road
City of Venice, Florida

NOTES & SPECS

Designed	krc
Drawn	cadd
Scale	ON PLAN
Date	9/2/16
Sheet	15013-F-123LA

Project #15013

3 of 5

Copyright © 2013 KRC-LA, Inc. AND MAY NOT BE REPRODUCED OR OTHERWISE USED WITHOUT THE EXPRESS WRITTEN PERMISSION OF KURT R. CRIST - LANDSCAPE ARCHITECT, INC.

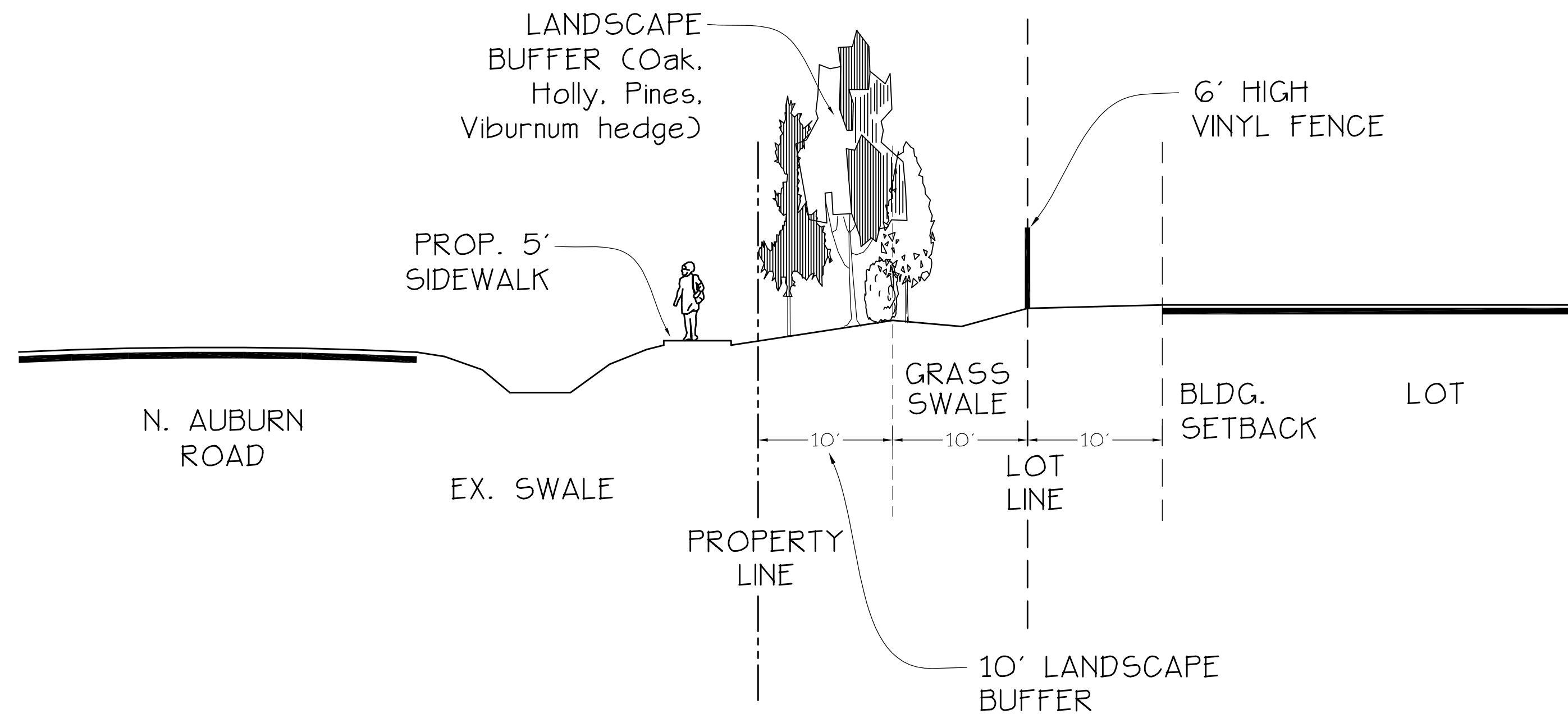

N. AUBURN ROADWAY CROSS SECTION

SCALE: 1"=8'

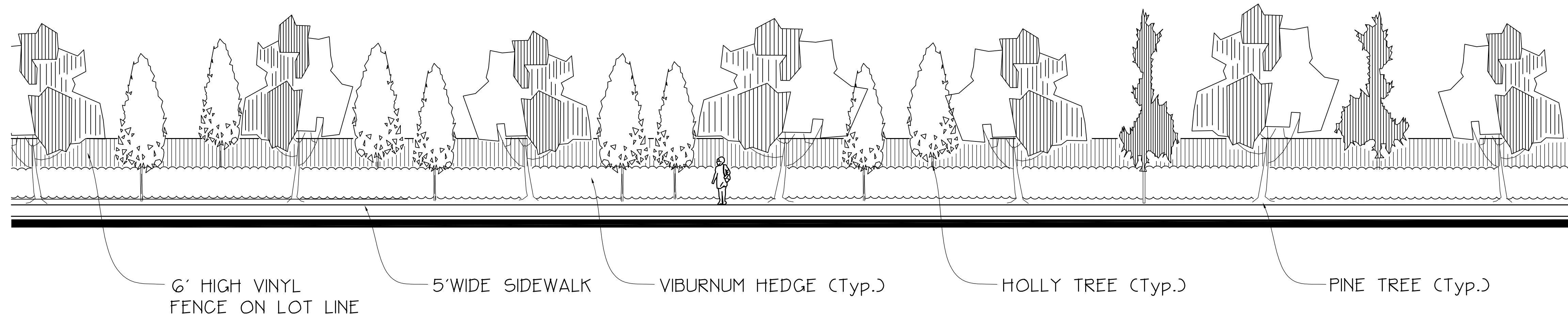

N. AUBURN ROAD ELEVATION

SCALE: 1"=8'

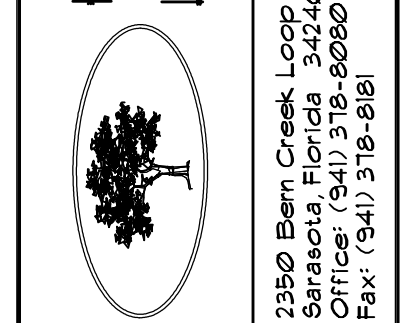

Kurt R. Crist -
Landscape Architect, Inc.

2350 Barn Creek Loop
Borlinda, Florida 34240
Office: 772-288-0260
Fax: (941) 215-8181
email: krc@krc-la.com

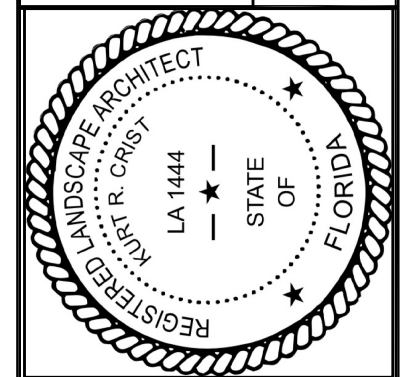

No.	Revision	Date

PRESERVES OF VENICE
Border Road
City of Venice, Florida

**SECTION 4
ELEVATION**

Designed krc
Drawn eadd
Scale ON PLAN
Date 6/7/17
Sheet 15013-F-12.4LA

4
of 5
Project #15013

Copyright © 2013 KRC-LA, Inc. AND MAY NOT BE REPRODUCED OR OTHERWISE USED WITHOUT THE EXPRESS WRITTEN PERMISSION OF KURT R. CRIST - LANDSCAPE ARCHITECT, INC.

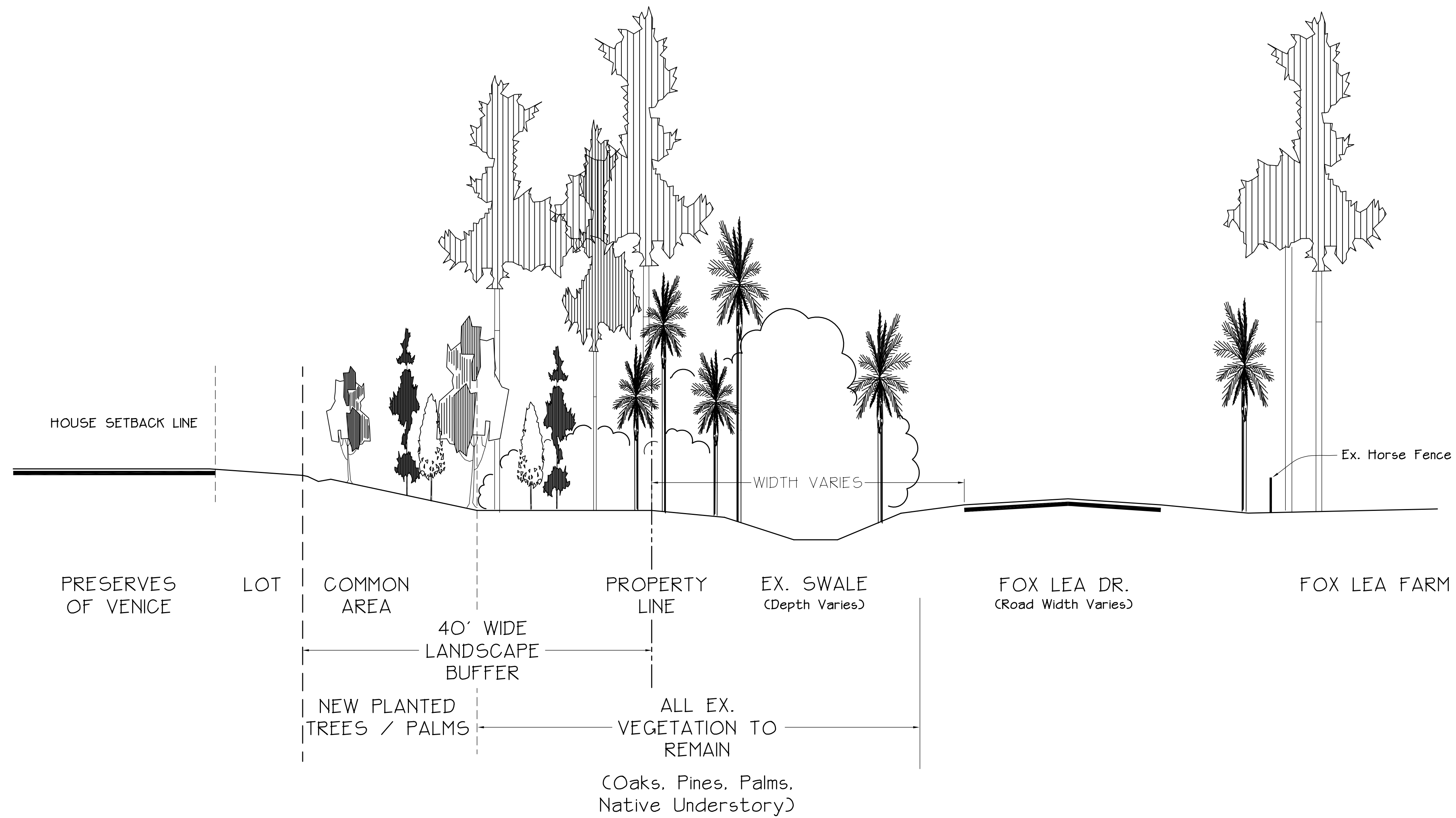

FOX LEA DRIVE ROADWAY CROSS SECTION

SCALE: 1"=8'

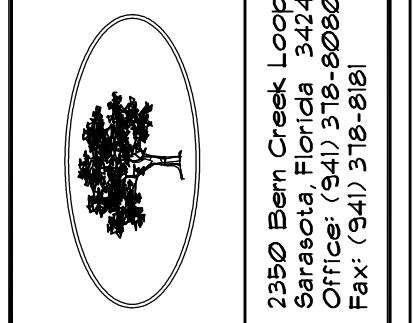

Kurt R. Crist -
Landscape Architect, Inc.

2350 Britt Creek Loop
Bradford, Florida 32809
Tel: (904) 378-8181
FL REG. LA # 0001444
email: krc@krcinc.com

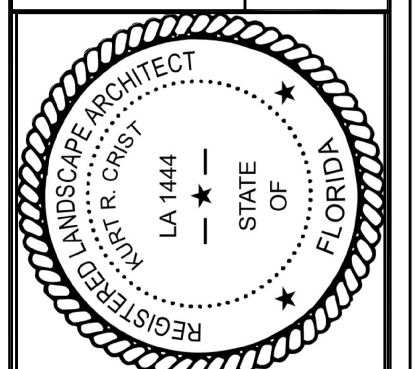

No.	Revision	Date

PRESERVES OF VENICE
Border Road
City of Venice, Florida

SECTION

Designed	krc
Drawn	cadd
Scale	ON PLAN
Date	6/7/11
Sheet	15013-F-123LA

15
of 15
Project #15013