

JAN 29 1990

MEMORANDUM

Date: January 26, 1990
To: Mark Seemann, Building & Zoning Official
From: Larry Heath, Director of Public Works
Re: Granada Avenue Property - Parking Lot Improvements

Attached for reference, is a preliminary site plan of a proposed parking lot which we have reviewed with Planning and Building & Zoning, for possible consideration of construction. This plan shows approximately 72 parking spaces but might have to be reduced to approximately 68 to avoid the removal of two good-sized oak or elm trees. The trees are too large to move to another location, therefore, we will forfeit spaces in saving the trees.

The estimated cost of construction, based on this preliminary plan is \$87,400.00. In reviewing an alternate consideration, the Southern portion of the parking lot has one row of stalls totalling approximately 25 spaces. If hard surface is eliminated for this portion and sod is installed for temporary overflow parking, the projected savings would be around \$4,000.00.

If we can be of further assistance, please advise.

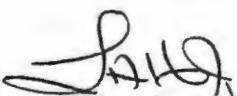

LH(wc)cd/0126A/E-1277

cc: B. Simanskey, City Clerk
J. MacLean, City Mgr.
H. Place, Dir. Planning
C. Rose, P.E.

March 1, 1990

MEMORANDUM

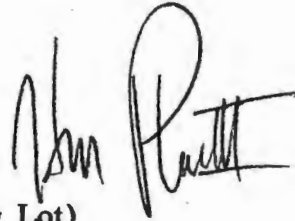
To: Planning Commission
From: H.M. Place, Director of Planning
RE: Petition 90-1SE (City Hall Parking Lot)



City Manager John MacLean asked me to respond to the questions raised by the Planning Commission at your February 20, 1990 meeting regarding the proposed municipal parking lot on Granada Street. For your information:

1. The lot will not be restricted to day time usage. It will be available for evening meetings at City Hall and adjacent residents have been assured they will be able to use the lot at night.
2. No lighting is planned in the initial construction, but in the event they are installed at a later date, they will be low profile lights so they will not shine on neighboring properties.
3. The City Manager will be requesting sufficient funds from Council to pave the entire lot per the site plan rather than leaving any area grassed for reserve parking.
4. The total number of spaces will be determined at the time working engineering drawings, however, the probable maximum number will be 72 as per the site plan.

Door w/ For
OK!

If you have further questions, I will respond.

hmp/lav

xc: B.N. Simanskey, City Clerk

PRELIMINARY
NOT TO BE USED FOR CONSTRUCTION
GRANADA AVENUE

AVENUE DES PARQUES

N

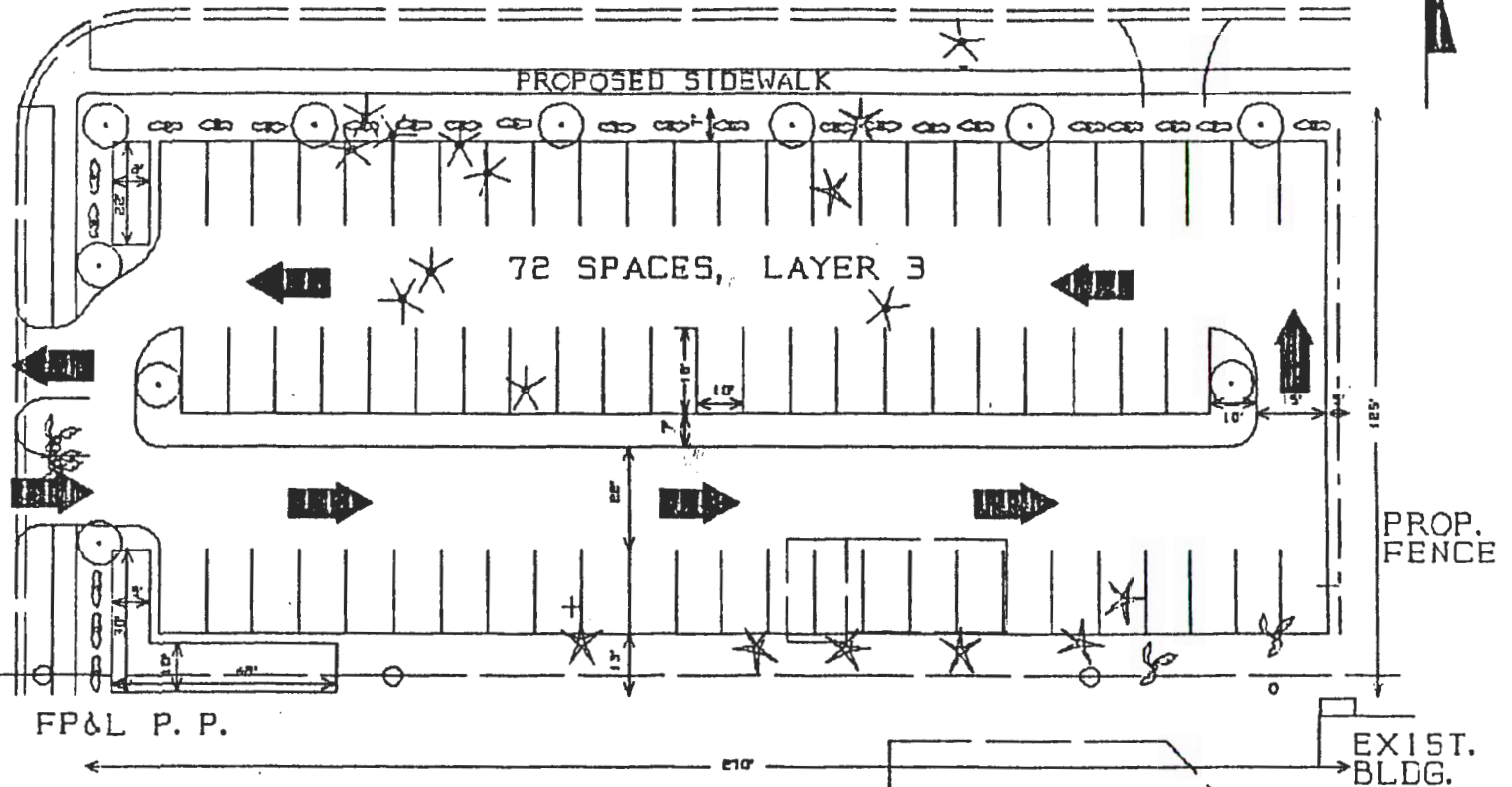

- ☙ = PALM
- ★ = OAK
- ✱ = PINE
- ✚ = MISC. TREE
- = REQD. TREE

SOUTH BUFFER MUST HAVE
6' HIGH PLANTS OR FENCE
PLACED 3' INSIDE OF LOT
LINE WITH PLANTINGS 10'
APART ON THE PROPERTY
LINE SIDE.