

PROP SITE LEGEND	
PROPERTY LINE	---
EASEMENT LINE	---
SETBACK LINE	---
INTERIOR PROPERTY LINE	---
LEASE LINE	---
LIMIT OF WORK	LOW
LIMIT OF DISTURBANCE	LOD
CURB	---
UTILITY POLE	○
TYPICAL SIGN	■
BOLLARD	●
UTILITY POLE W/ LIGHT	○
TYPICAL LIGHT	⊗
PARKING COUNT	⊗

TREE MITIGATION CALCULATIONS	
TOTAL TREE MITIGATION REQUIRED 11.29 ACRES X 45"	508"
TOTAL TREES PROPOSED:	
GUMBO LIMBO 49 TREES X 4" CAL	196"
SPANISH STOPPER 28 TREES X 2.5" CAL	70"
SOUTHERN MAGNOLIA 10 TREES X 3" CAL	30"
FLORIDA SLASH PINE 17 TREES X 3" CAL	51"
SOUTHERN LIVE OAK 52 TREES X 3" CAL	156"
BALD CYPRESS 23 TREES X 3" CAL	69"
TOTAL TREE MITIGATION PROVIDED	584"

PLANT SCHEDULE									
SYMBOL	CODE	QTY	BOTANICAL NAME	COMMON NAME	SIZE	CONTAINER	DROUGHT		FL NATIVE / FRIENDLY
TREES									
	BS	49	BURSERA SIMARUBA	GUMBO LIMBO	4" CAL - 14' OA. HT. MIN.	CONT./B&B	TOLERANT		NATIVE
	EF	28	EUGENIA FOETIDA	SPANISH STOPPER	2.5" CAL. 8' HT. X 6" SPRD.	CONT./B&B	TOLERANT		NATIVE
	MG	10	MAGNOLIA GRANDIFLORA	SOUTHERN MAGNOLIA	3" CAL. 12' OA. HT. X 6" SPRD.	CONT./B&B	TOLERANT		NATIVE
	PE	17	PINUS ELLIOTTI VAR. Densa	FLORIDA SLASH PINE	3" CAL. 12' OA. MIN. HT. X 6-8" SPRD.	CONT./B&B	TOLERANT		NATIVE
	QV	52	QUERCUS VIRGINIANA	SOUTHERN LIVE OAK	3" CAL. 12' OA. HT. X 6" SPRD.	CONT./B&B	TOLERANT		NATIVE
	TD	23	TAXODIUM DISTICHUM	BALD CYPRESS	3" CAL. 12' OA. HT. X 6" SPRD.	CONT./B&B	TOLERANT		NATIVE
SHRUB AREAS									
	CHR	2,034	CHRYSOGALANUS ICADO RED TIP	RED TIP COOD PLUM	24" HT. X 24" SPRD.	CONTAINER	TOLERANT	24" c.s.	NATIVE
	CME	250	CARISSA MACROCARPA EMERALD BLANKET	EMERALD BLANKET NATAL PLUM	24" HT. X 24" SPRD.	CONTAINER	TOLERANT	24" c.s.	FRIENDLY
	NN	357	NEX VOMITORIA NANA	DWARF YALPORN HOLLY	36" HT. X 36" SPRD.	CONTAINER	TOLERANT	36" c.s.	NATIVE
	RHI	371	RHAPHOLIPS INDICA	INDIAN HAWTHORN	36" HT. X 36" SPRD.	CONTAINER	TOLERANT	36" c.s.	FRIENDLY
	TRA	3,312	TRACHELOPERNUM ASIATICUM	ASIATIC JASMINE	6" HT. X 12" SPRD. W/ 3-4 RUNNERS	CONTAINER	TOLERANT	18" c.s.	FRIENDLY
BUILDING FOUNDATION SHRUBS									
	LBH-F	12	LIRIOPE MUSCARI BIG BLUE	BIG BLUE LYTURF	12" HT. X 12" SPRD.	CONTAINER	TOLERANT	24" c.s.	FRIENDLY
	RHI-F	16	RHAPHOLIPS INDICA	INDIAN HAWTHORN	24" HT. X 24" SPRD.	CONTAINER	TOLERANT	36" c.s.	FRIENDLY
SOD									
	SOD	47,480 SF	STENOTAPHRUM SECUNDATUM PALMETTO	PALMETTO ST. AUGUSTINE GRASS	FULL TIGHT COVERAGE	PALLET			
CODE	QTY	BOTANICAL NAME	COMMON NAME	SIZE	CONTAINER				

GENERAL LANDSCAPE NOTES:

- ALL PLANTING BEDS TO BE MULCHED WITH 3" FLORIMULCH MELALEUCA (COCOCA BROWN) MULCH.
- THE CONTRACTOR SHALL VERIFY THE LOCATION OF ALL UTILITIES PRIOR TO CONSTRUCTION
- DIGGING IN UTILITY EASEMENTS SHALL BE BY HAND ONLY
- THIS PLAN IS TO BE UTILIZED FOR LANDSCAPE PURPOSES ONLY.
- ALL DISTURBED UNPAVED AREAS, EXCLUDING PLANTING BEDS, ARE TO BE INSTALLED AS LAWN IN ACCORDANCE WITH LANDSCAPE SPECIFICATION #2.C., UNLESS OTHERWISE STATED ON THIS PLAN.
- SHRUBS PLANTED ALONG HEAD-IN PARKING STALLS SHALL BE INSTALLED TO ALLOW A CLEARANCE OF TWO FEET FROM FACE OF CURB TO ALLOW FOR BUMPER OVERHANG.
- IF IRRIGATION IS REQUIRED BY THE OWNER OR APPROVING MUNICIPALITY, THE CONTRACTOR SHALL PROVIDE AN IRRIGATION SYSTEM MEETING THE SPECIFICATIONS OF THE CHOSEN PRODUCT'S MANUFACTURER. THE IRRIGATION DESIGN SHALL ACCOMMODATE LAWN AND BED AREAS EACH UNDER SEPARATE ZONES TO MAXIMIZE WATER EFFICIENCY. THE CONTRACTOR SHALL BE RESPONSIBLE FOR SECURING ANY PERMITS REQUIRED FOR THE INSTALLATION OF A RUST-FREE IRRIGATION SYSTEM.
- PLANT MATERIAL SUBSTITUTIONS MUST BE FORMALLY SUBMITTED TO BOHLER ENGINEERING AND THE MUNICIPAL ENGINEER AND LANDSCAPE CONSULTANTS FOR REVIEW AND APPROVAL PRIOR TO INSTALLATION. ANY PLANT MATERIAL THAT ARE TO BE INSTALLED WITHIN STORMWATER BMP FEATURES MUST BE NATIVE SPECIES.
- WITHOUT EXCEPTION, WEED BARRIER FABRIC SHALL NOT BE INSTALLED WITHIN ANY BMP FACILITY. BMP FACILITIES INCLUDE RAINGARDENS, INFILTRATION TRENCHES, VEGETATIVE SWALES AND STORMWATER BASINS.
- ANY TREE INSTALLED WITHIN 10 FT. OF NEW CONCRETE SIDEWALKS AND/OR NEARBY UNDERGROUND UTILITY OR PIPE SHOULD BE INSTALLED WITH BIOBARRIER ROOT BARRIER FABRIC AS SHOWN. SEE DETAIL DETAIL 8, L-704.
- THERE IS TO BE NO PLANTING OF TREES OR SHRUBS EITHER DIRECTLY OVER OR WITHIN 10 HORIZONTAL FEET OF THE SANITARY SEWER GRAVITY SEWERS AND FORCE MAIN.
- ALL PLANTS SHALL BE NURSERY GROWN AND SHALL BE FL #1 GRADE OR BETTER PER ALL REQUIRED INSPECTION, GRADING STANDARDS, AND PLANT REGULATIONS AS SET FORTH IN THE LATEST EDITION OF THE "FLORIDA GRADES & STANDARDS FOR NURSERY PLANTS" PUBLISHED BY THE FLORIDA DEPT. OF AGRICULTURE.

LANDSCAPE & ROOT BARRIER NOTES:

TREES SHOWN ON THIS PLAN ARE FOR GRAPHIC REPRESENTATION ONLY. TREE SPACING IS BASED ON DESIGN REQUIREMENTS AND THE TREES SHOWN ON THESE PLANS ATTEMPT TO ACCOMPLISH THAT SPACING WHILE MAINTAINING THE REQUIRED SETBACKS FROM UTILITIES. TREES MAY BE FIELD ADJUSTED TO AVOID CONFLICTS WITH DRIVEWAYS AND UNDERGROUND UTILITIES. IN ANY CASE THE TREES SHALL BE LOCATED IN THE FIELD IN ACCORDANCE WITH THE PLANTING DETAILS SHOWN.

ADDITIONALLY, TREES ARE TO BE INSTALLED WITH TEN FOOT (10') SEPARATION FROM ANY WATER OR SEWER MAIN AND/OR SERVICE, HYDRANTS AND LIFT STATIONS. IF A TEN FOOT (10') SEPARATION CANNOT BE ACHIEVED, THE TREE CAN BE INSTALLED WITH A ROOT BARRIER SYSTEM. REFER TO THE "ROOT BARRIER" DETAIL FOR INSTALLATION REQUIREMENTS.

SEE DETAIL 8, SHEET L-704 FOR ROOT BARRIER DETAILS.

NOTE: ROOT BARRIER SHALL BE PROVIDED FOR ALL LANDSCAPING PROPOSED WITHIN 10 FEET OR DRAINAGE PIPES, STRUCTURES AND CHAMBERS.

NATIVE SPECIES:

* NATIVE SPECIES - HIGH DROUGHT TOLERANCE (OTHERS MEDIUM DROUGHT TOLERANCE)
** CONTRACTOR TO VERIFY SQUARE FOOTAGE

CONTRACTOR SHALL VERIFY PLANT QUANTITIES IN THE TABLE WITH THE PLAN. WHERE THERE IS A DISCREPANCY IN PLANT QUANTITIES, THE PLAN OVER RIDES THE PLANT LIST

DEVIATIONS TO TREE SPECIES NOTE:

IF DEVIATIONS TO THE TREE SPECIES OR LOCATION ARE MADE THE CITY WILL BE CONSULTED IN ADVANCE.

LANDSCAPE DATA TABLE

JURISDICTION	CITY OF VENICE
CURRENT ZONING /PROPOSED ZONING	CG (COMMERCIAL GENERAL)
TOTAL SITE AREA	11.29 AC (491,721 SF)
OVERALL VUA AREA	5.93 AC (253,935 SF)
PROPOSED GREEN SPACE	1.10 AC (47,578 SF)
IMPERVIOUS AREA: (MINIMUM / PROPOSED / MAXIMUM)	10.10 AC (439,963 SF)
PROPOSED BUILDING	3.09 AC (134,807 SF)
VUA LANDSCAPE AREAS (INCLUDES VUA EDGES ASIDE FROM EAST BUFFER)	1.35 AC (58,668 SF)
BUFFER LANDSCAPE AREA (EAST BUFFER ONLY)	0.28 AC (12,005 SF)
FOUNDATION LANDSCAPE	0.0037 AC (159 SF)
TOTAL LANDSCAPED AREA	1.63 AC (71,035 SF)
VUA LANDSCAPE BUFFER REQUIREMENTS SEC. 3.7.5	
REQUIRED	PROVIDED
WEST VUA PROPERTY LINE 656LF MINUS 117LF OF DRIVE = 539LF	
1 CANOPY TREE/ 35 LF	15 TREES
CONTINUOUS HEDGE MAX. 36" O.C.	182 SHRUBS
SOUTH VUA PROPERTY LINE 1137LF MINUS 48LF OF DRIVE = 1089LF	
1 CANOPY TREE/35 LF	31 TREES
CONTINUOUS HEDGE MAX. 36" O.C.	764 SHRUBS
NORTH VUA PROPERTY LINE 761LF MINUS 63LF OF DRIVE = 698LF	
1 CANOPY TREE/35 LF	20 TREES
CONTINUOUS HEDGE MAX. 36" O.C.	551 SHRUBS
R.O.W. LANDSCAPE BUFFER REQUIREMENTS SEC. 3.7.6 & SEC. 4.2.F.1	
REQUIRED	PROVIDED
EAST R.O.W. PROPERTY LINE BUFFER TYPE 1 PERIMETER BUFFER 635LF MINUS 77LF OF DRIVE = 558LF	
2 CANOPY TREE / 100 LF	11 TREES
30 SHRUBS / 100 LF	167 SHRUBS
NOTE: The east property line has been designed to follow Type 1 Perimeter Buffer requirements due to the possibility of the adjacent parcel being zoned for residential use.	
PARKING ISLANDS SEC. 3.7.5.B	
REQUIRED	PROVIDED
TERMINAL ISLANDS	
1 CANOPY TREE	46 TREES
SHRUBS, ACCENT PLANTS, & ORNAMENTAL GRASSES 2' SETBACK FROM BOC WHERE ADJ. TO PARKING	COMPLIES
INTERIOR ISLANDS	
1 CANOPY TREE	40 TREES
2' SETBACK ON PLANT MATERIALS WHERE ADJ. TO PARKING	COMPLIES
MINIMUM 10% OF THE PARKING LOT MUST BE DEVOTED TO INTERIOR LANDSCAPING. TERMINAL AND INTERIOR ISLANDS CAN COUNT TOWARDS THIS REQUIREMENT, BUT BUFFERS CANNOT.	
REQUIRED	PROVIDED
TOTAL TREES	152 TREES
TOTAL SHRUBS	1,851 SHRUBS

BOHLER

SITE CIVIL AND CONSULTING ENGINEERING
PROGRAM MANAGEMENT
LANDSCAPE ARCHITECTURE
SUSTAINABLE DESIGN
PERMITTING SERVICES
TRANSPORTATION SERVICES

REVISIONS				
REV	DATE	COMMENT	CHECKED BY	DRAWN BY
1	9/11/25	CITY OF VENICE	EP	KA
2	11/6/2025	CITY OF VENICE	SH	KA

811

KNOW WHAT'S BELOW
ALWAYS CALL 811
BEFORE YOU DIG
It's Not. It's Free. It's the Way.
www.call811shine.com

ISSUED FOR MUNICIPAL & AGENCY REVIEW & APPROVAL

THIS DRAWING IS INTENDED FOR MUNICIPAL AND/OR AGENCY REVIEW AND APPROVAL. IT IS NOT INTENDED AS A CONSTRUCTION DOCUMENT UNLESS INDICATED OTHERWISE.

PROJECT No.: FLA250080-00-0A
DRAWN BY: TM/EP
CHECKED BY: BW/KA
DATE: 9/15/25
CAD ID: P-CIVL-LAND

PROJECT:

SITE
CONSTRUCTION
PLANS
FOR
THE HOME DEPOT
VENICE

LAUREL ROAD & TWIN
LAUREL BOULEVARD
NOKOMIS, FL 34275
CITY OF VENICE
S 29; T 38 S; R 19 E

BOHLER

600 N. WESTSHORE BLVD. SUITE 950
TAMPA, FLORIDA 33609
Phone: (813) 812-4100
Fax: (813) 812-4101
FLORIDA BUSINESS CERT. OF AUTH. No. 30780





THIS ITEM HAS BEEN DIGITALLY SIGNED AND SEALED BY BRETT MICHAEL WALDMAN, L.A. ON THE DATE ADJACENT TO THE SEAL. SIGNATURE MUST BE VERIFIED ON ANY ELECTRONIC COPIES.

OVERALL LANDSCAPE PLAN

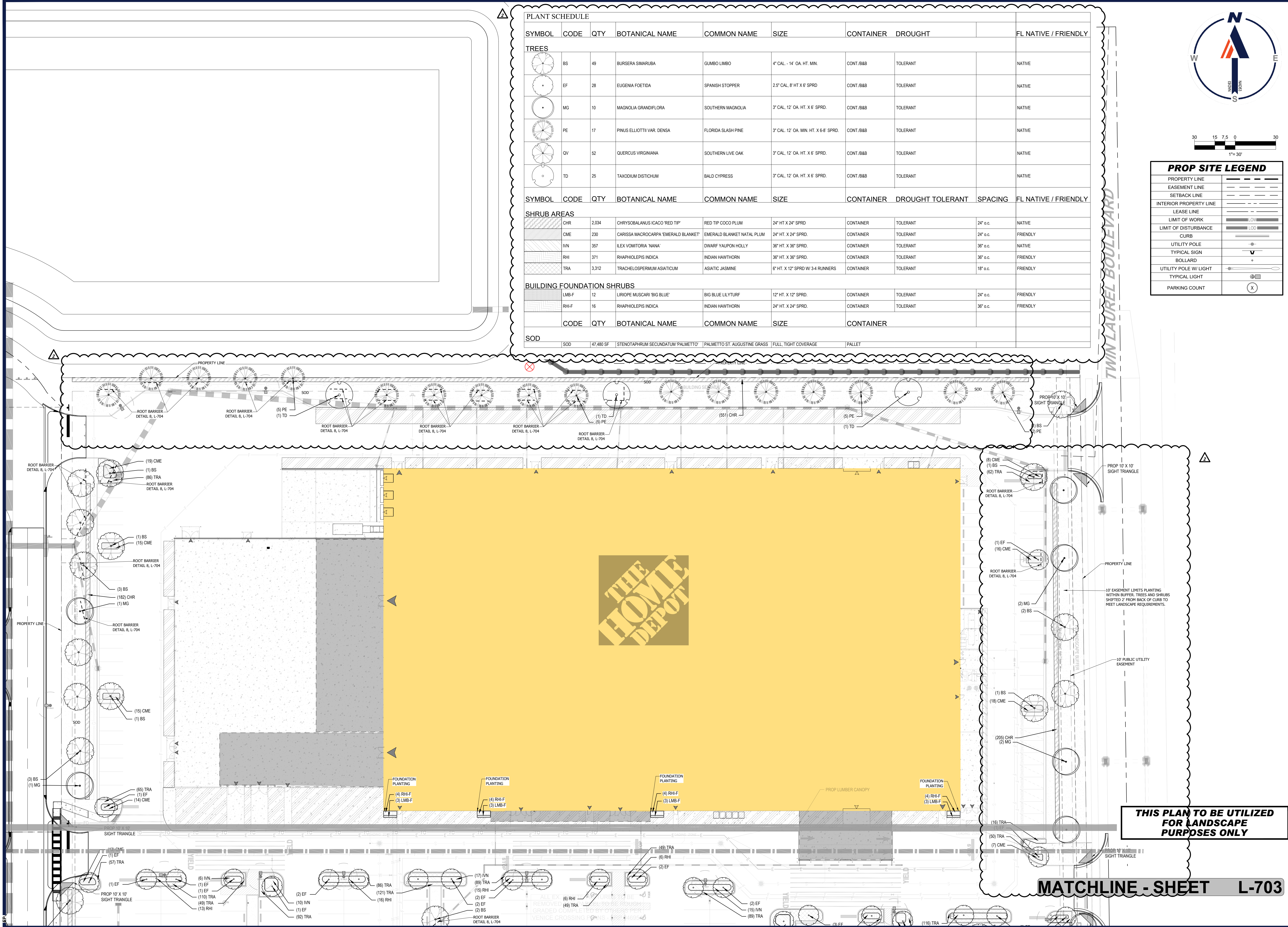
SHEET NUMBER:
L-701
REVISION 2 - 11/06/25

Nov 20, 2025
H:\3025\FLA250800\00-CAD\DRAWINGS\PLAN SETS\CIVIL\LAND-FLA250800-00-0A-...-JANOUT: L702 LANDSCAPE PLAN



PLANT SCHEDULE									
SYMBOL	CODE	QTY	BOTANICAL NAME	COMMON NAME	SIZE	CONTAINER	DROUGHT		FL NATIVE / FRIENDLY
TREES									
	BS	49	BURSERA SIMARUBA	GUMBO LIMBO	4" CAL. - 14' OA. HT. MIN.	CONT./B&B	TOLERANT		NATIVE
	EF	28	EUGENIA FOETIDA	SPANISH STOPPER	2.5" CAL. 8' HT X 6' SPRD	CONT./B&B	TOLERANT		NATIVE
	MG	10	MAGNOLIA GRANDIFLORA	SOUTHERN MAGNOLIA	3" CAL. 12' OA. HT. X 6' SPRD.	CONT./B&B	TOLERANT		NATIVE
	PE	17	PINUS ELLIOTTII VAR. Densa	FLORIDA SLASH PINE	3" CAL. 12' OA. MIN. HT. X 6-8' SPRD.	CONT./B&B	TOLERANT		NATIVE
	QV	52	QUERCUS VIRGINIANA	SOUTHERN LIVE OAK	3" CAL. 12' OA. HT. X 6' SPRD.	CONT./B&B	TOLERANT		NATIVE
	TD	25	TAXODIUM DISTICHUM	BALD CYPRESS	3" CAL. 12' OA. HT. X 6' SPRD.	CONT./B&B	TOLERANT		NATIVE
SYMBOL	CODE	QTY	BOTANICAL NAME	COMMON NAME	SIZE	CONTAINER	DROUGHT TOLERANT	SPACING	FL NATIVE / FRIENDLY
SHRUB AREAS									
	CHR	2,034	CHRYSOBALANUS ICACO 'RED TIP'	RED TIP COCO PLUM	24" HT X 24" SPRD	CONTAINER	TOLERANT	24" o.c.	NATIVE
	CME	230	CARISSA MACROCARPA 'EMERALD BLANKET'	EMERALD BLANKET NATAL PLUM	24" HT. X 24" SPRD.	CONTAINER	TOLERANT	24" o.c.	FRIENDLY
	I/VN	357	ILEX VOMITORIA 'NANA'	DWARF YAUPOH HOLLY	36" HT. X 36" SPRD.	CONTAINER	TOLERANT	36" o.c.	NATIVE
	RHI	371	RHAPHIOLEPIS INDICA	INDIAN HAWTHORN	36" HT. X 36" SPRD.	CONTAINER	TOLERANT	36" o.c.	FRIENDLY
	TRA	3,312	TRACHELOSPERMUM ASIATICUM	ASIATIC JASMINE	6" HT. X 12" SPRD W/ 3-4 RUNNERS	CONTAINER	TOLERANT	18" o.c.	FRIENDLY
BUILDING FOUNDATION SHRUBS									
	LMB-F	12	LIRIOPE MUSCARI 'BIG BLUE'	BIG BLUE LILYTURF	12" HT. X 12" SPRD.	CONTAINER	TOLERANT	24" o.c.	FRIENDLY
	RHI-F	16	RHAPHIOLEPIS INDICA	INDIAN HAWTHORN	24" HT. X 24" SPRD.	CONTAINER	TOLERANT	36" o.c.	FRIENDLY
	CODE	QTY	BOTANICAL NAME	COMMON NAME	SIZE	CONTAINER			
SOD									
	SOD	47,480 SF	STENOTAPHRUM SECUNDATUM 'PALMETTO'	PALMETTO ST. AUGUSTINE GRASS	FULL, TIGHT COVERAGE	PALLET			



PROP SITE LEGEND	
PROPERTY LINE	---
EASEMENT LINE	---
SETBACK LINE	---
INTERIOR PROPERTY LINE	---
LEASE LINE	---
LIMIT OF WORK	---
LIMIT OF DISTURBANCE	---
CURB	---
UTILITY POLE	---
TYPICAL SIGN	---
BOLLARD	---
UTILITY POLE W/ LIGHT	---
TYPICAL LIGHT	---
PARKING COUNT	---

TM

BOHLER

SITE CIVIL AND CONSULTING ENGINEERING
PROGRAM MANAGEMENT
LANDSCAPE ARCHITECTURE
SUSTAINABLE DESIGN
PERMITTING SERVICES
TRANSPORTATION SERVICES

REVISIONS				
REV	DATE	COMMENT	CHECKED BY	DRAWN BY
1	9/11/25	CITY OF VENICE	EP	KA
2	11/6/2025	CITY OF VENICE	SH	KA

811

KNOW WHAT'S BELOW
ALWAYS CALL 811
BEFORE YOU DIG
It's Not. It's Free. It's the Law.
www.call811shrine.com

ISSUED FOR MUNICIPAL & AGENCY REVIEW & APPROVAL

THIS DRAWING IS INTENDED FOR MUNICIPAL AND/OR AGENCY REVIEW AND APPROVAL. IT IS NOT INTENDED AS A CONSTRUCTION DOCUMENT UNLESS INDICATED OTHERWISE.

PROJECT No.: FLA250800-00-0A
DRAWN BY: TM/EP
CHECKED BY: BW/KA
DATE: 9/15/25
CAD I.D.: P-CIVIL-LAND

PROJECT:

SITE
CONSTRUCTION
PLANS

FOR

THE HOME DEPOT
VENICE

LAUREL ROAD & TWIN
LAUREL BOULEVARD
NOKOMIS, FL 34275
CITY OF VENICE
S 29; T 38 S; R 19 E

BOHLER

600 N. WESTSHORE BLVD. SUITE 950
TAMPA, FLORIDA 33609
Phone: (813) 812-4100
Fax: (813) 812-4101

FLORIDA BUSINESS CERT. OF AUTH. No. 30780

THIS ITEM HAS BEEN DIGITALLY SIGNED AND SEALED BY BRETT MICHAEL WALDMAN, L.A. ON THE DATE ADJACENT TO THE SEAL. SIGNATURE MUST BE VERIFIED ON ANY ELECTRONIC COPIES.

SHEET TITLE:

**LANDSCAPE
PLAN**

SHEET NUMBER:

L-702

REVISION 2 - 11/06/25

THIS PLAN TO BE UTILIZED FOR LANDSCAPE PURPOSES ONLY

MATCHLINE - SHEET L-703

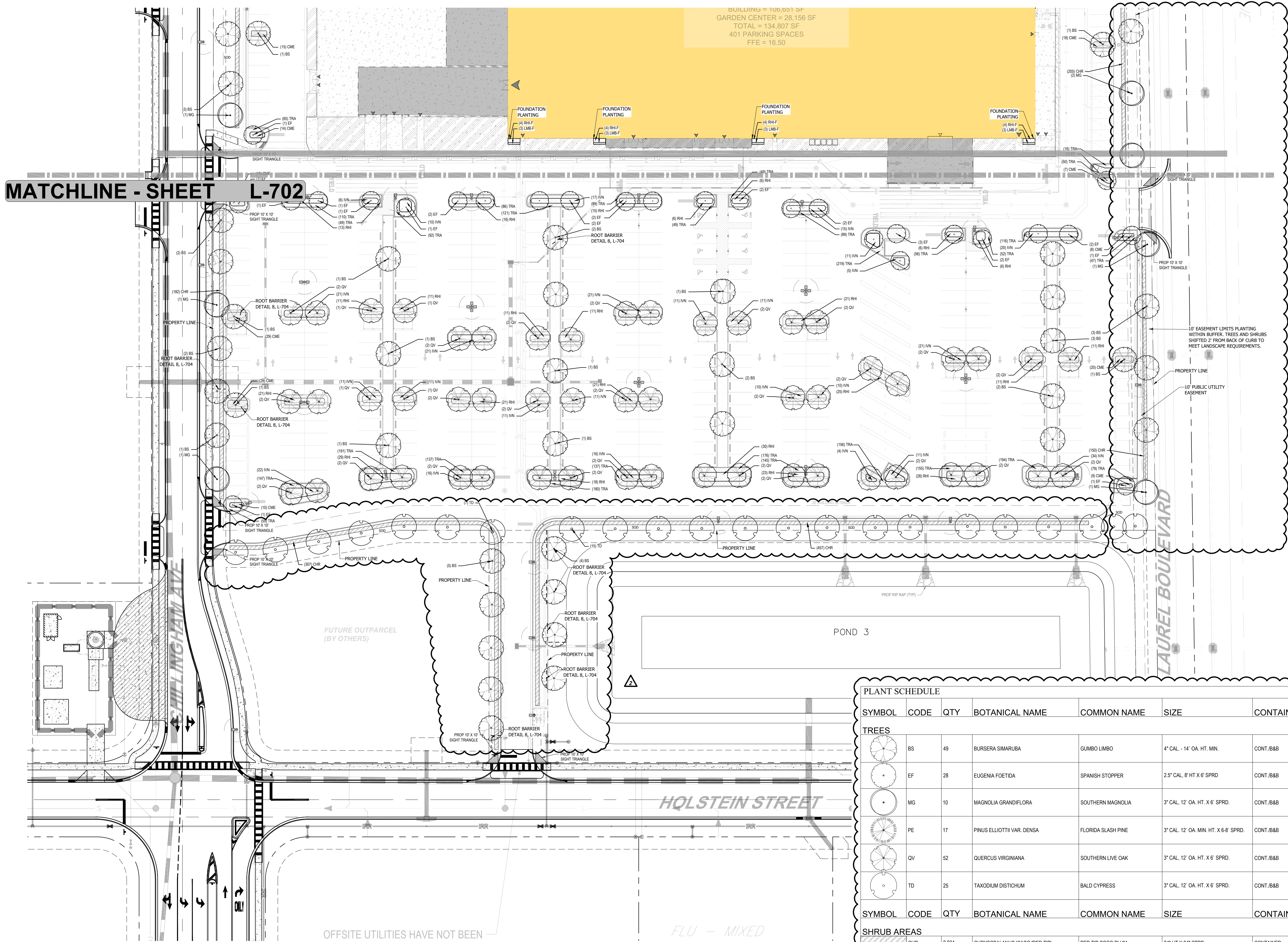

PROP SITE LEGEND	
PROPERTY LINE	---
EASEMENT LINE	---
SETBACK LINE	---
INTERIOR PROPERTY LINE	---
LEASE LINE	---
LIMIT OF WORK	LOW
LIMIT OF DISTURBANCE	LOD
CURB	---
UTILITY POLE	⊕
TYPICAL SIGN	⊕
BOLLARD	⊕
UTILITY POLE W/ LIGHT	⊕
TYPICAL LIGHT	⊕
PARKING COUNT	⊕

PLANT SCHEDULE

SYMBOL	CODE	QTY	BOTANICAL NAME	COMMON NAME	SIZE	CONTAINER	DROUGHT		FL NATIVE / FRIENDLY
TREES									
	BS	49	BURSERIA SIMARUBA	GUMBO LIMBO	4" CAL. - 14' OA. HT. MIN.	CONT./B&B	TOLERANT		NATIVE
	EF	28	EUGENIA FOETIDA	SPANISH STOPPER	2.5" CAL. 6' HT. X 6' SPRD	CONT./B&B	TOLERANT		NATIVE
	MG	10	MAGNOLIA GRANDIFLORA	SOUTHERN MAGNOLIA	3" CAL. 12' OA. HT. X 6' SPRD.	CONT./B&B	TOLERANT		NATIVE
	PE	17	PINUS ELLIOTTII VAR. DENSE	FLORIDA SLASH PINE	3" CAL. 12' OA. MIN. HT. X 6-8' SPRD.	CONT./B&B	TOLERANT		NATIVE
	QV	52	QUERCUS VIRGINIANA	SOUTHERN LIVE OAK	3" CAL. 12' OA. HT. X 6' SPRD.	CONT./B&B	TOLERANT		NATIVE
	TD	25	TAXODIUM DISTICHUM	BALD CYPRESS	3" CAL. 12' OA. HT. X 6' SPRD.	CONT./B&B	TOLERANT		NATIVE
SYMBOL	CODE	QTY	BOTANICAL NAME	COMMON NAME	SIZE	CONTAINER	DROUGHT TOLERANT	SPACING	FL NATIVE / FRIENDLY
SHRUB AREAS									
	CHR	2,034	CHRYSOBALANUS ICAGO 'RED TIP'	RED TIP COCO PLUM	24" HT. X 24" SPRD	CONTAINER	TOLERANT	24" o.c.	NATIVE
	CME	230	CARISSA MACROCARPA 'EMERALD BLANKET'	EMERALD BLANKET NATAL PLUM	24" HT. X 24" SPRD.	CONTAINER	TOLERANT	24" o.c.	FRIENDLY
	WN	357	ILEX VOMITORIA 'NANA'	DWARF YALPON HOLLY	36" HT. X 36" SPRD.	CONTAINER	TOLERANT	36" o.c.	NATIVE
	RH	371	RHAPHIOLEPIS INDICA	INDIAN HAWTHORN	36" HT. X 36" SPRD.	CONTAINER	TOLERANT	36" o.c.	FRIENDLY
	TRA	3,312	TRACHELOSPERMUM ASIATICUM	ASIATIC JASMINE	6" HT. X 12" SPRD. W/ 3-4 RUNNERS	CONTAINER	TOLERANT	18" o.c.	FRIENDLY
BUILDING FOUNDATION SHRUBS									
	LMB-F	12	LIRIOPE MUSCARI 'BIG BLUE'	BIG BLUE LILYTURF	12" HT. X 12" SPRD.	CONTAINER	TOLERANT	24" o.c.	FRIENDLY
	RH-F	16	RHAPHIOLEPIS INDICA	INDIAN HAWTHORN	24" HT. X 24" SPRD.	CONTAINER	TOLERANT	36" o.c.	FRIENDLY
	CODE	QTY	BOTANICAL NAME	COMMON NAME	SIZE	CONTAINER			
SOD									
	SOD	47,480 SF	STENOTAPHRUM SECUNDATUM 'PALMETTO'	PALMETTO ST. AUGUSTINE GRASS	FULL, TIGHT COVERAGE	PALLET			

THIS PLAN TO BE UTILIZED
FOR LANDSCAPE
PURPOSES ONLY

BOHLER

SITE CIVIL AND CONSULTING ENGINEERING
PROGRAM MANAGEMENT
LANDSCAPE ARCHITECTURE
SUSTAINABLE DESIGN
PERMITTING SERVICES
TRANSPORTATION SERVICES

REVISIONS			
REV	DATE	COMMENT	DRAWN BY
1	9/11/25	CITY OF VENICE	EP
2	11/6/2025	CITY OF VENICE	KA

811

KNOW WHAT'S BELOW
ALWAYS CALL 811
BEFORE YOU DIG
It's Not. It's Not. It's Not.
www.call811shines.com

ISSUED FOR MUNICIPAL & AGENCY REVIEW & APPROVAL

THIS DRAWING IS INTENDED FOR MUNICIPAL AND/OR AGENCY REVIEW AND APPROVAL. IT IS NOT INTENDED AS A CONSTRUCTION DOCUMENT UNLESS INDICATED OTHERWISE.

PROJECT No.: FLA250800 00-0A
DRAWN BY: TM/EP
CHECKED BY: BW/KA
DATE: 9/15/25
CAD ID: P- CIVIL-LAND

SITE
CONSTRUCTION
PLANS
FOR

THE HOME DEPOT
VENICE
LAUREL ROAD & TWIN
LAUREL BOULEVARD
NOKOMIS, FL 34275
CITY OF VENICE
S 29; T 38 S; R 19 E

BOHLER

600 N. WESTSHORE BLVD. SUITE 950
TAMPA, FLORIDA 33609
Phone: (813) 812-4100
Fax: (813) 812-4101
FLORIDA BUSINESS CERT. OF AUTH. No. 30780

THIS ITEM HAS BEEN DIGITALLY SIGNED AND SEALED BY BRETT MICHAEL WALDMAN, L.A. ON THE DATE ADJACENT TO THE SEAL. SIGNATURE MUST BE VERIFIED ON ANY ELECTRONIC COPIES.

SHEET TITLE:
**LANDSCAPE
PLAN**

SHEET NUMBER:
L-703

REVISION 2 - 11/06/25



REVISIONS

[illegible]

ISSUED FOR MUNICIPAL &
AGENCY REVIEW & APPROVAL

THIS DRAWING IS INTENDED FOR MUNICIPAL AND/OR AGENCY
REVIEW AND APPROVAL. IT IS NOT INTENDED AS A CONSTRUCTION
DOCUMENT UNLESS INDICATED OTHERWISE.

PROJECT No.:	FLA250080.00-0A
DRAWN BY:	TM/EP
CHECKED BY:	BW/KA
DATE:	9/15/25
CAD I.D.:	P- CIVL-LAND

PROJECT:

**SITE
CONSTRUCTION
PLANS**



THE HOME DEPOT
VENICE

LAUREL ROAD & TWIN
LAUREL BOULEVARD
NOKOMIS, FL 34275
CITY OF VENICE
S 29; T 38 S; R 19 E

BOHLER 

600 N. WESTSHORE BLVD. SUITE 95
TAMPA, FLORIDA 33609
Phone: (813) 812-4100
Fax: (813) 812-4101

FLORIDA BUSINESS CERT. OF AUTH. No. 3078

THIS ITEM HAS BEEN DIGITALLY SIGNED AND
SEALED BY BRETT MICHAEL WALDMAN, LA, ON THE
DATE ADJACENT TO THE SEAL. SIGNATURE MUST
BE VERIFIED ON ANY ELECTRONIC COPIES.

SHEET TITLE:

LANDSCAPE DETAILS

SHEET NUMBER:

L-704

REVISION 2 - 11/06/25

Nov 20, 2025
H:\2025\FLA250080\00\CAD\DRAWINGS\PLAN SET\3\CIVIL PLANS\BP-CIVIL-LAND-FLA250080-00.dwg-->JAYCUT: L706 LANDSCAPE NOTES

LANDSCAPE NOTES:

1. A PRE-INSTALLATION MEETING WITH THE CITY ARBORIST IS REQUIRED PRIOR TO LANDSCAPING ACTIVITIES INCLUDING REMOVAL OF TREES AND/OR INSTALLATION OF PLANT MATERIAL.

2. ALL EXISTING TREES PROPOSED TO REMAIN ARE TO BE SEPARATED FROM THE LIMITS OF DISTURBANCE OF THE CONSTRUCTION AREA BY TREE PROTECTION FENCING AND SIGNAGE. THE TREE PROTECTION FENCING SHALL BE LOCATED AT THE EDGE OF THE TREE PROTECTION ZONE AS DEPICTED ON THE PLAN OR AT THE EDGE OF THE DRIPLINE(S) IF A TREE PROTECTION ZONE IS NOT DESIGNATED. NO MATERIAL STORAGE OR CONSTRUCTION ACCESS IS PERMITTED WITHIN THE TREE PROTECTION ZONE.

3. ALL EXISTING TREES SHALL BE PRUNED TO ANSI A-300 STANDARDS TO CORRECT POTENTIAL HAZARDS.

4. A TREE REMOVAL PERMIT IS REQUIRED PRIOR TO REMOVAL OR RELOCATION OF ANY TREE OR PALM. CONTACT THE COUNTY TO OBTAIN PERMIT INFORMATION.

5. CONTRACTOR SHALL NOTIFY SUNSHINE ONE CALL OF FLORIDA, INC. AT 1-800-432-4770 A MINIMUM OF 2 FULL BUSINESS DAYS PRIOR TO DIGGING. CONTRACTOR IS RESPONSIBLE FOR AVOIDING DAMAGE TO UTILITIES FROM PLANT INSTALLATION.

6. TREE RELOCATIONS:

A. EXISTING TREES TO BE RELOCATED SHALL BE ROOT PRUNED A MINIMUM OF 120 DAYS PRIOR TO RELOCATION

B. MINIMUM ROOT BALL SIZES SHALL BE IN ACCORDANCE WITH ANSI STANDARDS AS FOLLOWS:

CAL/PER	MINIMUM ROOT BALL DIAMETER
1	16
2	24
3	32
4	42
5	54
6	60
7	70
8	80
>8	12 INCHES PER INCH OF TRUNK DIAMETER

TRANSPLANTED TREES WITH UNDERSIZED ROOT BALLS MAY BE REJECTED BY THE CITY ARBORIST AND REPLACEMENT TREES MAY BE REQUIRED.

C. A TEMPORARY IRRIGATION SYSTEM SHALL BE PROVIDED DURING AND FOR THE FIRST 40 DAYS AFTER ROOT PRUNING.

7. ALL PLANTING MUST FOLLOW PLANTING SPECIFICATIONS AND DETAILS SHOWN ON THE PLAN.

8. SUBSTITUTIONS OF PLANT SPECIES OR SPECIFICATIONS MUST BE APPROVED IN WRITING BY THE CITY AND COUNTY PRIOR TO USE.

9. ALL INVASIVE EXOTIC VEGETATION SHALL BE DISPOSED OF OR TREATED AS PER THE LOCAL OR REGIONAL GOVERNING AUTHORITIES REQUIREMENTS OR RECOMMENDATIONS.

10. ALL PLANT MATERIAL PLANTED PER THIS LANDSCAPE PLAN SHALL BE FLORIDA GRADE #1 OR BETTER, AS SPECIFIED IN THE CURRENT EDITION OF THE FLORIDA DEPARTMENT OF AGRICULTURE'S GRADES AND STANDARDS FOR NURSERY PLANTS. DAMAGED PLANT MATERIAL SHALL BE REJECTED AND REPLACED PRIOR TO INSTALLATION.

11. ALL SIZES SHOWN FOR PLANT MATERIAL ARE TO BE CONSIDERED MINIMUMS.

12. WHERE QUANTITIES AND/OR SPECIES DIFFER BETWEEN THE PLANTING PLANS AND PLANT LISTS, THE PLANS SHALL TAKE PRECEDENCE.

13. ALL NEW PLANT MATERIAL SHALL BE WARRANTED BY THE CONTRACTOR FOR A MINIMUM PERIOD OF ONE YEAR. THE WARRANTY PERIOD SHALL BEGIN AFTER ACCEPTANCE OF THE PLANTS BY THE CITY AND COUNTY.

14. PLANT BEDS TO BE TREATED WITH PRE-EMERGENT HERBICIDE PRIOR TO PLANTING.

15. ALL TREE AND PALM STAKING AND SUPPORT SHALL BE REMOVED ONE YEAR AFTER INSTALLATION.

16. ALL LANDSCAPE MATERIAL SHALL BE THOROUGHLY WATERED AT THE TIME OF PLANTING, NO DRY PLANTING PERMITTED.

17. CONTRACTOR SHALL BE RESPONSIBLE FOR PROVIDING TEMPORARY WATER PROVISIONS UNTIL SUCH TIME AS THE IRRIGATION SYSTEM IS OPERATIONAL.

18. ALL WIRE GUYS AND/OR FABRIC STRAPS SHALL BE FLAGGED WITH FLORESCENT COLORED TAPE.

19. MULCHING:

A. ALL LANDSCAPE AREAS NOT COVERED BY SOD SHALL BE COVERED BY A MINIMUM 3-INCH LAYER OF MULCH.

D. A MULCH RING WITH A MINIMUM RADIUS OF 24 INCHES (48 INCH DIAMETER), IS REQUIRED AROUND ALL NEWLY INSTALLED TREES AND PALMS.

E. CYPRESS OR COLORED MULCH SHALL NOT BE USED.

F. NO MULCH SHALL BE PLACED TOUCHING OR WITHIN SIX INCHES OF THE TRUNK OF A TREE OR PALM.

19. ALL NEWLY LANDSCAPED AREAS SHALL BE EXCAVATED DOWN TO A DEPTH OF 24 INCHES BELOW FINAL GRADE AND BACK FILLED WITH CLEAN DEBRIS-FREE SOIL. EXISTING SOIL MAY BE RE-USED FOR BACKFILLING IF DEBRIS IS REMOVED AND ORGANIC CONTENT IS SUFFICIENT OR SOIL IS AUGMENTED WITH TOPSOIL. CONSTRUCTION ACCESS SHALL BE RESTRICTED FROM THE LANDSCAPE AREA AFTER EXCAVATION AND BACKFILL IS COMPLETE.

20. ALL LANDSCAPE AREAS SHALL BE FINISH GRADED SUCH THAT THEY ARE A MINIMUM OF 3.5 INCHES BELOW SURROUNDING PAVED SURFACES SO AS NOT TO IMPEDE THE FLOW OF DRAINAGE INTO LANDSCAPED AREAS AND TO ALLOW FOR A 3-INCH MULCH LAYER.

21. THE LOCATION OF PLANT MATERIAL AS SHOWN ON THESE PLANS IS FINAL. THE FINAL LOCATIONS CAN BE ADJUSTED ON SITE TO ACCOMMODATE UNFORESEEN FIELD CONDITIONS. THESE CHANGES MUST COMPLY WITH ALL SAFETY SETBACK CRITERIA AND BE DIRECTED OR APPROVED BY THE CONSULTANT AND THE COUNTY CODES.

22. REPORT ANY AND ALL DISCREPANCIES BETWEEN THE CONSTRUCTION DRAWINGS AND FIELD CONDITIONS TO THE CONSULTANT AND COUNTY IMMEDIATELY.

23. THE CONTRACTOR IS RESPONSIBLE FOR VERIFYING ALL PLANT COUNTS AND REPORT ANY DISCREPANCIES TO THE CONSULTANT AND COUNTY PRIOR TO CONSTRUCTION.

24. BEFORE CONSTRUCTION BEGINS THE CONTRACTOR IS RESPONSIBLE FOR LOCATING ALL UNDERGROUND UTILITIES AND SHALL AVOID DAMAGE TO ALL UTILITIES DURING CONSTRUCTION. IF SUCH DAMAGE OCCURS THE CONTRACTOR IS RESPONSIBLE FOR ANY NECESSARY REPAIRS AND THEY SHOULD BE MADE IMMEDIATELY AT THE CONTRACTORS EXPENSE.

25. ALL WORK MUST COMPLY WITH THE FLORIDA STATE STATUTE 553.81- "PROTECTION OF UNDERGROUND PIPELINES."

26. THE CONTRACTOR MUST COMPLY WITH ALL STATE AND LOCAL WATER QUALITY STANDARDS.

27. THE LOCATION OF ALL THE UTILITIES SHOWN ON THE PLAN IS APPROXIMATE. THE EXACT LOCATION SHALL BE DETERMINED BY THE CONTRACTOR ON SITE. ALL PLANTING MAY BE ADJUSTED TO AVOID CONFLICTS WITH UTILITIES AND/OR EXISTING ABOVE GROUND ELEMENTS. ANY ADJUSTMENTS GREATER THAN 10 FEET SHALL BE DONE ONLY WITH THE APPROVAL OF THE CONSULTANT AND THE COUNTY.

28. CAUTION SHOULD BE EXERCISED WHEN WORKING NEAR EXISTING PLANTING AND ANY FURNISHING THAT IS TO REMAIN ON SITE TO PREVENT ANY DAMAGE. ANY SIGNS, STRUCTURES, OR PLANTING SHALL BE REPLACED AT THE CONTRACTORS EXPENSE IF DAMAGED BEYOND USE. DAMAGED BEYOND USE WILL BE DETERMINED BY THE CONSULTANT AND THE COUNTY.

29. ANY PUBLIC LAND CORNER WITHIN THE LIMITS OF CONSTRUCTION IS TO BE PROTECTED. IF A CORNER MONUMENT IS IN DANGER OF BEING DESTROYED AND HAS NOT BEEN PROPERLY REFERENCED, THE CONTRACTOR SHALL NOTIFY THE DISTRICT LOCATION SURVEYOR IMMEDIATELY.

30. MAINTENANCE OF TRAFFIC FOR THIS PROJECT SHALL BE IN ACCORDANCE WITH THE MANUAL OF UNIFORM TRAFFIC CONTROL DEVICES FOR STREETS AND HIGHWAYS (U.S. DEPARTMENT OF TRANSPORTATION, F.H.W.A.). ATTENTION IS DIRECTED TO STANDARD INDEX NUMBER 623 OF THE ROADWAY AND TRAFFIC DESIGN STANDARDS.

31. THE CONTRACTOR SHALL INSURE THAT INSTALLATION OF ALL PLANTING IN MEDIANS AND RIGHT OF WAYS CONFORMS TO CRITERIA SET FORTH IN F.D.O.T. ROADWAY AND TRAFFIC DESIGN STANDARDS AND IN F.D.O.T. MAINTENANCE RATING PROGRAM.

32. ANY MAINTENANCE THAT INVOLVES TRAFFIC ACTIVITY SHALL BE COORDINATED WITH THE COUNTY BEFORE AND DURING CONSTRUCTION ACTIVITIES.

33. CONTRACTOR IS RESPONSIBLE FOR CLEANING ALL WORK AREAS AT THE END OF EACH WORKING DAY. ANY DEBRIS SHALL BE COLLECTED AND DEPOSITED APPROPRIATELY OFF SITE DAILY. ALL MATERIALS, PRODUCTS, AND EQUIPMENT SHALL BE STORED IN AN ORGANIZED FASHION.

34. THE CONTRACTOR IS RESPONSIBLE FOR OBTAINING ALL PERMITS THAT ARE REQUIRED BY THE CITY FOR TREE REMOVAL, RELOCATION, TREE PROTECTION OR INSTALLATION BEFORE BEGINNING WORK.

35. ALL EXISTING TREES TO REMAIN SHALL BE PROTECTED BY INSTALLING PROTECTIVE BARRIERS AROUND THE DRIP LINE OF TREES. THESE PROTECTIVE BARRIERS SHALL BE SEEN EASILY BY OPERATORS OF TRUCKS AND OTHER EQUIPMENT. THEY SHALL BE CONSTRUCTED OF STURDY MATERIALS (NOT FLAGGING OR RIBBON) AND SHALL BE INSTALLED PRIOR TO AND DURING CONSTRUCTION.

36. DO NOT STORE OR USE ANY MATERIALS OR EQUIPMENT WITHIN THE DRIP LINE OF ANY TREE THAT IS TO BE RELOCATED OR PROTECTED IN PLACE UNLESS THE ACTIVITY IS BEING DONE TO PROTECT THE TREES.

37. DO NOT DISCHARGE OR CONTAMINATE THE SOIL WITHIN THE DRIP LINE OF ANY OF THE TREES TO BE RELOCATED OR PROTECTED IN PLACE. THIS INCLUDES SUBSTANCES SUCH AS PAINT, OIL, SOLVENTS, PETROLEUM PRODUCTS, ASPHALT, CONCRETE, MORTAR, OR ANY OTHER MATERIAL THAT MAY CAUSE DAMAGE TO THE TREE'S ROOT SYSTEM.

38. CLEARING OF VEGETATION WITHIN THE DRIP LINE OF THE TREES DESIGNATED TO BE PROTECTED IN PLACE OR RELOCATED SHALL BE PERFORMED CAUTIOUSLY WITH HAND TOOLS TO MINIMIZE ANY DAMAGE TO THE TREE'S ROOT SYSTEM.

39. DO NOT ATTACH ANYTHING TO TREES THAT ARE TO REMAIN ON THE SITE UNLESS IT IS SOMETHING THAT WILL PROTECT AND NOT DAMAGE THE TREE.

40. KEEP A NATURAL GRADE ABOVE THE DRIP LINE ON ANY TREE THAT IS TO BE PROTECTED IN PLACE. ANY PRESERVED TREES DISTURBED DURING CONSTRUCTION MUST BE RETURNED TO ITS ORIGINAL GRADE AFTER CONSTRUCTION.

41. ALL LANDSCAPE AND PLANTING SHALL COMPLY WITH COUNTY LAND USE POLICY AND WITH CHAPTER 62B-55 OF THE FLORIDA ADMINISTRATIVE CODE.

42. ALL PLANT MATERIAL FURNISHED BY THE CONTRACTOR UNLESS OTHERWISE SPECIFIED SHALL BE FLORIDA NO. 1 GRADE OR BETTER, AND SHALL BE INSTALLED AS SPECIFIED IN "GRADES AND STANDARDS FOR NURSERY PLANTS," PUBLISHED BY THE FLORIDA DEPARTMENT OF AGRICULTURE AND CONSUMER SERVICES. ALL PLANT MATERIAL MUST BE HEALTHY, VIGOROUS MATERIALS, FREE OF PESTS AND DISEASES.

43. ALL SIZES SHOWN FOR PLANT MATERIAL ON THE PLAN ARE TO BE CONSIDERED AS MINIMUMS. ALL PLANT MATERIAL MUST MEET OR EXCEED THESE MINIMUM REQUIREMENTS FOR BOTH HEIGHT AND SPREAD. ANY OTHER REQUIREMENTS FOR SPECIFIC SHAPE OR EFFECT AS NOTED ON THE PLAN OR SPECIFICATIONS WILL ALSO BE REQUIRED FOR ACCEPTANCE. ANY SUBSTITUTIONS MUST BE APPROVED BY THE CONSULTANT AND THE COUNTY.

44. THE CONTRACTOR IS RESPONSIBLE FOR ALL PLANTING MEETING SPECIFICATIONS AS NOTED BEFORE INSTALLATION. CONTRACTOR SHALL IMMEDIATELY REMOVE ALL PLANTING THAT DOES NOT MEET SPECIFICATIONS AND BE HELD RESPONSIBLE TO REPLACE IT WITH APPROPRIATE PLANTING.

45. IN THE EVENT OF A VARIATION BETWEEN THE PLANT LISTS AND THE ACTUAL QUANTITY OF PLANTS SHOWN, THE PLANS HOLD TRUE.

46. ALL ROOT BALLS SHALL CONFORM TO THE SIZE STANDARDS SET FORTH.

47. ALL PLANT MATERIALS MUST BE PROTECTED DURING TRANSPORT AND DELIVERY TO THE JOB SITE WITH SHADE CLOTH OR OTHER ACCEPTABLE MEANS OF WINDBURN PREVENTION.

48. CONTRACTORS SHALL FIELD VERIFY ALL INFORMATION PRIOR TO INITIATING PLANTING INSTALLATION. ALL EXISTING PLANTING SHALL REMAIN INTACT AND UNDISTURBED UNLESS OTHERWISE NOTED ON THE PLANS.

49. CONTRACTOR SHALL FIELD STAKE THE LOCATION OF ALL PLANT MATERIAL PRIOR TO INSTALLATION FOR THE REVIEW AND APPROVAL OF THE CONSULTANT.

50. ALL TREES MUST BE FLORIDA #1, STRAIGHT TRUNKED, FULL HEADED, AND MEET ALL REQUIREMENTS SPECIFIED.

51. CONTRACTOR TO REPLACE REJECTED PLANT MATERIAL WITHIN ONE WEEK OF NOTICE.
- SOIL PREPARATION, SOIL MIX, FERTILIZER, & MULCH NOTES:
1. ENSURE THAT ALL PLANTING SOIL IS FERTILE, FRABLE, NATURAL LOAM SURFACE SOIL, REASONABLY FREE OF SUBSOIL, CLAY LUMPS, WEEDS AND OTHER LITTER, AND FREE OF ROOTS, STUMPS AND STONES LARGER THAN ONE INCH IN ANY DIMENSION, AND OTHER EXTRANEIOUS OR TOXIC MATTER HARMFUL TO PLANT GROWTH. SHOULD ANY SOIL AMENDMENT BE NECESSARY, THE CONTRACTOR SHALL BRING THIS TO THE ATTENTION OF THE CONSULTANT AND THE COUNTY.

2. APPLY APPROVED HERBICIDE, ACCORDING TO MANUFACTURERS RATE AND SPECS WITHIN LIMITS OF ALL AREAS TO BE PLANTED. PROTECT EXISTING PLANTS TO REMAIN FROM OVERSPRAY OR SPRAY WITHIN ROOT ZONE. CONTRACTOR AND COUNTY TO ENSURE TOTAL WEED ERADICATION.

3. SCARIFY SUBSOIL TO A DEPTH OF 3 INCHES.

4. PLANTING MIX FOR TREES, SHRUBS, AND GROUNDCOVERS SHALL CONSIST OF A THOROUGHLY BLENDED MIXTURE OF:

A. 20% TOPSOIL

B. 10% PEAT OR COMPOST

C. 70% SAND

5. PLANTING MIX FOR BACKFILL AROUND ROOT BALLS OF PALMS:

A. 90% NATIVE SAND FROM ON SITE OR APPROVED SUBSTITUTE

B. 10% TOPSOIL

6. FERTILIZE ALL TREES, SHRUBS AND GROUNDCOVER WITH PLANTING TABLETS 20-20-5 FORMULA, 21 GRAM.

7. ALL SHRUB BEDS SHALL BE EXCAVATED TO A MINIMUM DEPTH OF 24" AND BACK FILLED WITH THE SPECIFIED MIXTURE.

8. SMOOTH ALL PREPARED TOPSOIL TO 3" EXCEPT WITHIN DRIP LINES OF EXISTING TREES AND 4" BELOW TOP OF SURROUNDING PAVING EDGES. REMOVE ALL ROCKS AND OTHER OBJECTS OVER 1" IN DIAMETER.

9. FINISH GRADE ALL PREPARED TOPSOIL AREAS TO A SMOOTH, EVEN SURFACE ASSURING POSITIVE DRAINAGE AWAY FROM THE STRUCTURES AND ELIMINATE ANY LOW AREAS WHICH MAY COLLECT WATER.

10. TOPSOIL SHALL NOT BE EXTREMELY ACIDIC OR ALKALINE, NOR CONTAIN ANY TOXIC SUBSTANCE WHICH MAY BE HARMFUL TO PLANT GROWTH. THE PH SHALL BE IN THE RANGE OF 5.5-6.5.

11. CONTRACTOR SHALL MULCH ALL PLANTING MATERIAL THROUGHOUT AND COMPLETELY TO A 3 INCH DEPTH WITH CLEAN, WEED FREE FLORAMULCH

12. MINIMUM OF 2" TOPSOIL MUST BE ADDED UNDER ALL SODDED AREAS.
- IRRIGATION NOTES:
1. XERISCAPE PRINCIPLES HAVE BEEN APPLIED TO THIS LANDSCAPE PLAN AS SPECIFIED IN SFWMD'S XERISCAPE PLANT GUIDE II AND SHALL BE APPLIED ALL THROUGHOUT LANDSCAPE INSTALLATION AND MAINTENANCE.

2. THE CONTRACTOR SHALL MAINTAIN TEMPORARY IRRIGATION OR PROVIDE HAND WATERING FOR ALL RELOCATED TREES AND PALMS FROM NOTICE TO PROCEED UNTIL PERMANENT IRRIGATION SYSTEM IS OPERABLE.

3. THE IRRIGATION SYSTEM SHALL BE CONFIGURED TO ACCOMMODATE EXISTING TREES AND PALMS PER PLANS.

4. ALL LANDSCAPED AREAS MUST BE IRRIGATED IN ACCORDANCE WITH ALL LOCAL/COUNTY REQUIREMENTS.

5. REMOVE EXISTING IRRIGATION EQUIPMENT WHICH INTERFERES WITH ANY CONSTRUCTION. THIS INCLUDES, BUT IS NOT LIMITED TO, CONTROLLERS, SPRINKLER HEADS, PIPE, QUICK COUPLERS, BACKFLOW PREVENTERS, CONTROL WIRE AND CONDUITS. ADDITIONALLY THE CONTRACTOR IS RESPONSIBLE FOR MAINTAINING THE EXISTING SYSTEM THROUGHOUT THE CONSTRUCTION PROCESS.

6. CONTRACTOR SHALL COORDINATE ALL PLANTING WORK WITH IRRIGATION WORK. INSPECT IRRIGATION SYSTEM AND INSURE THAT ADEQUATE WATER IS AVAILABLE BEFORE BEGINNING PLANTING OPERATIONS. IRRIGATION SYSTEMS WILL NOT PROVIDE SUFFICIENT QUANTITIES OF WATER FOR NEWLY PLANTED MATERIALS. THE LANDSCAPE CONTRACTOR IS RESPONSIBLE FOR DEEP ROOT HAND WATERING.

7. IF PROVIDED, REFER TO IRRIGATION PLANS FOR ADDITIONAL NOTES AND DETAILS.
-
- ISSUED FOR MUNICIPAL & AGENCY REVIEW & APPROVAL
- THIS DRAWING IS INTENDED FOR MUNICIPAL AND/OR AGENCY REVIEW AND APPROVAL. IT IS NOT INTENDED AS A CONSTRUCTION DOCUMENT UNLESS INDICATED OTHERWISE.
- PROJECT No.: FLA250080-00-0A
DRAWN BY: TM/EP
CHECKED BY: BW/KKA
DATE: 9/15/25
CAD ID: P-CIVIL-LAND
- PROJECT:
- SITE
CONSTRUCTION
PLANS

FOR

THE HOME DEPOT
VENICE

LAUREL ROAD & TWIN
LAUREL BOULEVARD
NOKOMIS, FL 34275
CITY OF VENICE
S 29; T 38 S; R 19 E

BOHLER
600 N. WESTSHORE BLVD. SUITE 950
TAMPA, FLORIDA 33609
Phone: (813) 812-4100
Fax: (813) 812-4101

FLORIDA BUSINESS CERT. OF AUTH. No. 30780

THIS ITEM HAS BEEN DIGITALLY SIGNED AND SEALED BY BRETT MICHAEL WALDMAN, L.A. ON THE DATE ADJACENT TO THE SEAL. SIGNATURE MUST BE VERIFIED ON ANY ELECTRONIC COPIES.

SHEET TITLE:

LANDSCAPE
NOTES

SHEET NUMBER:

L-705

REVISION 2 - 11/06/25