

DATE: 8/30/04  
 DRAWN BY: J.RUIZ  
 COMPUTER NAME:  
 ANNEXATION MAP 8-27-04.DWG

1088.P

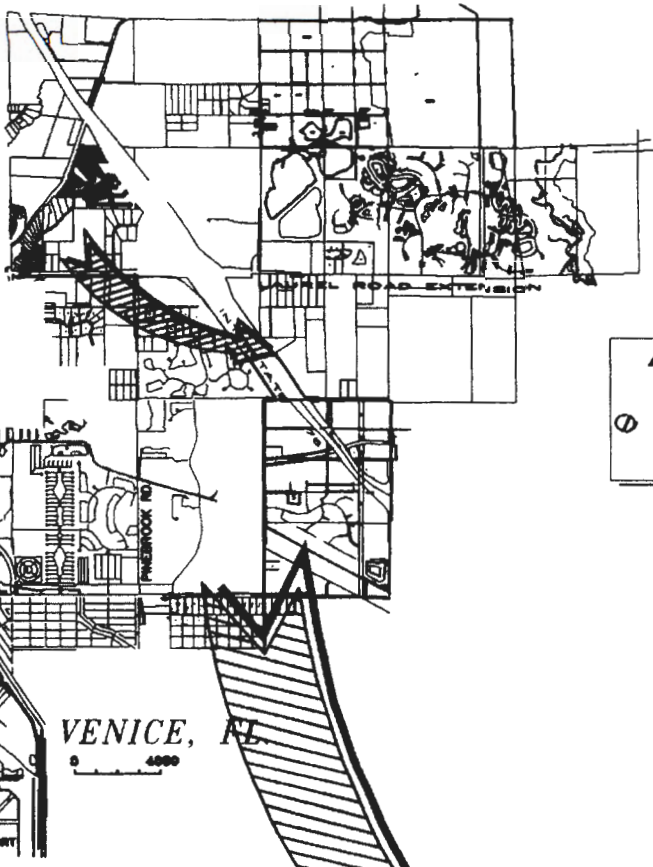

**ANNEXATION MAPS**  
 --- WALL MAP  
 --- VEN-000 --- DWC (ENCLAVE, ZONING)  
 --- ZONING --- DWC (ENCLAVE, ZONING)  
 --- MAP INFO.  
 --- ARCVIEW

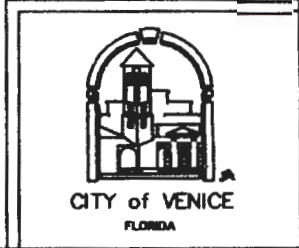

**PROPERTIES**

**ANNEXED TO THE  
 CITY OF  
 VENICE, FLORIDA**

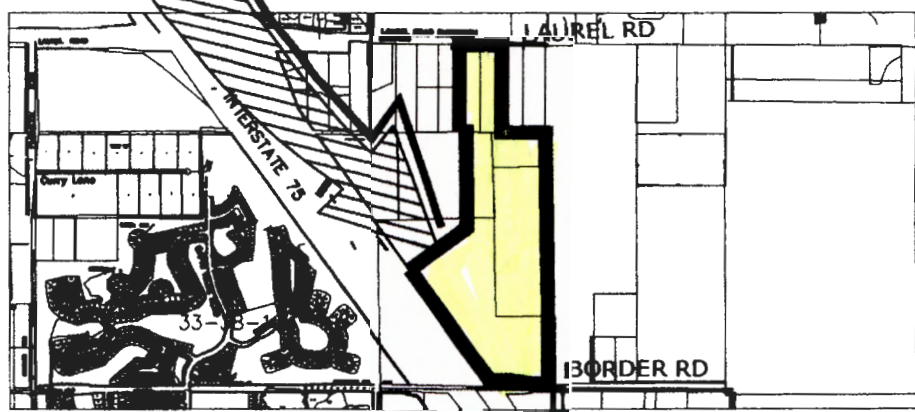

Owner: Gulf Coast Strategic Investments, LLC, a Florida not for profit corp.  
 Property Address: Laurel Road East, North Venice, Florida  
 Legal Description: Metes and Bounds  
 Mailing Address: 601 Tamiami Trail South, Venice, FL 34285  
 Ordinance No.: 2006-27  
 File No.: 05-8AN  
 County Zoning: OUR  
 Date of First Reading: 04/11/06  
 Date of Final Reading: 04/25/06  
 Date Mailed: 04/26/06  
 Parcel ID#: 0390-00-3040; 0389-00-2031; 0389-00-2006;  
 0389-00-2005; and 0389-00-2030